

BINN'S BRIDGE

TOTAL AREA = 1,063.64 m²

LEGEND:
 RED LINE BOUNDARY
 (NOTE: FOR PART 8 SUBMISSION)

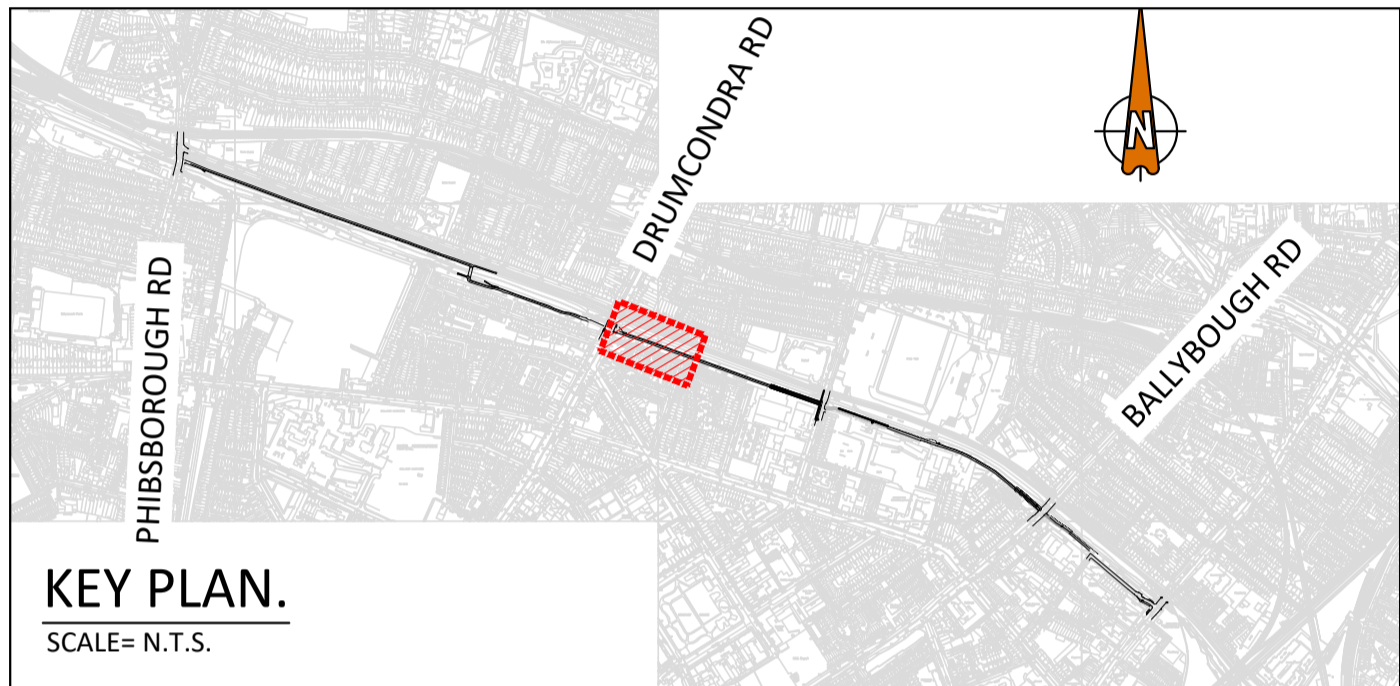
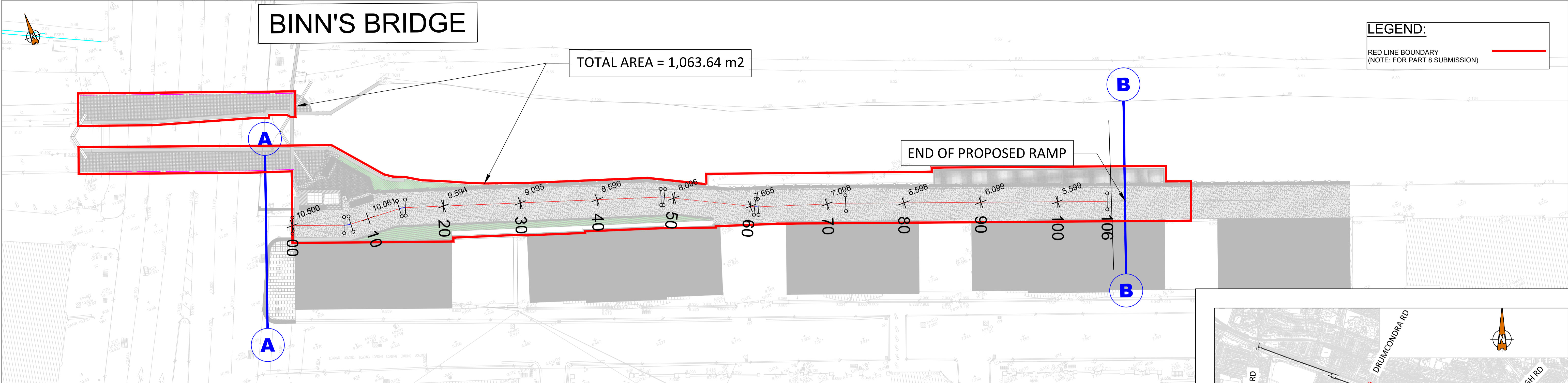

LEGEND:
 EXISTING LEVEL (dashed green line)
 PROPOSED LEVEL (solid red line)
 PROPOSED LEVEL (solid blue line)

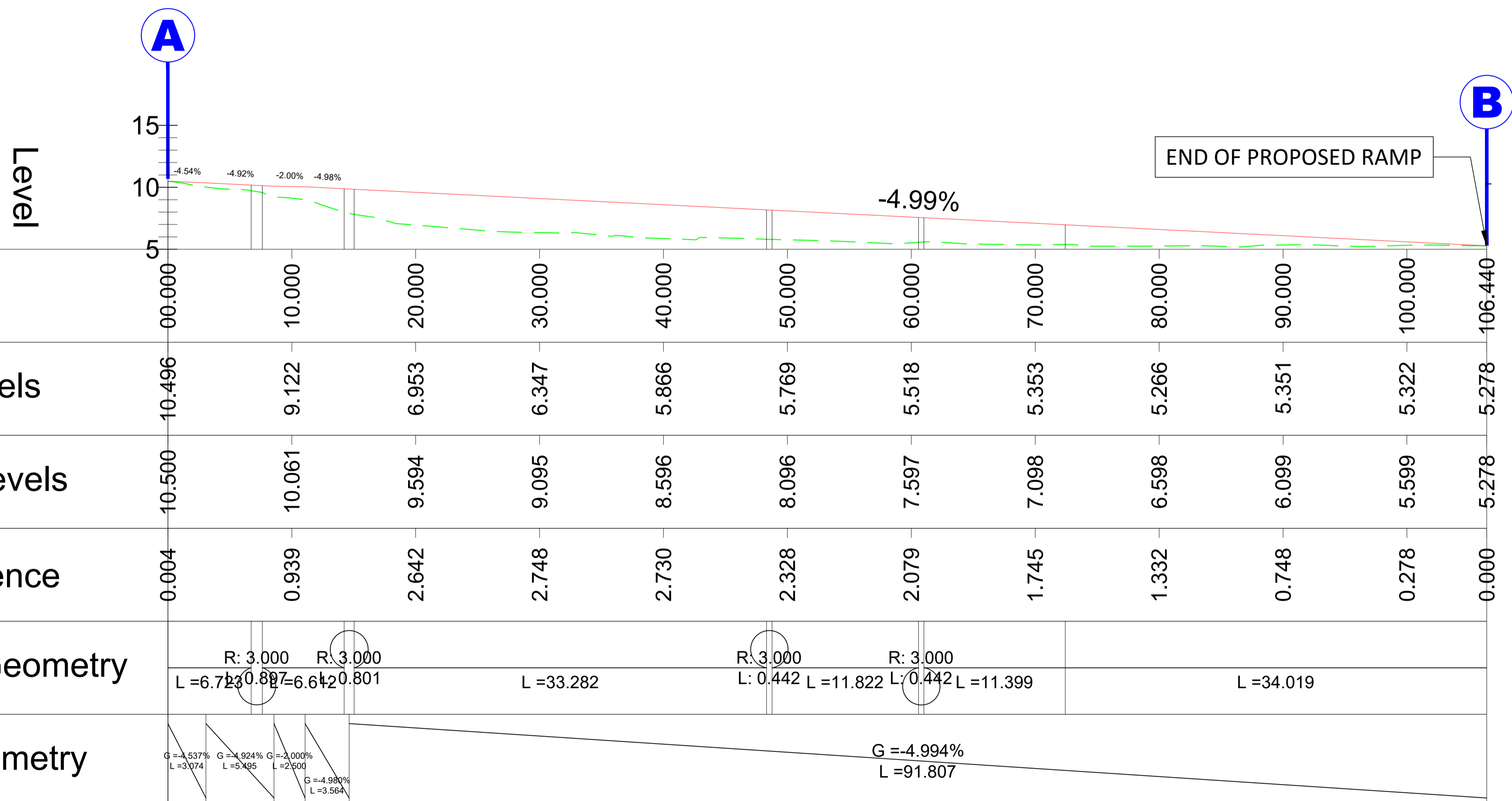

Chainage	Existing Levels	Proposed Levels	Level Difference	Horizontal Geometry	Vertical Geometry
00.000	10.496	10.500	0.004		G = -4.537% L = 3.074
10.000	9.122	10.061	0.939	R: 3,000 L: 6.723	G = -4.924% L = 5.495
20.000	6.953	9.594	2.642	R: 3,000 L: 6.612	G = -2.000% L = 2.600
30.000	6.347	9.095	2.748	L: 33.282	G = -4.980% L = 3.564
40.000	5.866	8.596	2.730		
50.000	5.769	8.096	2.328	R: 3,000 L: 0.442	
60.000	5.518	7.597	2.079	R: 3,000 L: 11.822	G = -4.994% L = 91.807
70.000	5.353	7.098	1.745	L: 0.442 L: 11.399	
80.000	5.266	6.598	1.332		
90.000	5.351	6.099	0.748	L: 34.019	
100.000	5.322	5.599	0.278		
106.440	5.278	5.278	0.000		

- NOTES**
- For setting out refer to Engineer's drawings.
 - This drawing to be read in conjunction with all other Engineering drawings and all other relevant drawings and Specifications.
 - DO NOT SCALE THIS DRAWING. Use figured dimensions only.
 - No part of this document may be reproduced or transmitted in any form or stored in any retrieval system of any nature without the written permission of O'Connor Sutton Cronin as copyright holder except as agreed for use on the project for which the document was originally issued.
 - Ordnance Survey of Ireland licence no. EN0000820 © Government of Ireland

Rev. No.	Date	REVISION NOTE	Drn. By	Chk. By
P01	17/02/2023	ISSUE FOR PART 8 SUBMISSION	JT	SJ
P02	17/04/23	AREA INFORMATION ADDED	JT	SJ
P03	20/04/23	LEVELS REVISED	JT	SJ
P04	23/06/23	SUITABLE FOR PART 8 PLANNING	RM	PR

INFORMATION ONLY
 THIS DRAWING HAS BEEN ISSUED FOR INFORMATION PURPOSES ONLY AND MUST NOT BE USED FOR CONSTRUCTION UNDER ANY CIRCUMSTANCES

OCSC
 Multidisciplinary Consulting Engineers
 O'Connor Sutton Cronin & Associates Ltd.
 9 Prussia St., Dublin 7.
 TEL +353 (0)1 8682000
 FAX +353 (0)1 8682100
 e: contactus@ocsc.ie
 w: www.ocsc.ie

Client: DUBLIN CITY COUNCIL
Project: ROYAL CANAL, GREENWAY, PHASE 3.
Title: PLAN AND PROFILE - BINNS BRIDGE

Drn by: JT
 Chk by: SJ
 Date: 17/02/2023

Scale: 1:250
 Appr by: AH
 @AT

Deg No: D542
 Revision: -SK100 P04

Office Locations | Dublin (Head Office) | London | Cork | Galway | Belfast | Warsaw | Bucharest | Moscow | Abu Dhabi | Libya |