

BOLLARDS TO BE POSITIONED ON THE FOOTWAY 0.45m FROM KERB EDGE WITH 1.5m MINIMUM FOOTWAY WIDTH REMAINING. BOLLARDS TO BE SPACED 2m UNLESS OTHERWISE DIMENSIONED

SCHOOL WARDEN CROSSING (M121) TO BE INTRODUCED. KERB TO BE LOCALLY REPROFILED TO ALLOW STEP FREE ACCESS TO WARDEN CROSSING. BUFF COLOUR BLISTER TACTILE PAVING TO BE PROVIDED ON EITHER SIDE OF CROSSING AS SHOWN. REFER TO FIGURES 17 AND 19 OF DCC CONSTRUCTION STANDARDS. EXISTING SIGN POSTS TO BE RELOCATED.

INDICATIVE ENTRANCE AND BOUNDARY WALL TO NEW HOUSING ESTATE SHOWN DASHED

EXISTING ENTRANCES TO REMAIN UNOBSTRUCTED

EXISTING PRIVATE ACCESSES TO REMAIN UNOBSTRUCTED

EXISTING BARRIER TO BE REPAIRED/REPLACED

PROPOSED SCHOOL AHEAD WARNING SIGN (W141) TO BE MOUNTED ONTO NEW SIGNPOST FACING SOUTH

LEGEND:

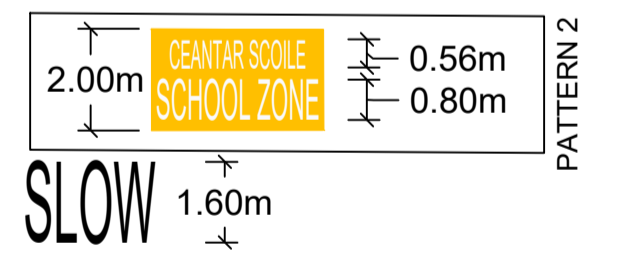
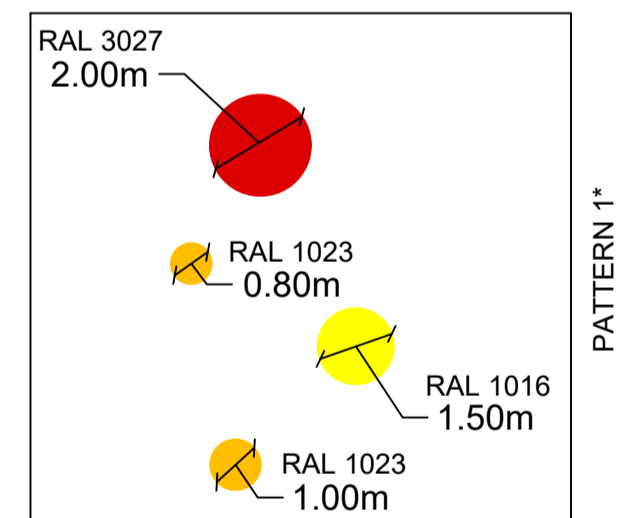

- POLE TO BE RELOCATED TO AVOID INTERFERING WITH CROSSING
- PROPOSED NEW POLE RELOCATION
- PROPOSED PENCIL-SHAPED BOLLARD - RAL 1023
- PROPOSED BUFF TACTILES
- ▨ PROPOSED SCHOOL WARDEN CROSSING
- EXISTING LIGHTING COLUMN

PENCIL-SHAPED BOLLARDS (RAL 1023) 73

* PATTERN 1: CIRCLES OF ALTERNATING COLOURS AND DIAMETERS. DISTANCE BETWEEN CIRCLES TO BE 2.0m OR GREATER.

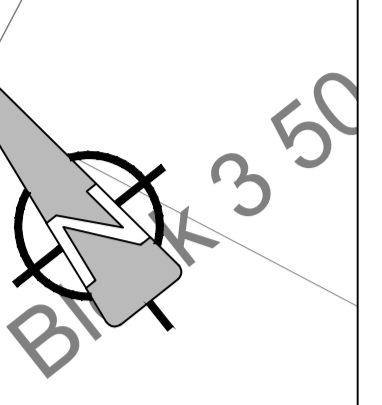
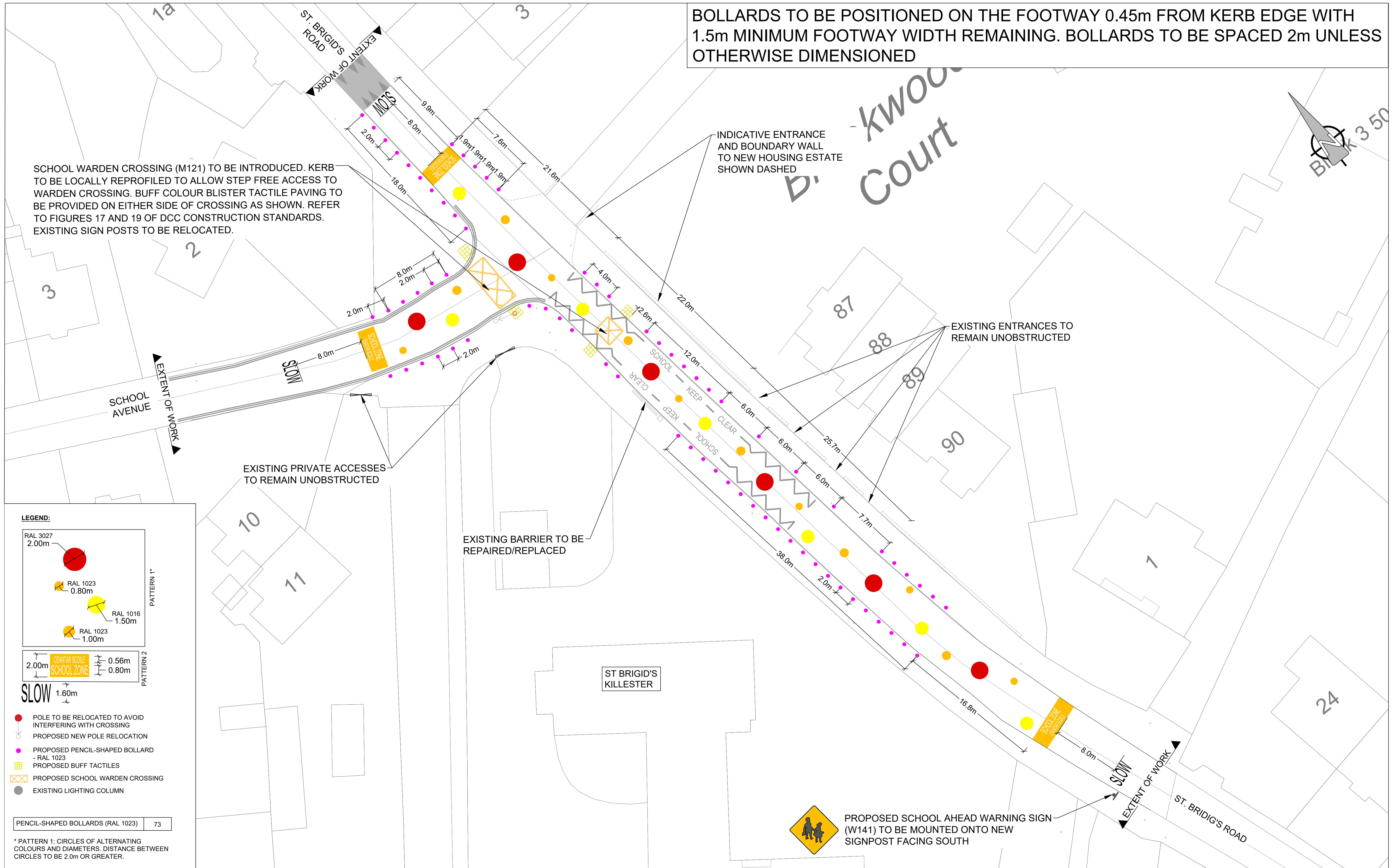

DUBLIN CITY COUNCIL
 Comhairle Chathair Bhaile Átha Cliath
 Environment & Transportation Dept.
 Civic Offices
 Wood Quay, Dublin 8

Brendan O'Brien
 Acting Executive Manager (Traffic)

- NOTES:**
- ALL EXISTING ROAD MARKINGS AND FEATURES SHOWN IN GREY ARE TO BE RETAINED, UNLESS OTHERWISE STATED.
 - DESIGN IS BASED ON AVAILABLE ORDINANCE SURVEY MAPPING. EXISTING FEATURES, SUCH AS BUILDOUTS, TRAFFIC ISLANDS, ROAD MARKINGS ETC., WERE ESTIMATED BY THE DESIGNERS BY USE OF AERIAL PHOTOGRAPHY DATA.
 - ALL ACCESSES TO BE KEPT UNOBSTRUCTED.
 - REVIEW OF EXISTING SERVICES LOCATION & DEPTH HAS NOT BEEN UNDERTAKEN.
 - CONTRACTOR TO REFER TO 'CONSTRUCTION STANDARDS FOR ROADS AND STREETS - DUBLIN CITY COUNCIL 2016'

Project Title					ORDNANCE SURVEY IRELAND LICENCE No. AR 0064224 © ORDNANCE SURVEY IRELAND / GOVERNMENT OF IRELAND				
DCC SCHOOL ZONES ST BRIGIDS GIRLS NS, KILLESTER					Drawing Title GENERAL ARRANGEMENT				
0	CONCEPT DESIGN	17/06/24	MOS	CF	CF	Designed: VK	CAD File:	Sheet	
No.	Revision	Date	By	Chk'd	App'd	Drawn: VK	Job No: DCC 210034-BRI	1 OF 1	
Stage			Date	Date	App'd	Checked: HMC	Scale: 1:200 @ A1	Drawing No:	
PRELIMINARY						Approved: JS	Date: 31/08/2021	DCC 210034-ACM-BRI-SK-0101	
APPROVAL								Rev: 0	
TENDER									
CONSTRUCTION									