

The drawing shows a two way protected cycle track varying in width from 2.5-3.8m on the eastside of Alfie Byrne Road with a physical kerb. A new island bus stop is provided on the existing 2 way cycle facility on the eastern side of Alfie Byrne Road, north-eastwards of the existing Toucan crossing. The two inbound lanes reduce to a single lane until the lane is beyond the island bus stop. A dedicated left turn lane is provided into Eastpoint Causeway. The corner at the junction of Alfie Byrne Road / Eastpoint Causeway has been builtout. The pedestrian access to the island bus stop platform is shown at the same level as the cycle track with a controlled crossing for pedestrians. Red L-shaped tactile is provided at the crossing point.

L:\Legacy\hcb\p00\NUI\Files\PR-426780_Cycling_Design_Office\900_CAD_GIS\IDCC_COVID19\911_1_WIP\DR\IDCC\0615775-NTA-SLV_ZZ-S043_XX_00-DR-CR-0001.dwg

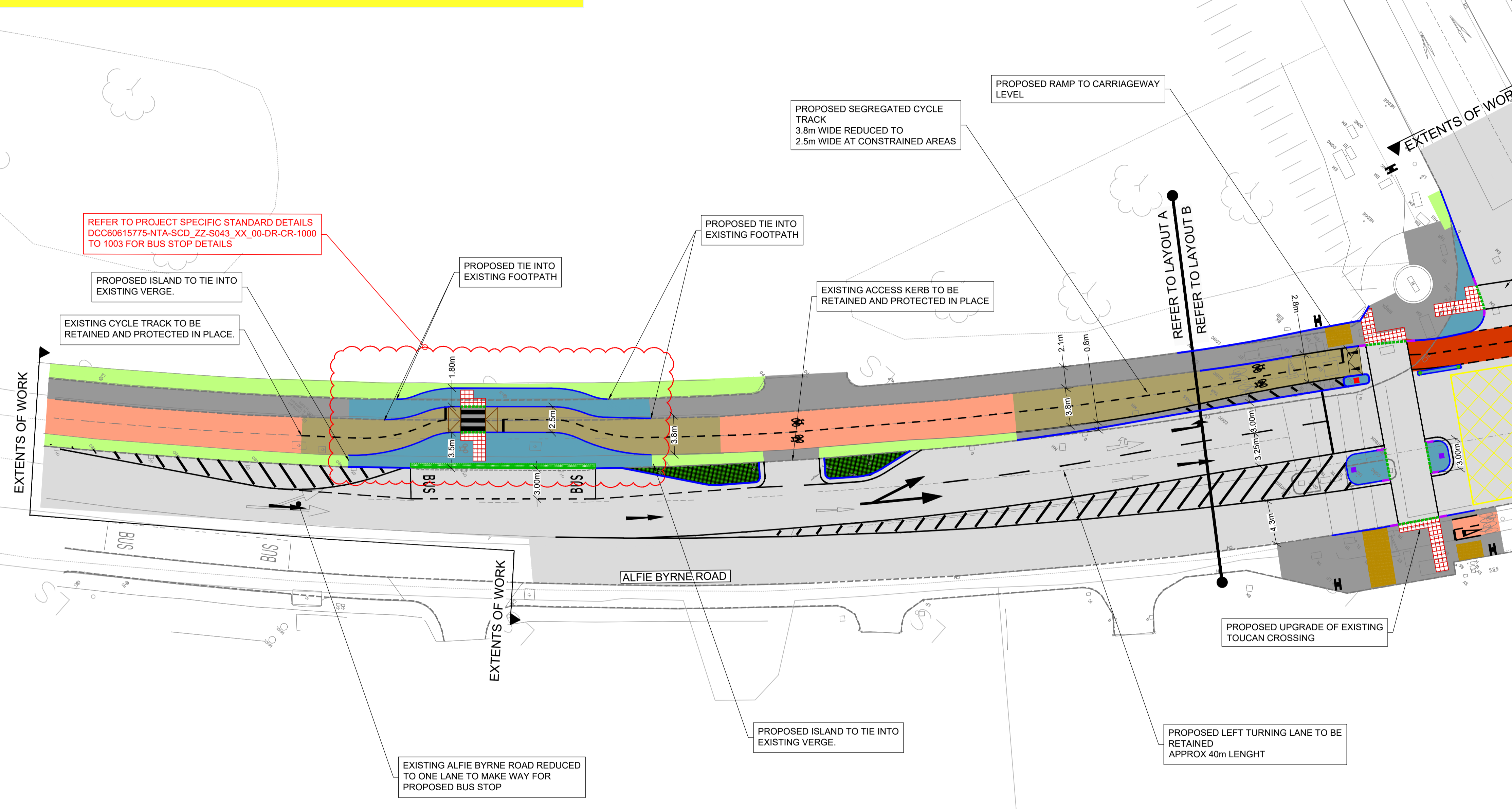

- ORDNANCE SURVEY IRELAND LICENCE NO CYAL50217544
© ORDNANCE SURVEY IRELAND / GOVERNMENT OF IRELAND
- NOTES:
- THIS DRAWING IS TO BE READ IN CONJUNCTION WITH ALL OTHER RELEVANT ENGINEERING DRAWINGS. ANY DISCREPANCIES, ERRORS OR OMISSIONS TO BE BROUGHT TO THE ATTENTION OF THE EMPLOYER.
 - EMPLOYERS REP TO BE INFORMED BY THE CONTRACTOR OF ANY DISCREPANCIES PRIOR TO THE COMMENCEMENT OF WORKS ON SITE.
 - ALL BOUNDARIES AND ADJOINING ROADS TO BE CHECKED ON SITE PRIOR TO COMMENCEMENT OF WORKS.
 - DO NOT SCALE FROM THIS DRAWING.
 - DESIGNS SUBJECT TO ARBORICULTURAL ASSESSMENTS
 - UPDATED SIGNAL STAGING TO BE AGREED WITH DUBLIN CITY COUNCIL.
 - ALL PROPOSED WORKS TO COMPLY WITH CONSTRUCTION STANDARDS FOR ROAD AND STREET WORKS IN DUBLIN CITY COUNCIL.
 - CONTRACTOR TO DEVELOP THEIR TRAFFIC MANAGEMENT PLAN FOR THE WORKS IN AGREEMENT WITH THE REQUIREMENTS OF DUBLIN CITY COUNCIL. THE TRAFFIC MANAGEMENT PLAN IS TO MAINTAIN EXISTING BUS ALIGNMENTS, EXISTING STOPS ALONG THE SCHEME SHOULD BE RETAINED, AND TEMPORARY STOPS BE PROVIDED WHERE THIS IS NOT POSSIBLE. THE CONTRACTOR IS TO PROVIDE A MINIMUM OF 3 WEEKS' NOTICE TO DUBLIN BUS BEFORE ANY STOPS ARE IMPACTED ALONG THE SCHEME.
 - WHERE REFERENCE TO NRA HAS BEEN MADE, THE CONTRACTOR IS TO REFER TO THE TR SPECIFICATION FOR ROAD WORKS SERIES AND THE CONSTRUCTION STANDARDS FOR ROAD AND STREET WORKS IN DUBLIN CITY COUNCIL. PRIOR TO ANY WORKS THE CONTRACTOR MUST AGREE THE DETAIL PROPOSED WITH THE CLIENT, DUBLIN CITY COUNCIL.

- LEGEND:
- EXISTING CARRIAGEWAY EDGE KERB
 - PROPOSED CARRIAGEWAY EDGE KERB
 - PROPOSED BUS STOP KERB
 - PROPOSED VEHICULAR ACCESS KERB
 - PROPOSED CYCLE LANE SEGREGATION KERB
 - PROPOSED DROPPED TRANSITION KERB
 - EXISTING CARRIAGEWAY
 - PROPOSED FOOTWAY, FOOTWAY BUILD OUTS AND TRAFFIC ISLANDS
 - EXISTING CYCLE FACILITY
 - PROPOSED CYCLE FACILITY
 - PROPOSED RED EPOXY SURFACING AT CONFLICT POINTS AGGREGATE COLOUR (RED (BUFF) TO BE CONFIRMED WITH DCC
 - PROPOSED RAISED TABLE
 - EXISTING FOOTPATH
 - PROPOSED VERGE
 - PROPOSED TACTILE PAVING AS DESIGNED AND SPECIFIED BY DCC
 - EXISTING TACTILE PAVING
 - PROPOSED CORDUROY TACTILE PAVING AS DESIGNED AND SPECIFIED BY DCC
 - PROPOSED CYCLE RAMP
 - PROPOSED FLEXIBLE TRAFFIC BOLLARD WITH "KEEP RIGHT" (RUS 002) SIGN FACE
 - PROPOSED ILLUMINATED TRAFFIC BOLLARD WITH "KEEP LEFT" (RUS 001) SIGN FACE
 - PROPOSED FLEXIBLE KEEP RIGHT BOLLARD CYCLIST (TYPE A)
 - PROPOSED FLEXIBLE DELINEATION BOLLARD (TYPE B)
 - PROPOSED FLEXIBLE PENCIL BOLLARD (TYPE C)

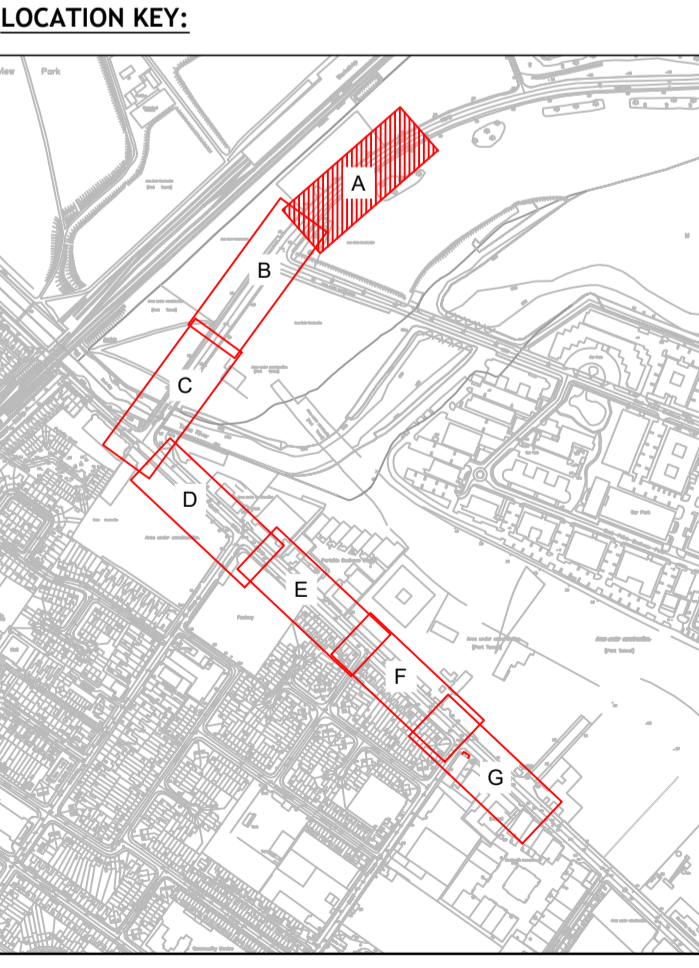

WORK IN PROGRESS

AVAILABLE UTILITY INFORMATION SUGGESTS THE PRESENCE OF FIBER OPTIC CABLES, HIGH VOLTAGE CABLES, GAS MAINS AND OTHER UTILITY SERVICES AT ALL SECTIONS AND WORKS AREAS.

Disclaimer:
a. © National Transport Authority (NTA) 2022. This drawing is confidential and the copyright in it is owned by NTA. This drawing must not be either loaned, copied or otherwise reproduced in whole or in part or used for any purpose without the prior permission of NTA.
b. This drawing is to be used for the design element identified in the titlebox. Other information shown is to be considered indicative only. The drawing is to be read in conjunction with all other relevant design drawings.
c. O.S. data used for plans are printed under © Ordnance Survey Ireland Government of Ireland. All rights reserved. Licence Number EN 002119 National Transport Authority. All elevations are in metres and relate to OSI Geoid Model (OSGM15) Mean Head. All Co-ordinates are in Irish Transverse Mercator Grid (ITM) as defined by OSI active local GPS station.
d. Information concerning the position of apparatus shown on this drawing is based on drawings supplied by the utility owners and/or the utility works contractor, whilst every care has been taken in the preparation of this drawing, positions should be taken as approximate and are intended for general guidance only and no representation is made by the NTA as to the accuracy, completeness, sufficiency or otherwise of this drawing and the position of the apparatus. The information contained herein does not purport to be comprehensive or final as the apparatus is subject to being altered and/or superceded. Recipients should not rely on this information. Any liabilities are hereby expressly disclaimed.
e. The information contained herein has been provided by the NTA but does not purport to be comprehensive or final. Recipients should not rely on the information. Neither the NTA nor any of its directors, officers, employees, agents, stakeholders or advisers make any representation or warranty as to, or accept any liability or responsibility in relation to, the adequacy, accuracy, reasonableness or completeness of the information provided as part of this document or any matter on which the information is based (including but not limited to loss or damage arising as a result of reliance by recipients on the information or any part of it). Any liabilities are hereby expressly disclaimed.

Project Ireland 2040
Building Ireland's Future

Rev	Date	Dm	Chk'd	App'd	Description
P01	10.11.2022	RH	SD	MD	WORK IN PROGRESS

Client		Engineering Designer			Project Title	
NTA Údarás Náisiúnta Iompair National Transport Authority		CYCLING DESIGN OFFICE			EAST WALL ROAD AND ALFIE BYRNE ROAD CYCLE FACILITY	
Date	Scale	Drawn	Checked	Approved	Drawing Title	
10.11.2022	1:250@A1 1:500@A3	RH	SD	MD	GENERAL ARRANGEMENT	
Project Code	Originator Code	QMS Code	Status		Rev	
60615775	NTA	S043	B2		P01	

Drawing File Name	Sheet Number	Status	Rev
DCC60615775-NTA-SLV_ZZ-S043_XX_00-DR-CR-0001	1 OF 4	B2	P01