

The drawing shows a new 2.5m wide two way protected cycle track on the north side of East Wall Road protected by a kerb. Red coloured surfacing is provided at conflict points at entrances.

The provision of a new island bus stop on the northern side of East Wall Road to the east of Church Road. The pedestrian access to the island bus stop platform is shown at the same level as the existing footpath with priority for pedestrians. Rumble strips are provided in the cycle lanes on the approach to the crossing point, in addition to cycle yield road markings.

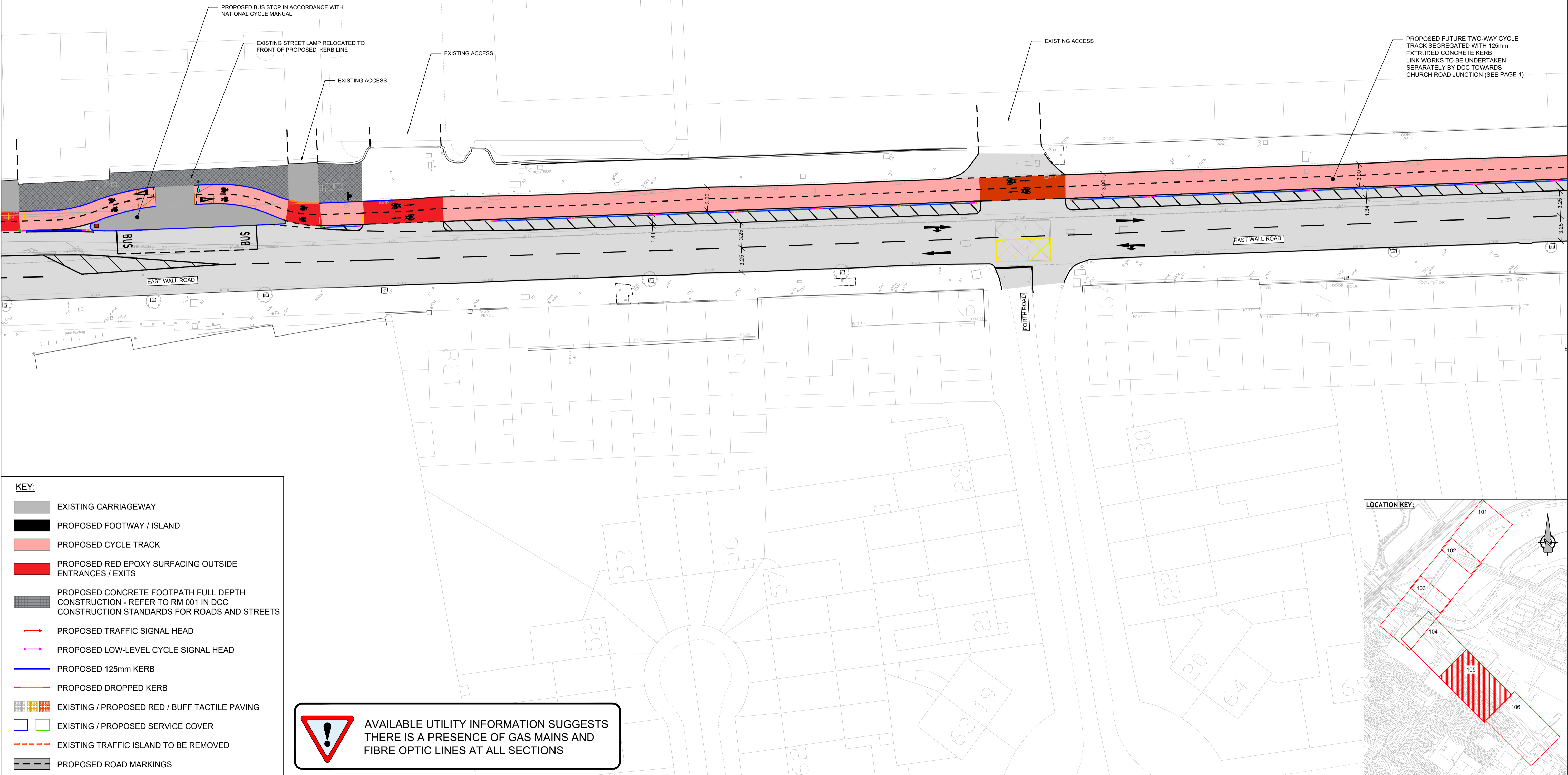
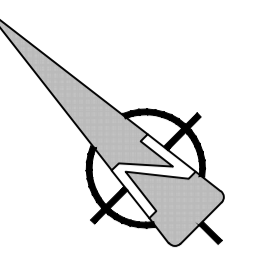

- KEY:**
- EXISTING CARRIAGEWAY
 - PROPOSED FOOTWAY / ISLAND
 - PROPOSED CYCLE TRACK
 - PROPOSED RED EPOXY SURFACING OUTSIDE ENTRANCES / EXITS
 - PROPOSED CONCRETE FOOTPATH FULL DEPTH CONSTRUCTION - REFER TO RM 001 IN DCC CONSTRUCTION STANDARDS FOR ROADS AND STREETS
 - PROPOSED TRAFFIC SIGNAL HEAD
 - PROPOSED LOW-LEVEL CYCLE SIGNAL HEAD
 - PROPOSED 125mm KERB
 - PROPOSED DROPPED KERB
 - EXISTING / PROPOSED RED / BUFF TACTILE PAVING
 - EXISTING / PROPOSED SERVICE COVER
 - EXISTING TRAFFIC ISLAND TO BE REMOVED
 - PROPOSED ROAD MARKINGS

AVAILABLE UTILITY INFORMATION SUGGESTS THERE IS A PRESENCE OF GAS MAINS AND FIBRE OPTIC LINES AT ALL SECTIONS

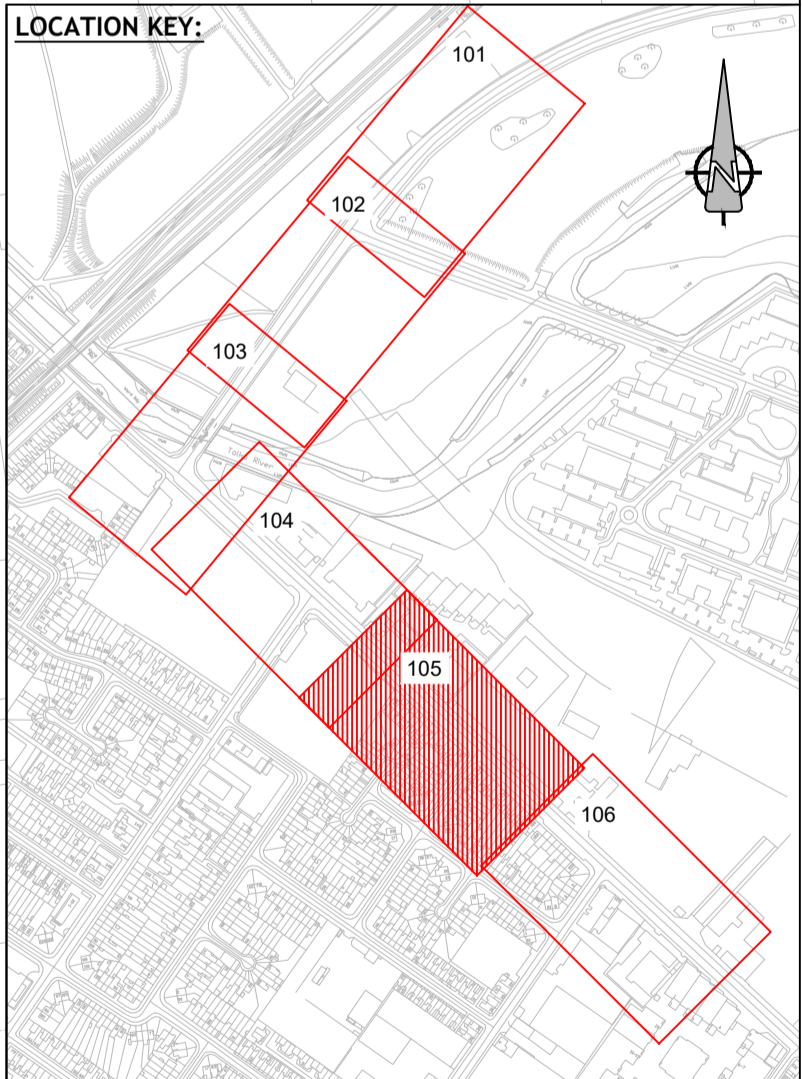

A GENERAL ARRANGEMENT

0104 Scale: 1:250 @ A1



DUBLIN CITY COUNCIL

Comhairle Chathair Bhaile Átha Cliath
 Environment & Transportation Dept.
 Civic Offices
 Wood Quay, Dublin 8

Brendan O'Brien
 Acting Executive Manager (Traffic)

NOTES
 1. © Ordnance Survey Ireland. All rights reserved.
 Licence Number 2011/22/CCMA/
 Dublin City Council.

WORK IN PROGRESS

S
H
A
D
E

I
N
D
E
X

- NOTES
1. DO NOT SCALE, ALL MEASUREMENTS & CO-ORDINATES TO BE CHECKED ON SITE.
 2. ALL DRAWINGS TO BE CHECKED BY THE CONTRACTOR ON SITE.
 3. THE LOCATION & DEPTH OF SERVICES TO BE CHECKED ON SITE PRIOR TO COMMENCEMENT OF WORKS
 4. ALL BOUNDARIES AND ADJOINING ROADS TO BE CHECKED ON SITE PRIOR TO CONSTRUCTION.
 5. ENGINEER TO BE INFORMED BY THE CONTRACTOR OF ANY DISCREPANCIES BEFORE ANY WORK COMMENCES.
 6. CONTRACTOR TO REFER TO DCC, CONSTRUCTION STANDARDS FOR ROADS AND STREET WORKS IN DUBLIN CITY COUNCIL.

No.	Revision	Date	By	Chk'd	App'd
3	ISSUED FOR INFORMATION FOLLOWING JUNCTION AMENDMENTS	15/12/2021	RH	SD	MD
2	ISSUED FOR INFORMATION FOLLOWING JUNCTION AMENDMENTS	15/12/2021	RH	SD	MD
1	ISSUED FOR INFORMATION	09/12/2021	RH	SD	MD
0	ISSUED FOR ROAD SAFETY AUDIT	28/09/2021	RH	HMC	PL
Stage		Date	App'd		
PRELIMINARY					
APPROVAL					
TENDER					
CONSTRUCTION					

Project Title EAST WALL ROAD - INTERIM 2 WAY CYCLE LANES		
Drawing Title GENERAL ARRANGEMENT EAST WALL ROAD SHEET 5 OF 6	Designed: RH	CAD File:
Drawn: RH	Job No: 60615775-EWR	Sheet 5 OF 6
Checked: SD	Scale: 1:250 @ A1	Drawing No:
Approved: MD	Date: 23/02/2022	60615775-ACM-EWR-SHT-DR-0105
		Rev: 3