

The drawing shows a new 2.5m wide two way protected cycle track on the eastside of Alfie Byrne Road protected by a kerb and continuing along the north side of East Wall Road. Currently there are 2 inbound traffic lanes which are reduced to a single traffic lane.

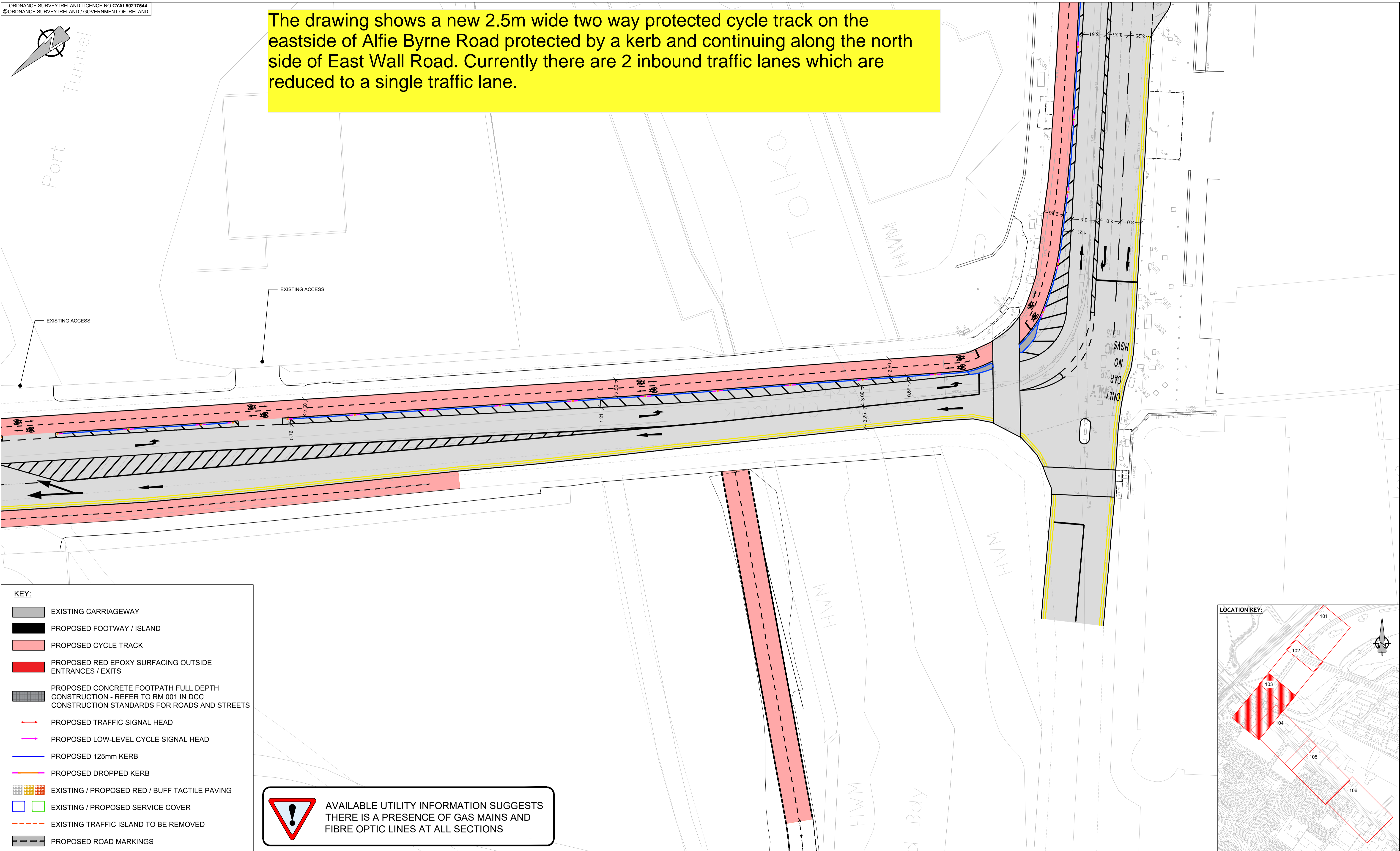

AVAILABLE UTILITY INFORMATION SUGGESTS THERE IS A PRESENCE OF GAS MAINS AND FIBRE OPTIC LINES AT ALL SECTIONS

- KEY:**
- EXISTING CARRIAGEWAY
 - PROPOSED FOOTWAY / ISLAND
 - PROPOSED CYCLE TRACK
 - PROPOSED RED EPOXY SURFACING OUTSIDE ENTRANCES / EXITS
 - PROPOSED CONCRETE FOOTPATH FULL DEPTH CONSTRUCTION - REFER TO RM 001 IN DCC CONSTRUCTION STANDARDS FOR ROADS AND STREETS
 - PROPOSED TRAFFIC SIGNAL HEAD
 - PROPOSED LOW-LEVEL CYCLE SIGNAL HEAD
 - PROPOSED 125mm KERB
 - PROPOSED DROPPED KERB
 - EXISTING / PROPOSED RED / BUFF TACTILE PAVING
 - EXISTING / PROPOSED SERVICE COVER
 - EXISTING TRAFFIC ISLAND TO BE REMOVED
 - PROPOSED ROAD MARKINGS

A GENERAL ARRANGEMENT
 0102 Scale: 1:250 @ A1

 Comhairle Cathrach Bhaile Átha Cliath Dublin City Council	DUBLIN CITY COUNCIL Comhairle Chathair Bhaile Átha Cliath Environment & Transportation Dept. Civic Offices Wood Quay, Dublin 8	NOTES 1. © Ordnance Survey Ireland. All rights reserved. Licence Number 2011/22/CCMA/ Dublin City Council.	<div style="border: 2px solid red; padding: 5px; color: red; font-weight: bold; font-size: 1.2em;"> WORK IN PROGRESS </div>	NOTES 1. DO NOT SCALE, ALL MEASUREMENTS & CO-ORDINATES TO BE CHECKED ON SITE. 2. ALL DRAWINGS TO BE CHECKED BY THE CONTRACTOR ON SITE. 3. THE LOCATION & DEPTH OF SERVICES TO BE CHECKED ON SITE PRIOR TO COMMENCEMENT OF WORKS 4. ALL BOUNDARIES AND ADJOINING ROADS TO BE CHECKED ON SITE PRIOR TO CONSTRUCTION. 5. ENGINEER TO BE INFORMED BY THE CONTRACTOR OF ANY DISCREPANCIES BEFORE ANY WORK COMMENCES. 6. CONTRACTOR TO REFER TO DCC, CONSTRUCTION STANDARDS FOR ROADS AND STREET WORKS IN DUBLIN CITY COUNCIL.	<table border="1" style="width: 100%; border-collapse: collapse; font-size: 0.8em;"> <tr> <td style="width: 5%;">No.</td> <td style="width: 45%;">Revision</td> <td style="width: 10%;">Date</td> <td style="width: 10%;">By</td> <td style="width: 10%;">Chk'd</td> <td style="width: 10%;">App'd</td> </tr> <tr> <td>2</td> <td>ISSUED FOR INFORMATION FOLLOWING JUNCTION AMENDMENTS</td> <td>23/02/2022</td> <td>RH</td> <td>SD</td> <td>MD</td> </tr> <tr> <td>1</td> <td>ISSUED FOR INFORMATION FOLLOWING JUNCTION AMENDMENTS</td> <td>15/12/2021</td> <td>RH</td> <td>SD</td> <td>MD</td> </tr> <tr> <td>0</td> <td>ISSUED FOR ROAD SAFETY AUDIT</td> <td>28/09/2021</td> <td>RH</td> <td>HMC</td> <td>PL</td> </tr> </table>	No.	Revision	Date	By	Chk'd	App'd	2	ISSUED FOR INFORMATION FOLLOWING JUNCTION AMENDMENTS	23/02/2022	RH	SD	MD	1	ISSUED FOR INFORMATION FOLLOWING JUNCTION AMENDMENTS	15/12/2021	RH	SD	MD	0	ISSUED FOR ROAD SAFETY AUDIT	28/09/2021	RH	HMC	PL	Project Title EAST WALL ROAD - INTERIM 2 WAY CYCLE LANES Drawing Title GENERAL ARRANGEMENT EAST WALL ROAD SHEET 3 OF 6 Designed: RH Drawn: RH Checked: SD Approved: MD CAD File: Job No: 60615775-EWR Scale: 1:250 @ A1 Date: 23/02/2022 Sheet 3 OF 6 Drawing No: 60615775-ACM-EWR-SHT-DR-0103 Rev: 2
No.	Revision	Date	By	Chk'd	App'd																									
2	ISSUED FOR INFORMATION FOLLOWING JUNCTION AMENDMENTS	23/02/2022	RH	SD	MD																									
1	ISSUED FOR INFORMATION FOLLOWING JUNCTION AMENDMENTS	15/12/2021	RH	SD	MD																									
0	ISSUED FOR ROAD SAFETY AUDIT	28/09/2021	RH	HMC	PL																									
 Údarás Náisiúnta Iompair National Transport Authority	Brendan O'Brien Acting Executive Manager (Traffic)																													