

- NOTES / LEGEND:**
- FOR SITE LOCATION PLAN, SEE DRG. NO.RD-3429-RP-01_A
 - FOR ELEVATION OF PROPOSED BOUNDARY WALL, SEE DRG. NO. RD-3429-RP-003_A
 - PROPOSED KERB LINE INDICATED THUS:
 - PROPOSED 2m WIDE FOOTPATH INDICATED THUS:
 - PROPOSED BOUNDARY WALL INDICATED THUS:
 - EXISTING ESB MINI-PILLAR INDICATED THUS:
 - SITE EXTENTS BOUNDARY INDICATED THUS:

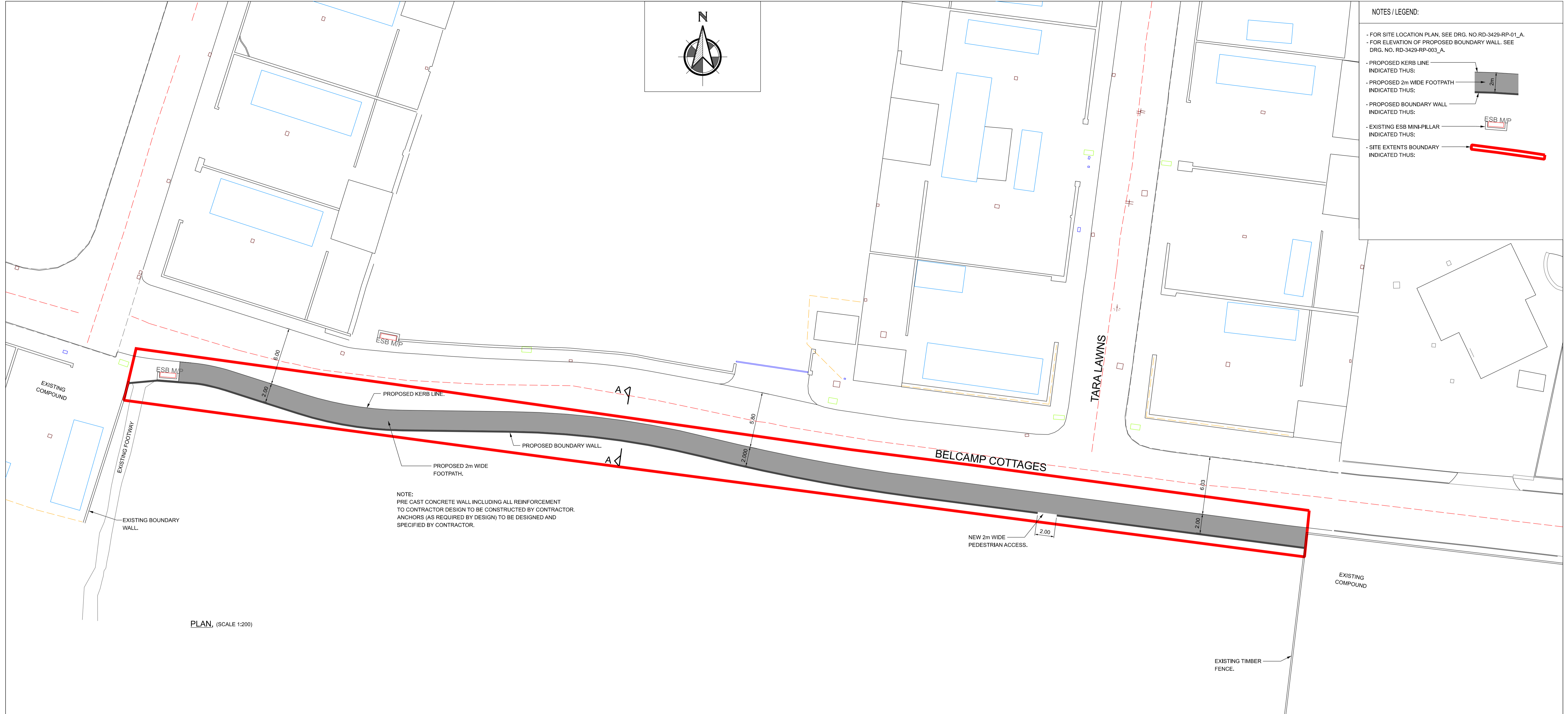

NOTE:
PRE CAST CONCRETE WALL INCLUDING ALL REINFORCEMENT TO CONTRACTOR DESIGN TO BE CONSTRUCTED BY CONTRACTOR. ANCHORS (AS REQUIRED BY DESIGN) TO BE DESIGNED AND SPECIFIED BY CONTRACTOR.

PLAN, (SCALE 1:200)

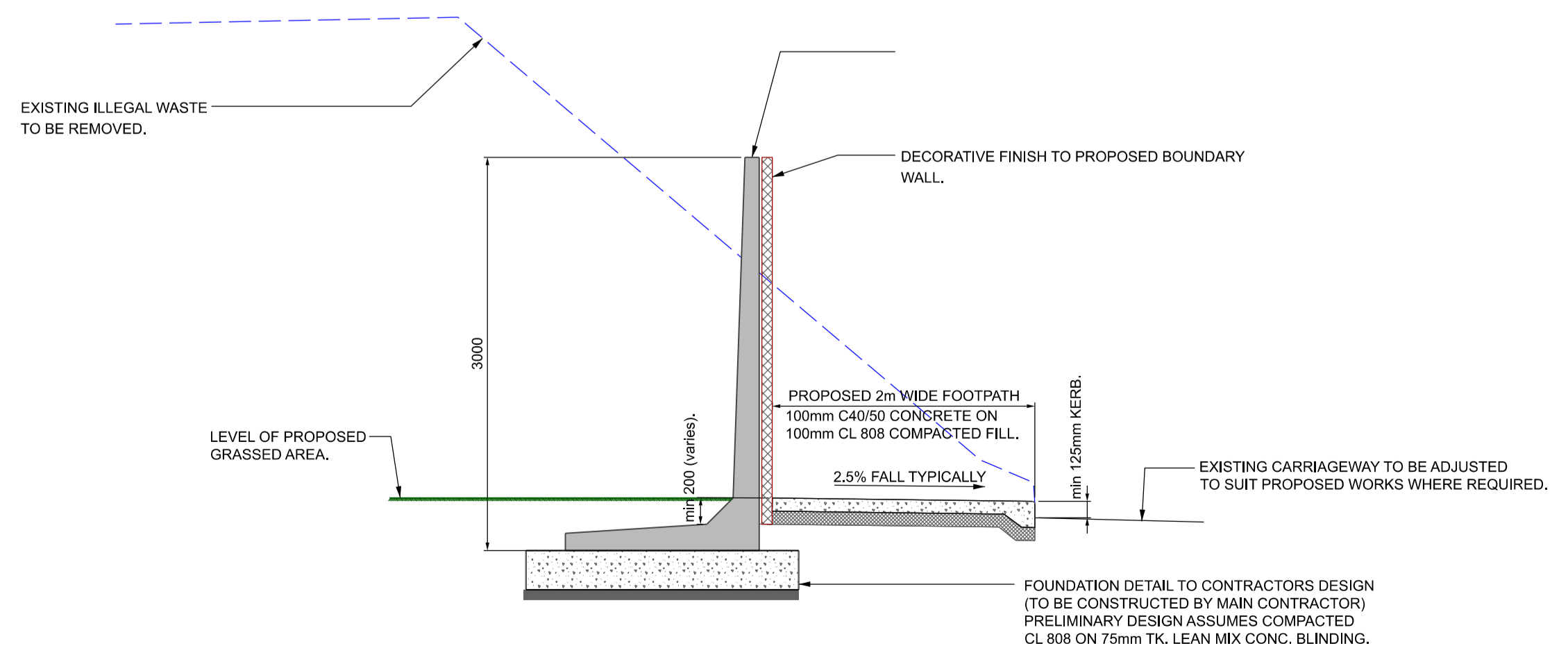

TYPICAL SECTION A - A THRO' PROPOSED BOUNDARY WALL, CHAINAGE 70.0m (approx.) (SCALE 1:20)

©Ordnance Survey Ireland. All rights reserved.
License number 2022/23/CCMA/DublinCityCouncil

PART 8 PLANNING

Comhairle Cathrach Bhaile Átha Cliath
Dublin City Council

ROINN COMHSHAOIL AGUS IOMPAIR
RANNAN DEARADH BÓITHRE
Oifigi na Cathrach, An Ché Adhmaid, Baile Átha Cliath, D08 RF3F

ENVIRONMENT AND TRANSPORTATION DEPARTMENT
ROAD DESIGN DIVISION
Civic Offices, Wood Quay, Dublin, D08 RF3F

Dr. John W. Flanagan, C.Eng. F.I.E. F.I.C.E.
Assistant Chief Executive and City Engineer

Project:
PROPOSED BELCAMP BOUNDARY WALL

Title:
PROPOSED BOUNDARY WALL - LAYOUT PLAN

Datum:
Malin Hd.

Scales:
As Indicated

Dm.	Chd.	App.	Date:
PC	MG	JK	02.06.23

Drawing No.
RD-3429-RP-002_A

Date:	Rev.	Description

Original Drawing Size: 594 x 841 - A1