

- GENERAL NOTES:**
- All dimensions are in millimeters. All vertical levels in metres and referenced to MSL datum unless noted otherwise.
  - All Architecture drawings to be read in conjunction with all relevant specifications, Structural Engineer's drawings, Services Engineer's and other Specialist's drawings. Any discrepancies between graphic and written information must be immediately reported to the Architect in writing.

**GENERAL LEGEND:**

— Proposed Site Application Boundary (c. 2.39hA)

This drawing incorporates information from the topographic surveys undertaken by APEX Surveys on 19/03/2021, 22/03/2021, 25/03/2021, 30/03/2021, 31/03/2021, and 02/04/2021. Drawing Number: 4685. GRID SYSTEM: Irish Transverse Mercator DATUM: Malin Head (USGM15)

- KEY TO ROOF TYPES:**
- Steel deck roof
  - Translucent Polycarbon panels
  - Metal mesh screen
  - Green roof
  - Flat roof laid to falls

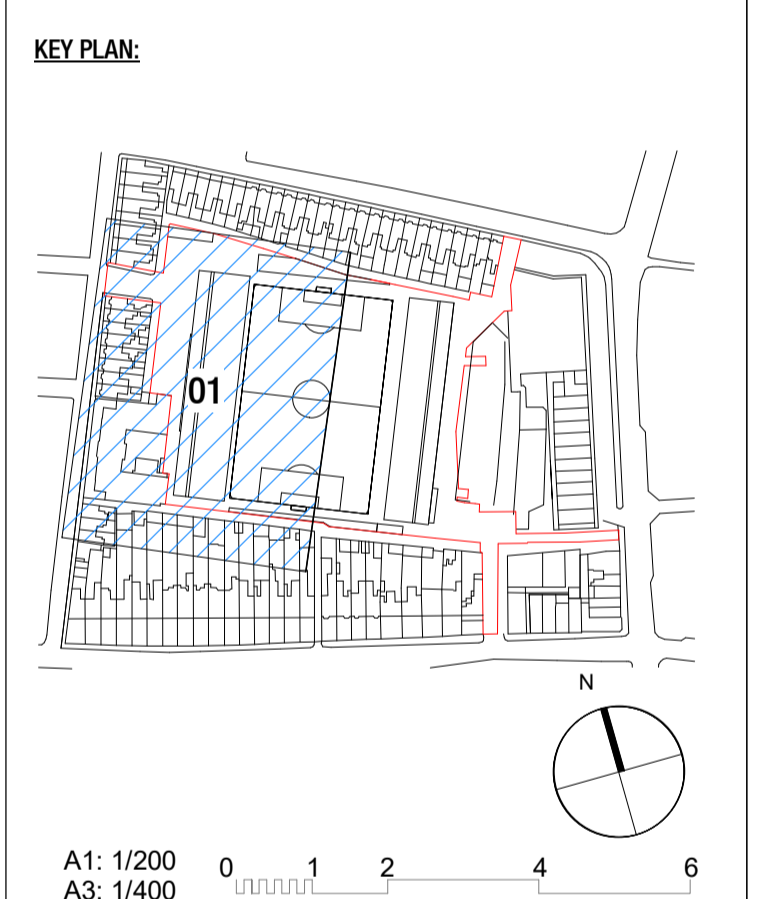

04	01/09/2023	FOR PLANNING	AA	VB	VB
Ver	Date	Issue Details	Dwn	Chd	App



**Project**

Dalymount Park  
Stadium Redevelopment

**Dwg Title**

Proposed GA - Lower Roofs West Stand

Scale	Date	Client Project No.	Orig. Project No.
A1 1:200 A3 1:400	01/09/2023	-	P - 102025
Drawn	Checked	Approved	
AA	VB	VB	

**Architects & Engineers**

**IDOM** GILROYMCMAHON ARCHITECTS