

1 North Terrace
Scale 1:200

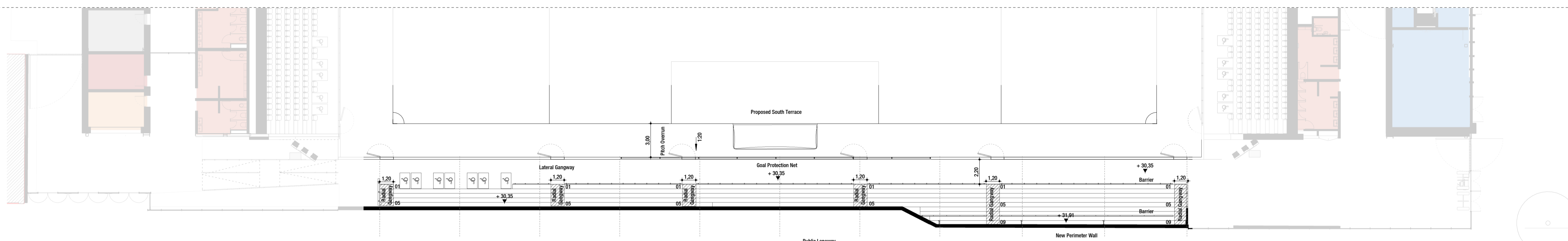

2 South Terrace
Scale 1:200

- GENERAL NOTES:**
- All dimensions are in millimeters. All vertical levels in metres and referenced to MSL datum unless noted otherwise.
 - All Architecture drawings to be read in conjunction with all relevant specifications, Structural Engineer's drawings, Services Engineer's and other Specialist's drawings.
 - Any discrepancies between graphic and written information must be immediately reported to the Architect in writing.

GENERAL LEGEND:

— Proposed Site Application Boundary (c. 2.39hA)

This drawing incorporates information from the topographic surveys undertaken by APEX Surveys on 19/03/2021, 22/03/2021, 25/03/2021, 30/03/2021, 31/03/2021, and 02/04/2021. Drawing Number: 4685. GRID SYSTEM: Irish Transverse Mercator DATUM: Malin Head (OSGM15)

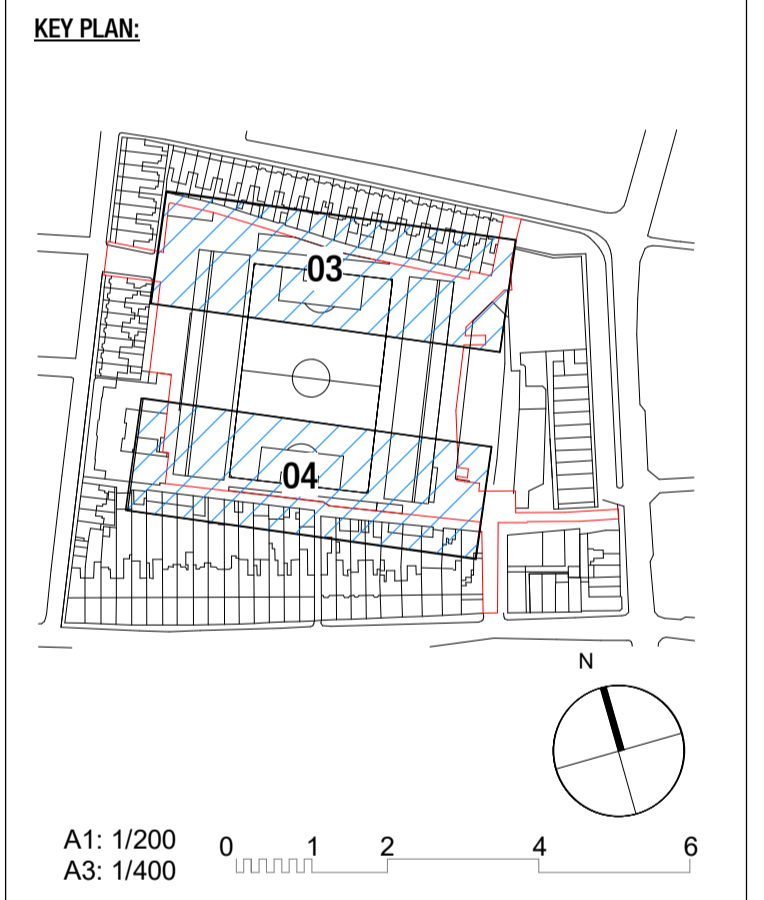

03	01/09/2023	FOR PLANNING	AA	VB	AA
Ver	Date	Issue Details	Dwn	Chd	App
Client					
 Comhairle Cathrach Bhaile Átha Cliath Dublin City Council					

Project

**Dalymount Park
Stadium Redevelopment**

Dwg Title

**Proposed GA Plans - Ground Floor - North
and South Terrace**

Scale	Date	Client Project No.	Origin Project No.
A1 1:200	01/09/2023	-	P - 102025
A3 1:400	Drawn	Checked	Approved
	AA	VB	VB
Drawing No.	102025-IDO-DR-A-2102-00-03		Status Revision
			S4 03

Architects & Engineers

IDOM **GILROYMCMAHON**
ARCHITECTS