

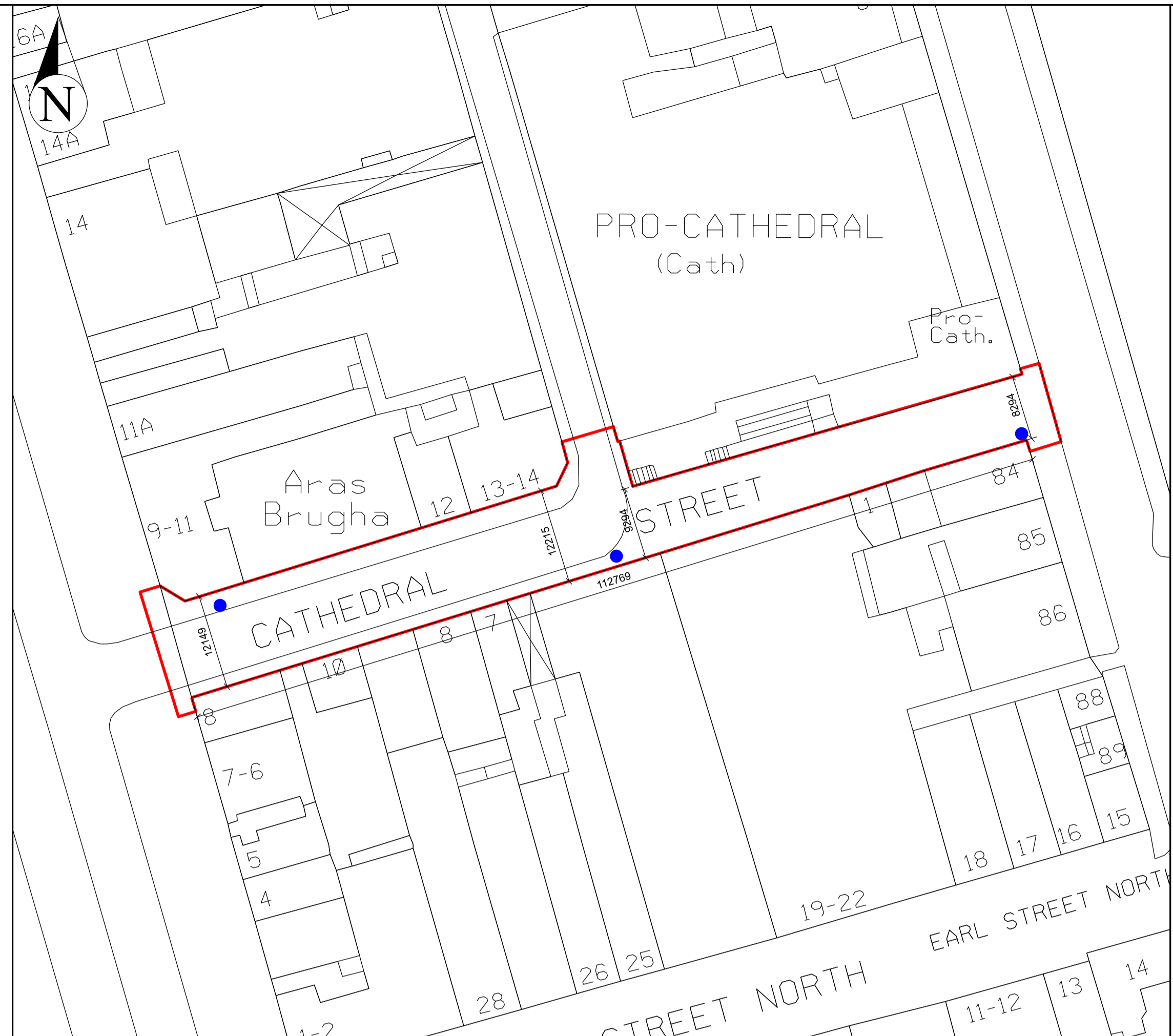

**Site Location**  
 Scale 1:1000  
 Copyright © Ordnance Survey Ireland. Licence number 2017/22/CCMA/ Dublin City Council.

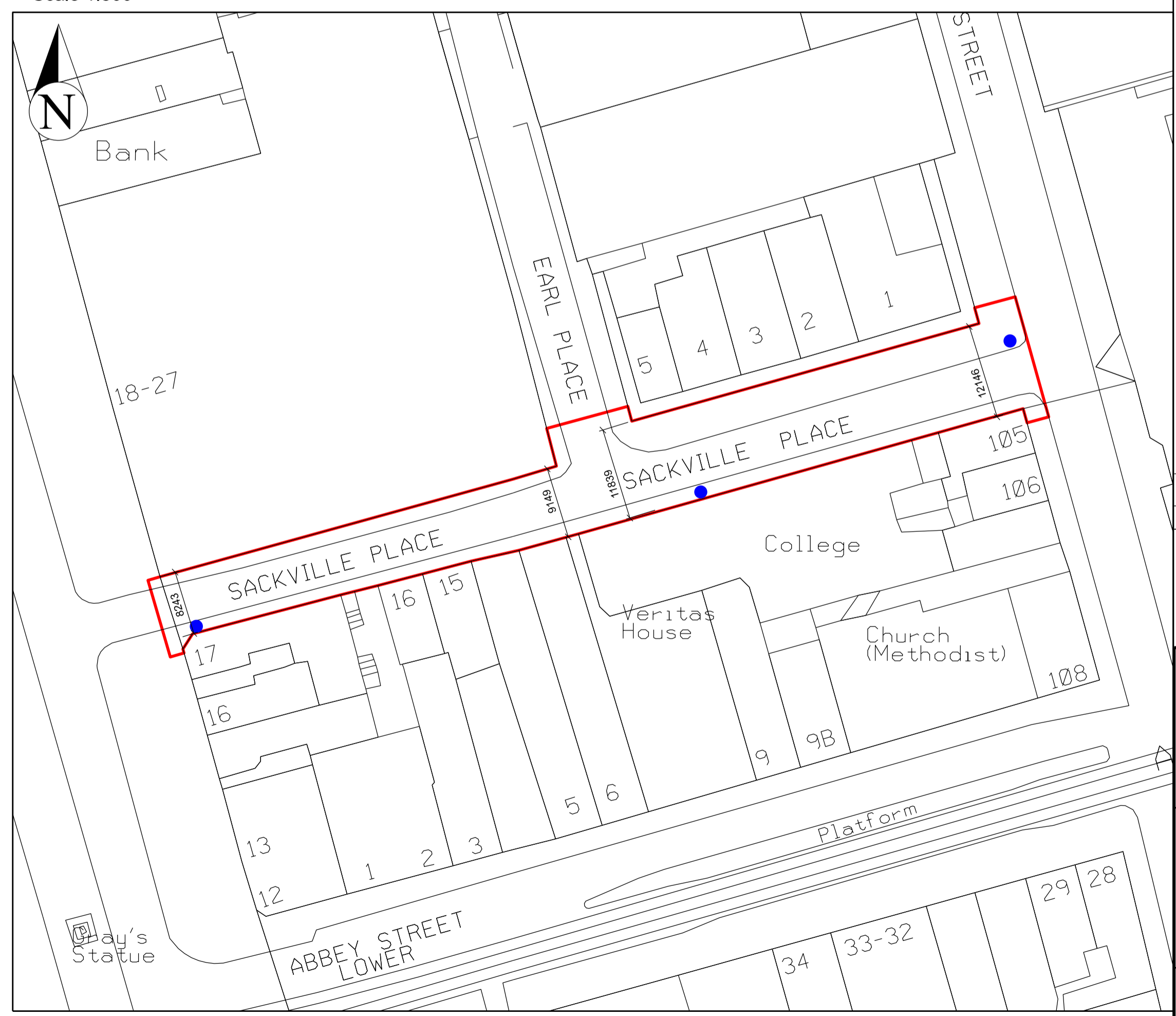

**Site Layout - Cathedral Street**  
 Scale 1:500



**Site Layout - Sackville Place**  
 Scale 1:500

**IMPORTANT**  
 1 DO NOT SCALE FROM THIS DRAWING.  
 2 WORK ONLY FROM FIGURED DIMENSIONS.  
 3 ALL ERRORS & OMISSIONS TO BE REPORTED TO THE ARCHITECT.  
 4 THIS DRAWING IS TO BE READ IN CONJUNCTION WITH ALL OTHER DRAWINGS AND SPECIFICATIONS.

**LEGEND**  
 Site Boundary ———  
 Site Notice Location ●

VER	DATE	DESCRIPTION
-	-	-

**Comhairle Cathrach**  
**Bhaile Atha Cliath**  
**Dublin City Council**  
 RANNAG AILTIRE NA CATHRACH  
**CITY ARCHITECTS DIVISION**

**PROJECT TITLE**  
 Proposed Public Realm Improvement Works to Cathedral Street and Sackville Place  
**PROJECT ARCHITECT**  
 Jeremy Wales  
**PROJECT TEAM**  
 JILL MCGOVERA  
 Darren Mc Grath  
**SCALE**  
 1:1000 & 1:500 @A1  
**DATE**  
 December 2017

**DRAWING TITLE**  
 Site Location & Site Layout

**REFERENCE NO.**  
 CA17028 PLAN-P  
**ISSUE STATUS**  
 001-  
**DWG. NO.**  
 001-  
**VER.**  
 001-  
 CITY ARCHITECTS DIVISION, CIVIC OFFICES, WOOD QUAY, DUBLIN 8, IRELAND  
 T. +353 (0)1 222 3526 F. +353 (0)1 222 2081