

1 Existing Internal Site Elevation of Vehicular / Pedestrian Entrance
Scale 1:100

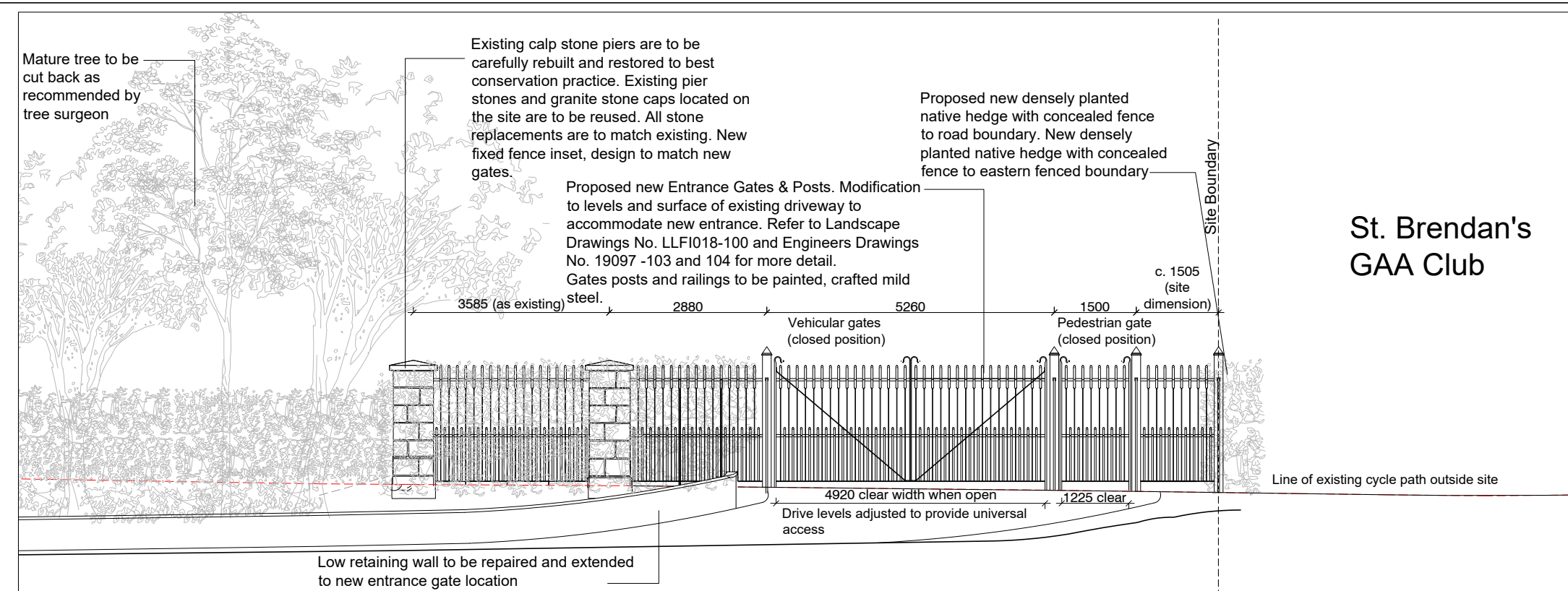

3 Proposed Internal Site Elevation of Vehicular / Pedestrian Entrance
Scale 1:100

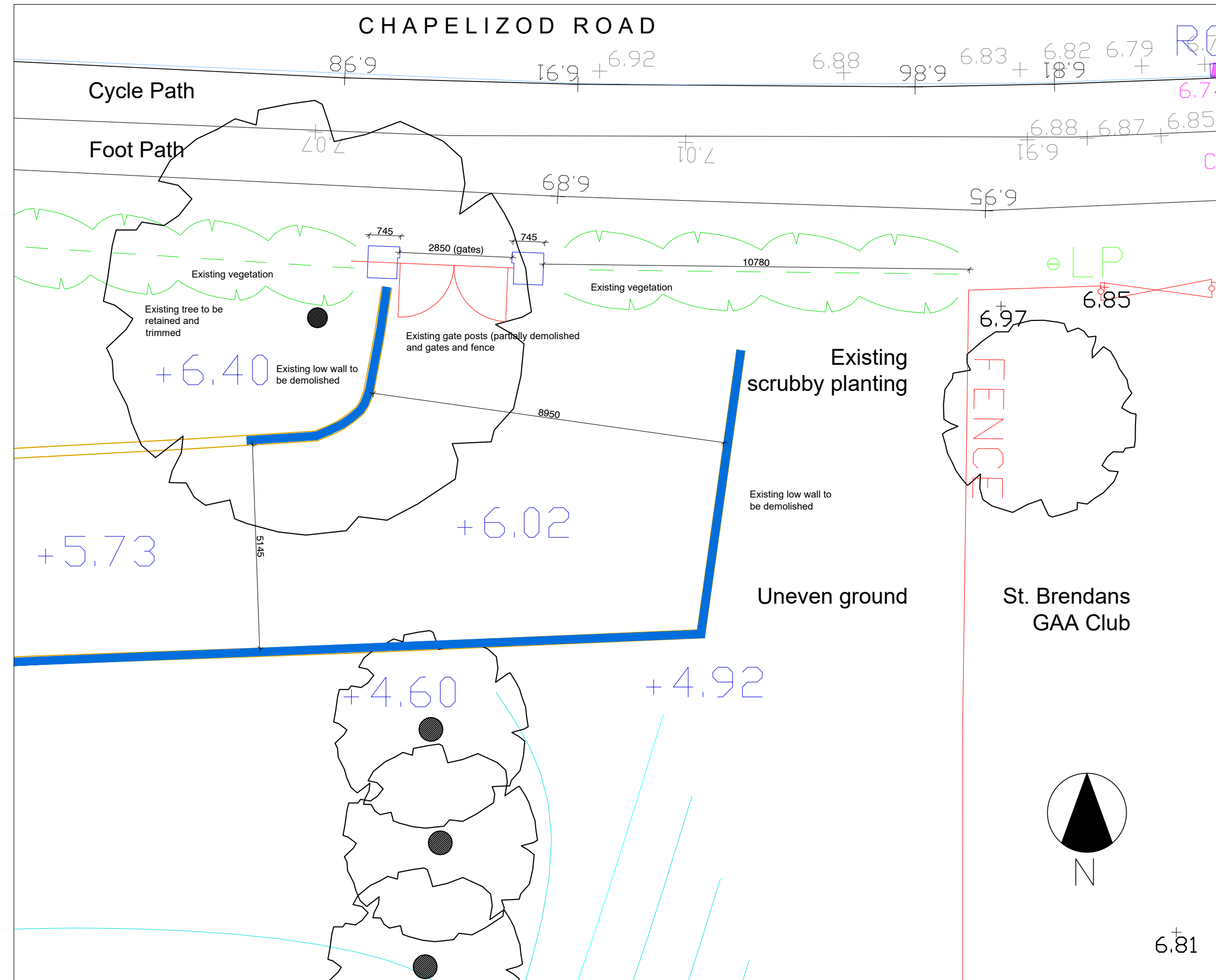

1 Existing Site Plan of Vehicular / Pedestrian Entrance
Scale 1:100

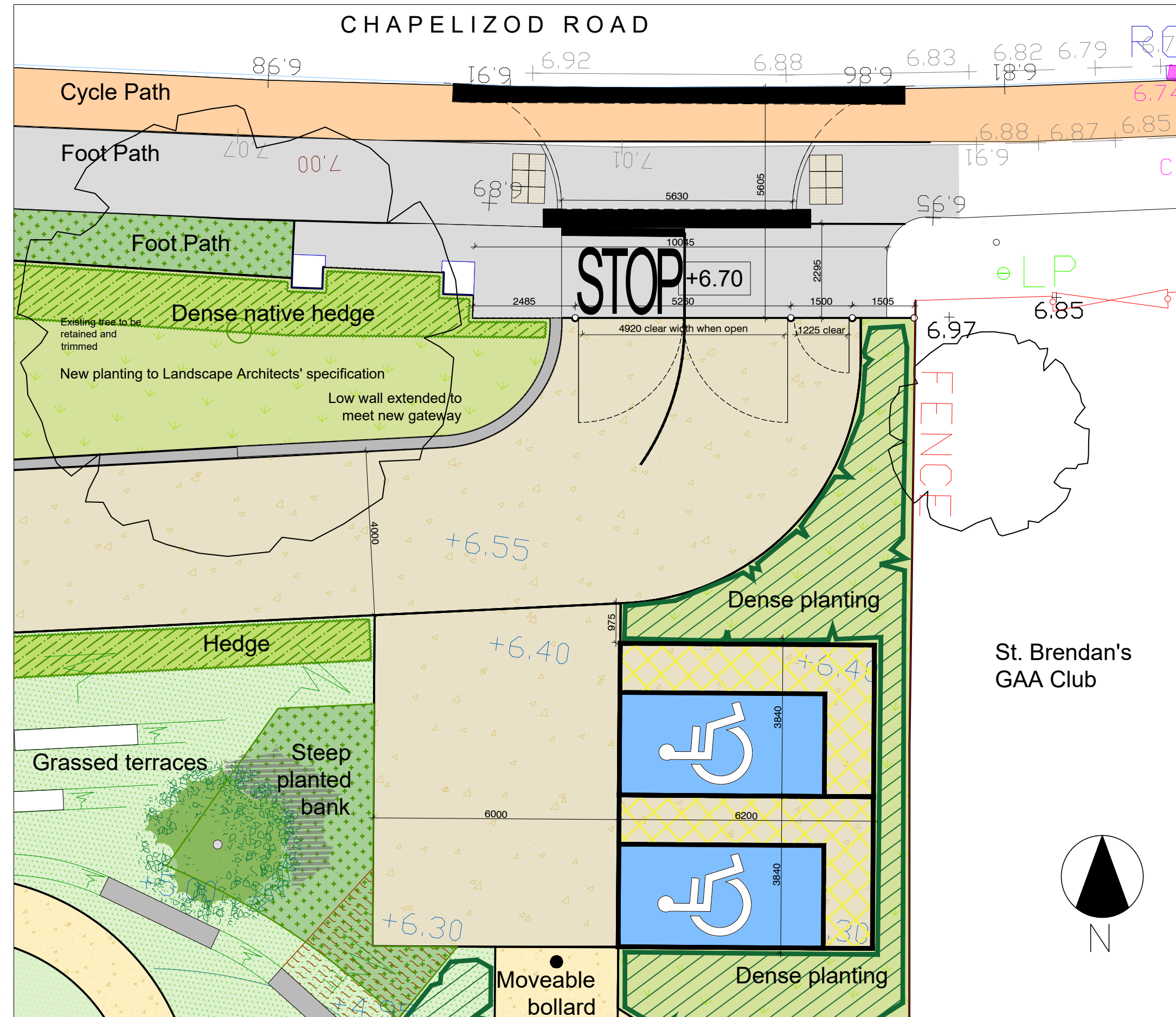

3 Proposed Site Plan of Vehicular / Pedestrian Entrance
Scale 1:100

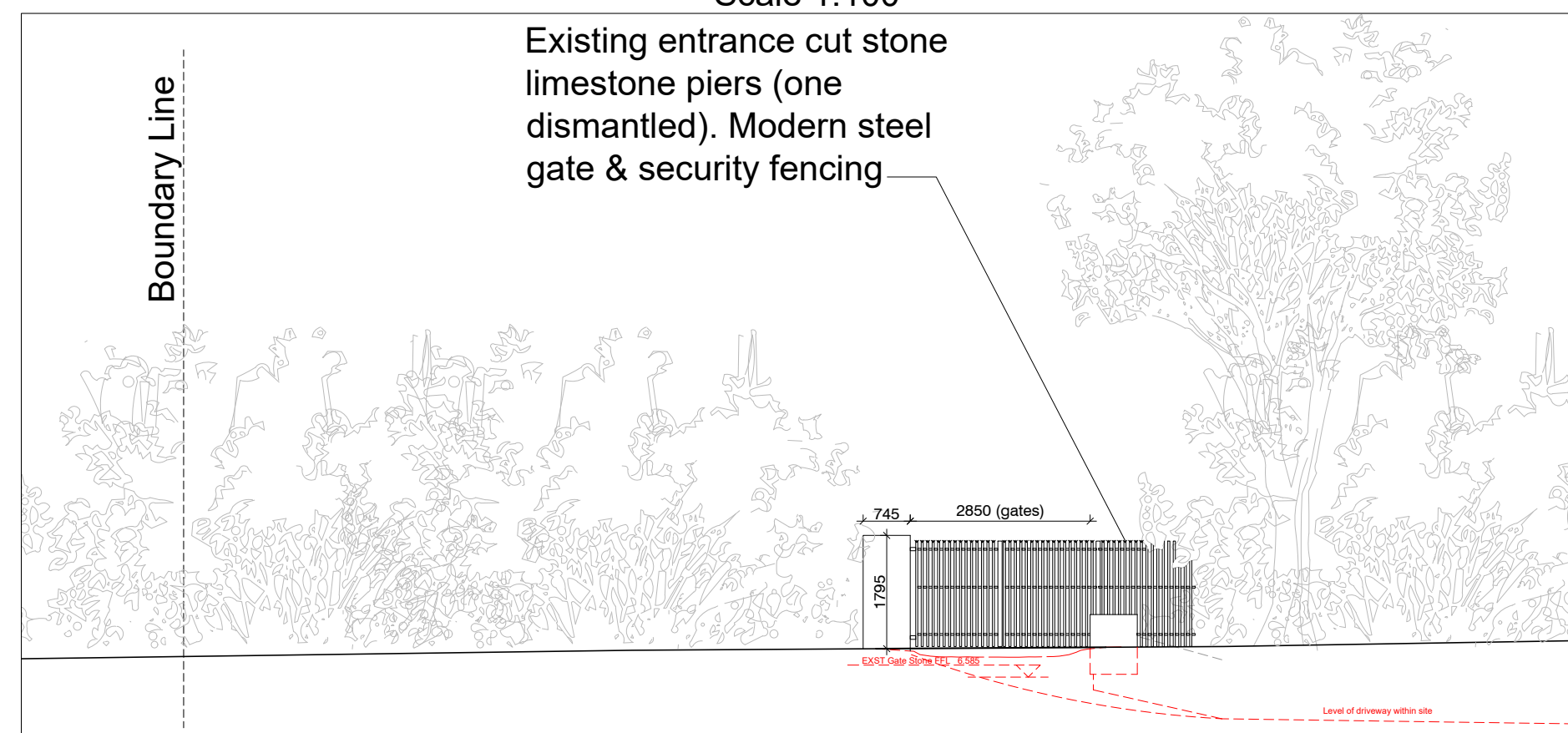

5 Existing External Site Elevation of Vehicular / Pedestrian Entrance
Scale 1:100

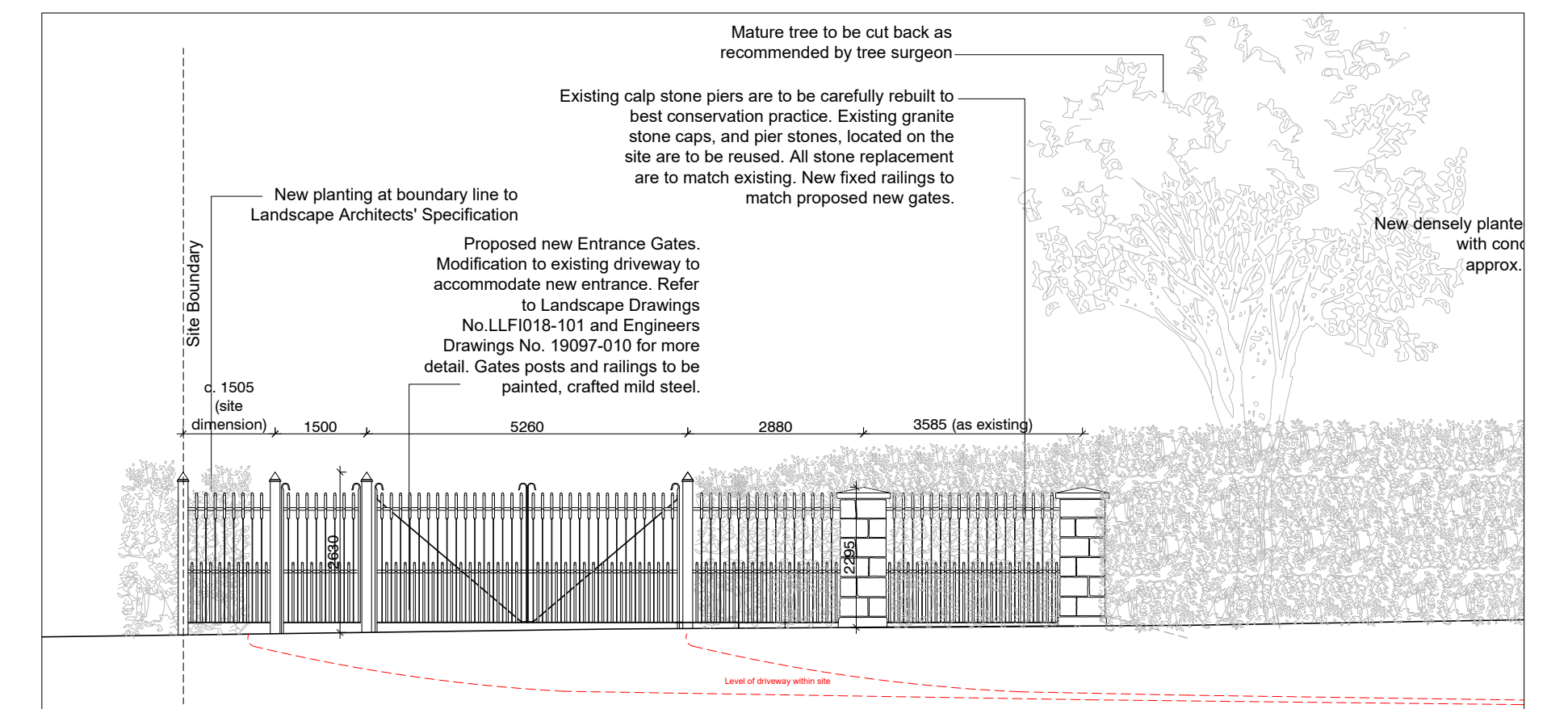

6 Proposed External Elevation of Vehicular / Pedestrian Entrance
Scale 1:100

BLACKWOOD ASSOCIATES ARCHITECTS



20 STEPHEN ST. LOWER, DUBLIN 2
phone: (01) 478 4590
e-mail: studio@blackwood.ie



PLEASE NOTE:
- THIS DRAWING TO BE READ IN CONJUNCTION WITH SPECIFICATIONS AND ALL OTHER CONSULTANTS DRAWING.
- ARCHITECTS TO BE INFORMED OF ANY DISCREPANCIES BEFORE WORK PROCEEDS.
- DO NOT SCALE OFF DRAWINGS.
- THIS DRAWING IS COPYWRITTEN TO BLACKWOOD ASSOCIATES ARCHITECTS

NO.:	DATE:	REVISION:

NO.:	DATE:	REVISION:

PROJECT TITLE:

Cois Abhann Liffey Vale
Biodiversity Centre
for
Dublin City Council

DRAWING TITLE:

Existing & Proposed Vehicular /
Pedestrian Entrance to the Site
Plans & Elevations

PROJECT NO.:	539-19	DRAWN BY:	AB
SHEET SIZE:	A1	CHECKED BY:	AB
SCALE:	1:100	DATE:	27/05/22
DRAWING NO.:	539-Pviii-16	REVISION:	