

ROOF PLAN - PROPOSED
1:100

- LOBBY NOTES**
- New Lobby Door/Glazing
 - ① New timber fin lobby screen.
 - ② New glazed sliding screen
 - ③ New roofed entrance lobby
- ROOF PLAN LEGEND**
- ▨ Existing Asbestos slates to be replaced, New insulated Bangor Blue natural slate roof.
 - ▨ Proposed Roof Upgrade - New Single ply roofing membrane covering on 20-40mm high performance insulating layer
 - ▨ Rooflight glazing to be replaced with Okalux 3D With interstitial louvre system
 - ▨ Proposed M-E ducting
- REFLECTED CEILING PLAN LEGEND**
- ▨ New soffit to underside of air distribution duct
 - ▨ Existing vent grille. Where shown, there is an existing opening in the roof. In all other locations where a soffit is shown, a new hole will be made in the roof to the required size of the air duct.

FREDERICK LANE NORTH

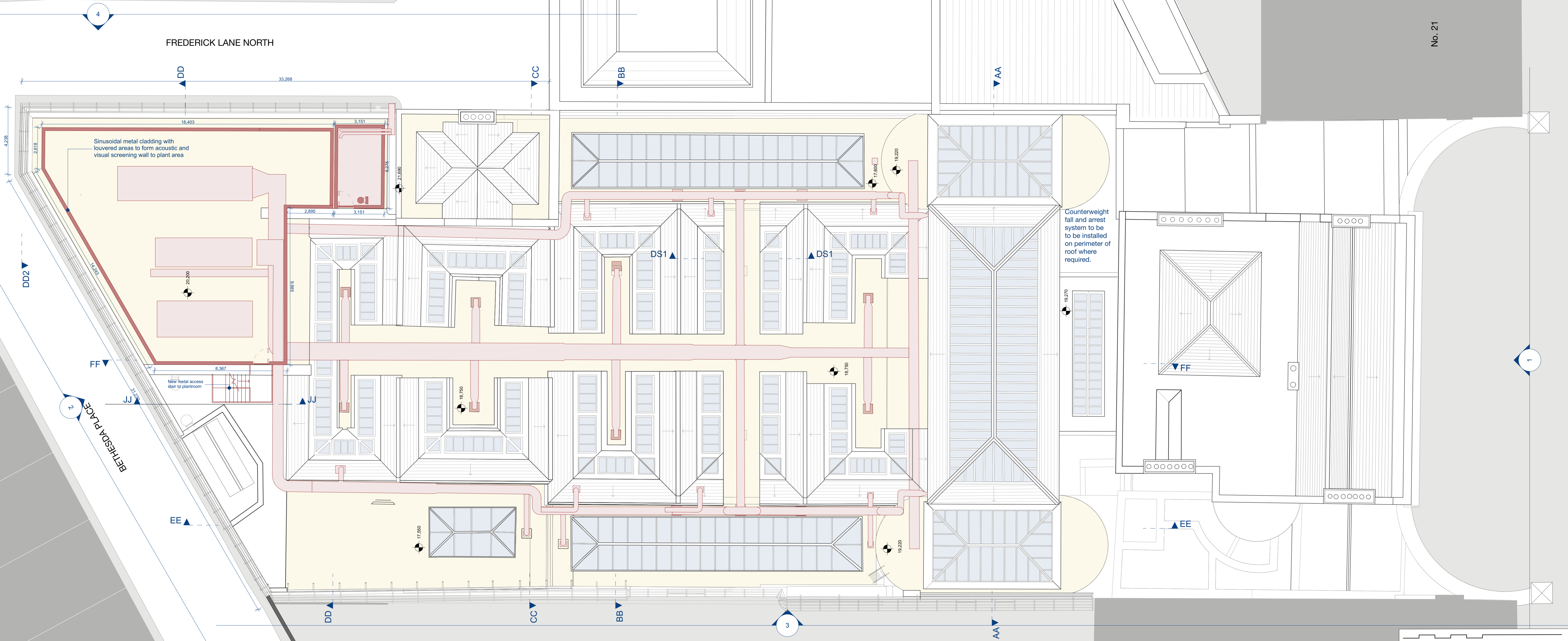

No. 20

No. 21

NOTES	REV	DATE	DESCRIPTION

PROJECT :
Dublin City Gallery, The Hugh Lane - Proposed Upgrade Works
Parnell Square
Dublin 1

TITLE :
Proposed Roof Plan

DATE : 05/06/2019
SCALE : 1:100 @ A1
DRAWN BY : COD / TOC
CHECKED BY : TOC

DWG NO. :
1705_Part 8_02_03

REV NO. :

SHAFFREY ASSOCIATES ARCHITECTS
HISTORIC BUILDINGS - PLANNING - URBAN DESIGN
29 LOWER ORMOND QUAY, DUBLIN 1, IRELAND
T +353 1 8725 602 F +353 1 8725 614 e +studio@shaffrey.ie

