

**GENERAL NOTES**

DO NOT SCALE FROM DRAWINGS. WORK TO FIGURED DIMENSIONS ONLY. ARCHITECT TO BE NOTIFIED OF ANY DISCREPANCIES.  
THIS DRAWING TO BE READ IN CONJUNCTION WITH ALL ARCHITECT'S DRAWINGS, SPECIFICATIONS, CONSULTANTS' DESIGN TEAM DRAWINGS AND SPECIFICATIONS.

NOTE: ALL DUPLEX UNITS TO BE 30 MINUTE FIRE PROTECTED AT STAIRS AND 30MIN FIRE DOORS

**NOTES:**

PLEASE REFER TO MALONE O'NEILL CONSULTING ENGINEERS FOR ALL STRUCTURAL DRAWINGS AND DETAILS.  
PLEASE REFER TO SEMPLE MCKILLOP CONSULTING ENGINEERS DRAWINGS FOR ALL MECHANICAL & ELECTRICAL DETAIL FOR THE FOLLOWING:  
- All proposed Mechanical Ventilation details  
- ACPA min clear opening 1.5m<sup>2</sup> to special details  
- DPM floor details & details  
- Electrical layout & LR Services specification  
- Fire detection system specification & details throughout  
- Escape lighting specification & details & exit signage  
IMPORTANT NOTE: PLEASE REFER TO MITCHELL ASSOCIATES DRAWINGS/REPORT FOR LANDSCAPING DETAILS

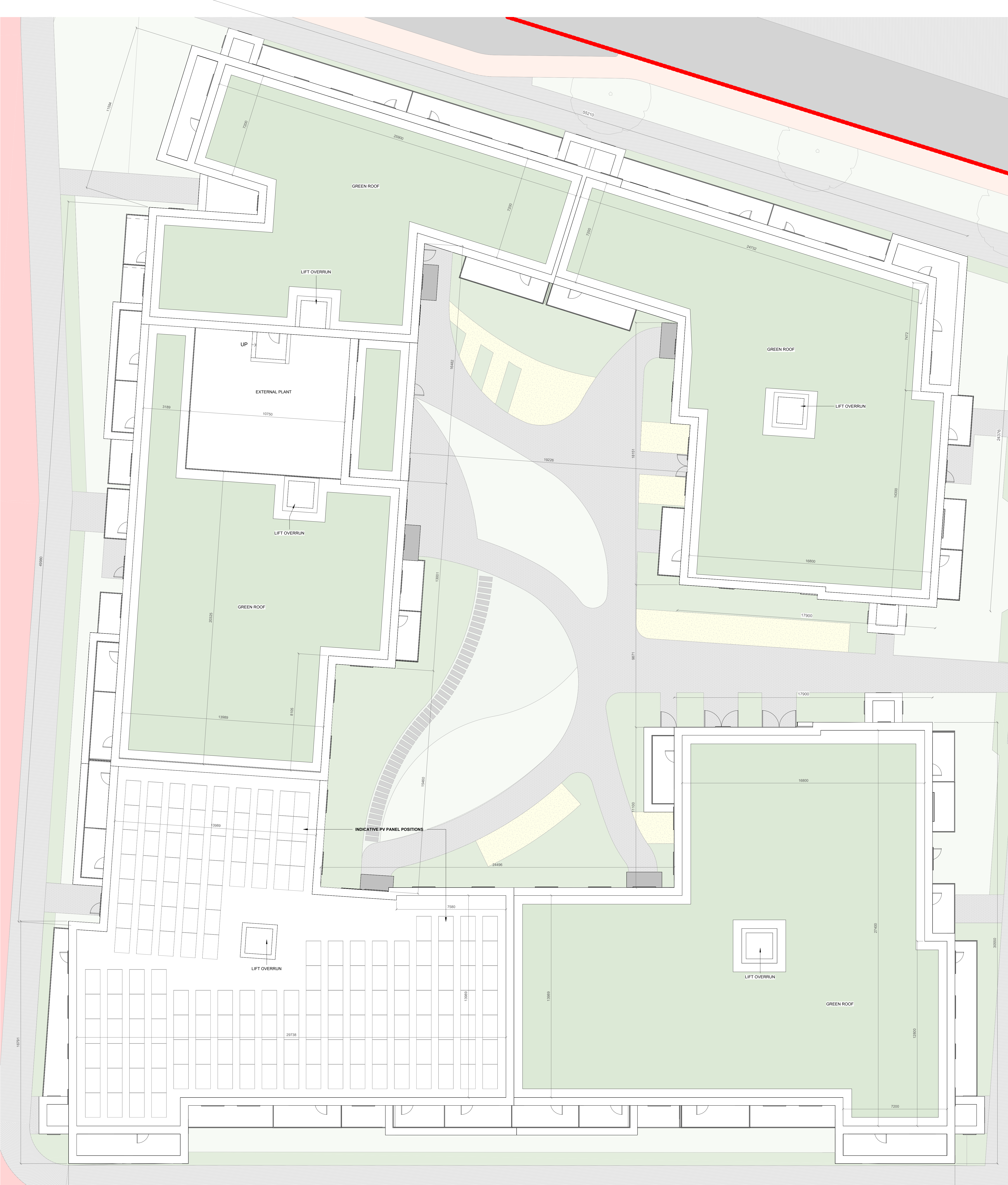
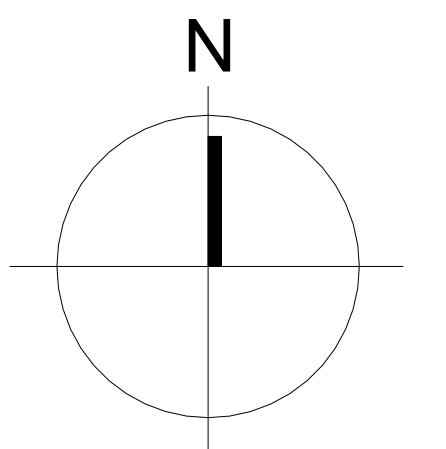
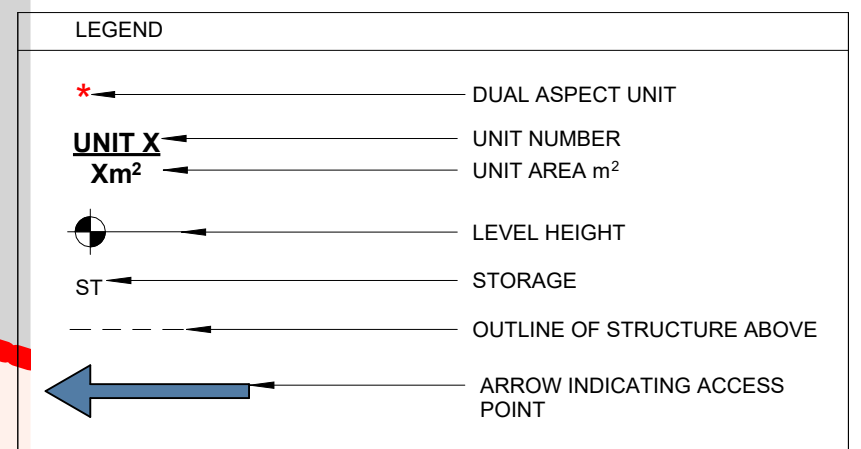
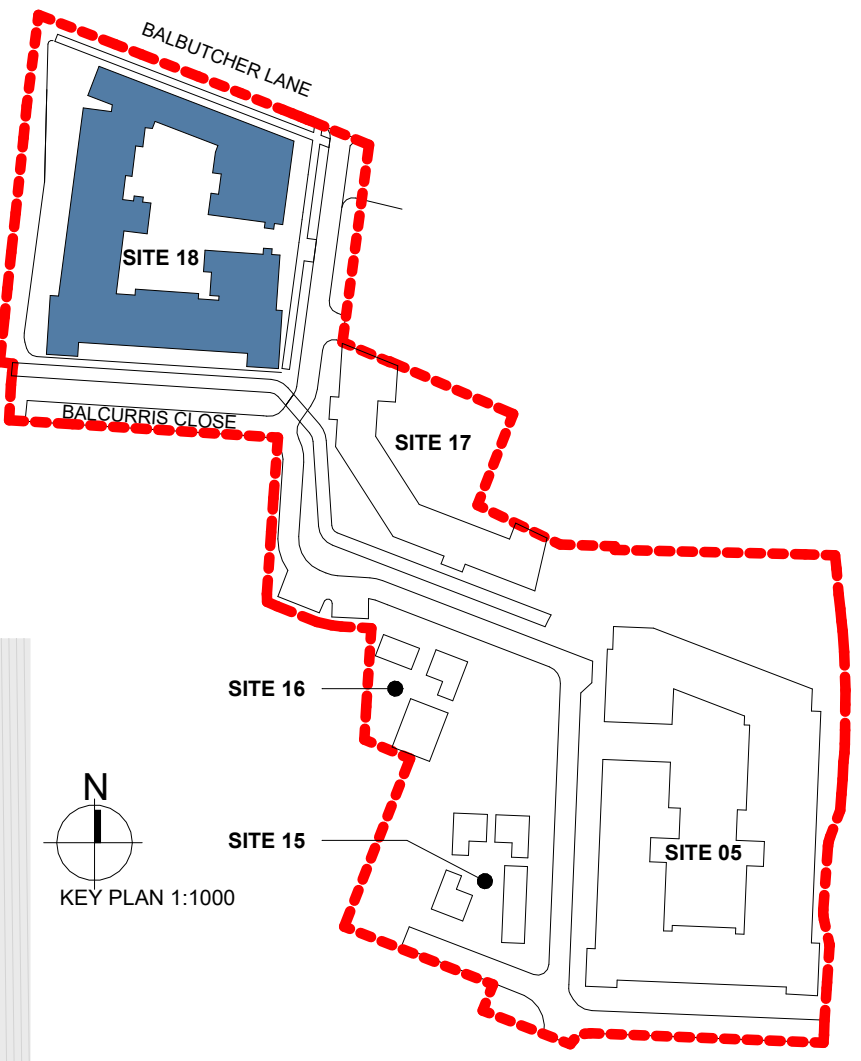

06-ROOF LEVEL  
SCALE: 1 : 100

REV	DATE	DESCRIPTION	ISSUED BY

**FOR PLANNING**

CLIENT: NDFA On behalf of Dublin City Council  
PROJECT: SHB 5 BMD, Ballymun, Dublin 11  
DRAWING: SITE 18- ROOF PLAN

DESIGN	DATE	SCALE	DATE	REVISION	ISSUED BY
JH	PMCM	1:100	17/10/2024	23004	

OPERATION NUMBER: SHB5-BMD-DR-MCORM-AR-P3-1125  
DRAWING CODE: P3

**MCORM**  
ARCHITECTURE AND URBAN DESIGN

No 1 Greenham Street, Dublin 8  
D08 A8Y7 Tel: +353 (0)1 478 8700  
100/101 Central Business Park,  
Tullamore, County Offaly  
R32 F6P5 Tel: +353 (0)7 522 3887  
website: www.mcorm.com  
email: info@mcorm.com

Figured dimensions only to be used. This drawing is copyright of MCORM Ltd. All information is shared as per approved use in accordance with I.S. EN ISO 2017 to I.S. EN ISO 19852:2 2018. If 'Status Code' above is empty, this information has been cleared on Status Code 50 - Work in Progress (WIP) / Draft.