

GENERAL NOTES

DO NOT SCALE FROM DRAWINGS. WORK TO FIGURED DIMENSIONS ONLY. ARCHITECT TO BE NOTIFIED OF ANY DISCREPANCIES.
THIS DRAWING TO BE READ IN CONJUNCTION WITH ALL ARCHITECT'S DRAWINGS, SPECIFICATIONS CONSULTANTS' DESIGN TEAM DRAWINGS AND SPECIFICATIONS.
NOTE: ALL DUPLEX UNITS TO BE 30 MINUTE FIRE PROTECTED AT STAIRS AND 30MIN FIRE DOORS

NOTES:

PLEASE REFER TO MALONE OREGAN CONSULTING ENGINEERS FOR ALL STRUCTURAL DRAWINGS AND DETAILS.
PLEASE REFER TO SEMPLE MCKILLOP CONSULTING ENGINEERS DRAWINGS FOR ALL MECHANICAL & ELECTRICAL DETAIL FOR THE FOLLOWING:
- All proposed Mechanical Ventilation units
- AOV's min clear opening 150mm to specified details
- DWP trap sealings & details
- Electrical layout & LIT Services specification
- Fire detection system specification & smoke throughout
- Escape lighting specification & details & exit signage
IMPORTANT NOTE
PLEASE REFER TO MITCHELL ASSOCIATES DRAWINGS/REPORT FOR LANDSCAPE DETAILS

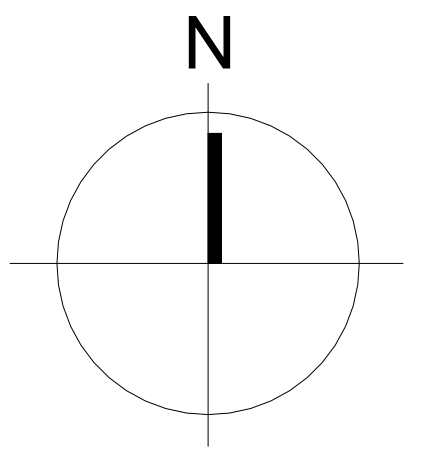
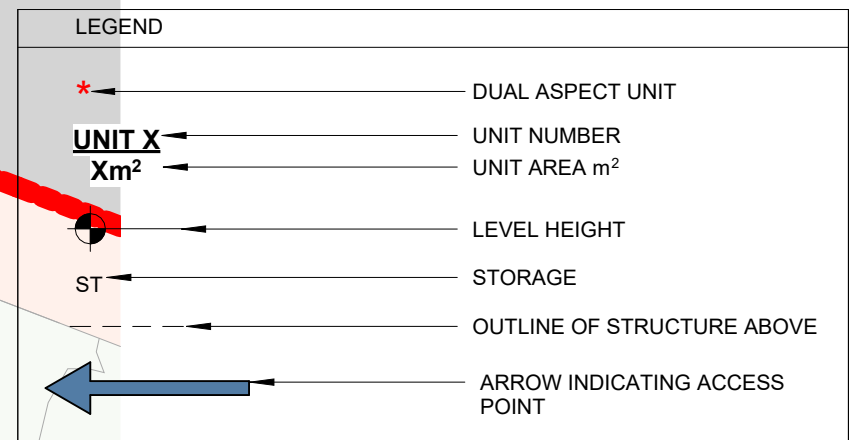
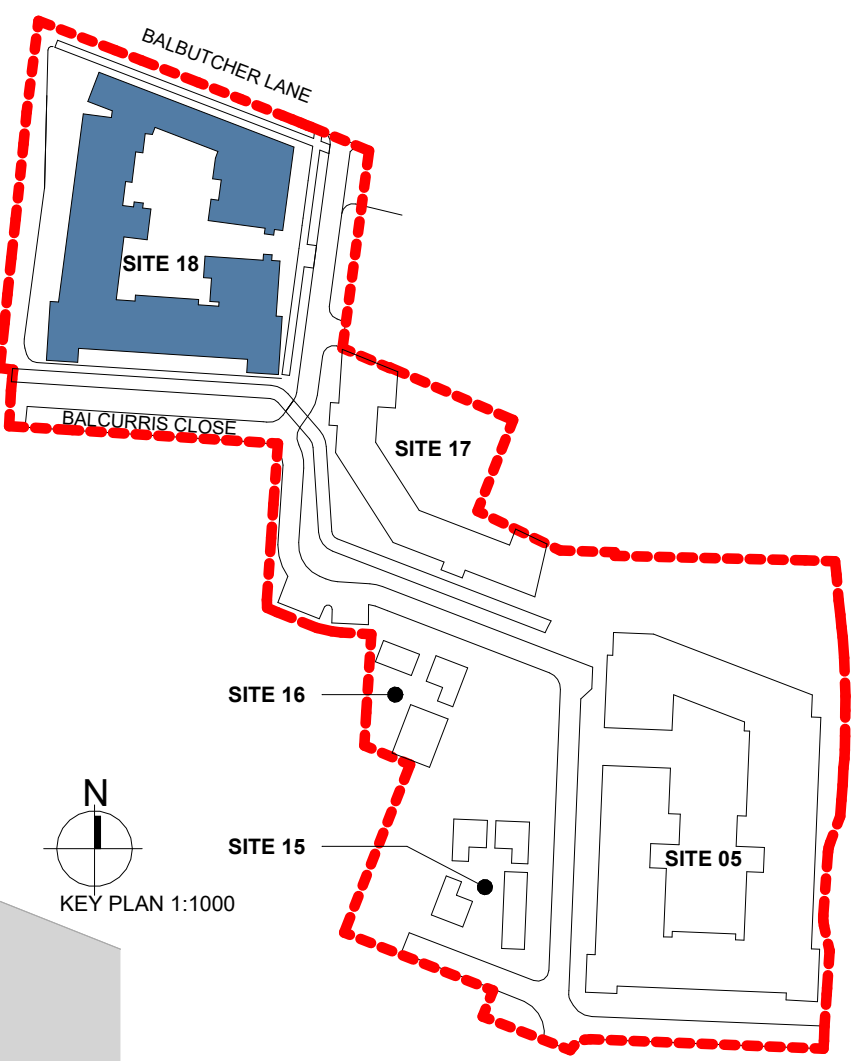

AREA TYPE

- 1 BED APARTMENT TYPE A-1B2P-1
- 2 BED APARTMENT TYPE A-2B4P-2
- 2 BED APARTMENT TYPE A-2B4P-5
- 3 BED APARTMENT TYPE A-2B5P-1
- 3 BED APARTMENT TYPE A-2B5P-4
- CIRCULATION

02-FIRST 0.5
SCALE: 1 : 100

REV	DATE	DESCRIPTION	ISSUED BY

FOR PLANNING

CLIENT: NDFA On behalf of Dublin City Council
PROJECT: SHB 5 BMD, Ballymun, Dublin 11
SITE 18- FIRST FLOOR PLAN

DESIGN	DATE	SCALE	DATE	REVISION	ISSUED BY
JH	17/10/2024	1:100	17/10/2024	23004	

OPERATION NUMBER: SHB5-BMD-DR-MCORM-AR-P3-1121
DRAWING CODE: P3
No 1 Greenbank Street, Dublin 8
D08 A8Y7 Tel: +353 (0)1 478 8700
80-85 Canal Street, Dublin 1
Tullamore, County Offaly
025 16197 Tel: +353 (0)7 522 3887
www.mcorm.com
email: info@mcorm.com

Figured dimensions only to be used. This drawing is copyright of MCORM Ltd. All information is shared as per approved use in accordance with I.S. 848:2017 I.S. EN ISO 19650-2:2018. If 'Status Code' above is empty, this information has been taken from Status Code 01 - Work in Progress (WIP) - Draft.