

Site Location Plan
Scale 1:1000

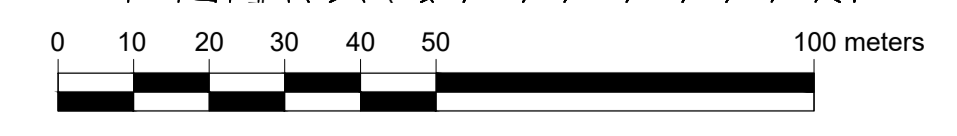

Description:
Digital Cartographic Model (DCM)

Publisher / Source:
Ordnance Survey Ireland (OSi)

Data Source / Reference:
PRIME2

File Format:
Autodesk AutoCAD (DWG_R2013)
File Name:
v_50121864_1.dwg

Clip Extent / Area of Interest (AOI):
LLX.LLY= 715759.8328,738639.7468
LRX.LRY= 716589.8328,738639.7468
ULX.LLY= 715759.8328,739254.7468
URX.LRY= 716589.8328,739254.7468

Projection / Spatial Reference:
Projection= IRENET95_Irish_Transverse_Mercator

Centre Point Coordinates:
X,Y= 716174.8328,738947.2468

Reference Index:

Map Series / Map Sheets
1:1,000 | 3131-15
1:1,000 | 3132-11
1:1,000 | 3132-16
1:1,000 | 3131-20

Data Extraction Date:
Date= 29-May-2020

Source Data Release:
DCLMS Release V1.128.109a

Product Version:
Version= 1.3

License / Copyright:
Ordnance Survey Ireland 'Terms of Use' apply.
Please visit 'www.osi.ie/about/terms-conditions'.

© Ordnance Survey Ireland, 2020

Compiled and published by Ordnance Survey Ireland, Phoenix Park, Dublin 8, Ireland.

Unauthorised reproduction infringes Ordnance Survey Ireland and Government of Ireland copyright.

All rights reserved. No part of this publication may be copied, reproduced or transmitted in any form or by any means without the prior written permission of the copyright owners.

The representation on this map of a road, track or footpath is not evidence of the existence of a right of way.

Ordnance Survey maps never show legal property boundaries, nor do they show ownership of physical features.

© Suirbhéireacht Ordánais Éireann, 2020

Arna thionscail agus arna thionscail ag Suirbhéireacht Ordánais Éireann, Fáirc an Fhionnuisce, Baile Átha Cliath 8, Éire.

Sáralonn atáirgeadh neamhúdaraithe cóipcheart Suirbhéireacht Ordánais Éireann agus Rialtas na hÉireann.

Gach cead ar cosnamh. Ní ceadmhach aon chuid den fhóilséachán seo a chóipeáil, a atáirgeadh nó a tharchur in aon fhorm nó ar aon bhealach gan cead i scríbhinn roimh ré ó úinéirí an chóipchirt.

Ní hionann bóthar, bealach nó cosán a bheith ar an léarscáil seo agus fianaise ar chead síl. Ní thaispeánann léarscáil de chuid Ordánais.

Suirbhéireacht na hÉireann teorann phointí diéathúil de mhaoin riamh, ná úinéireacht de ghnéithe fisiciúla.

Taite Éireann Licence No. **CYAL50400869**

© Taite Éireann / Government of Ireland

Notes:
Do not scale from this drawing.
Use figured dimensions only.
All errors and omissions to be reported to the Architect.
This drawing to be read in conjunction with relevant consultant's drawings.
All dimensions are in millimetres and all levels are in meters to match Datum unless otherwise noted.

Contractor Design responsibility
It is noted that there are many elements within the works that require contractor design, and will be subject to certification as part of BCAR - see Preliminary Inspection Plan for clarity on certification required.

© This drawing or design may not be reproduced without permission.

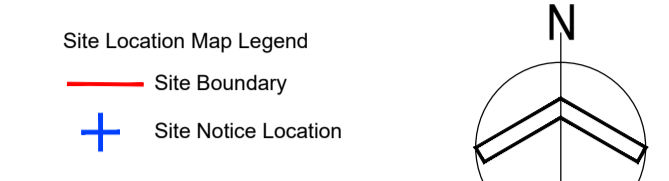

Revisions:

Rev	Description	Date	By
02	Part 8 Planning Submission	19-07-2024	MM
01	Pre-Part 8 Submission	19-04-2024	MM

Project:
PPP SHB 4 - Collins Avenue

Client:
National Development Finance Agency and
Dublin City Council

Title:
Site Location Plan

Drawing / Document Name:
Project Number Project Site Type Originator Role Status Sheet Number

2771	SHB4-CAD-DR-COA-AR-P3	5501
-------------	-----------------------	-------------

Suitability Status: Code - Description **Revision:**

P3	For Planning	02
-----------	--------------	-----------

Scale @ A1 Drawn: Checked: Date:

1:1000	Gizem Kabasakal	Paul Lennon	19-07-2024
--------	-----------------	-------------	------------