

DATE: 5 April 2024
DESIGNER: Unnamed
PROJECT No: 2972
PROJECT NAME: Wellmount Road Lux Plot

**LIGHTING
REALITY**

Development at Wellmount Road

Layout Report

General Data

Dimensions in Metres Angles in Degrees

Calculation Grids

ID	Grid Name	X	Y	X' Length	Y' Length	X' Spacing	Y' Spacing
1	Residential Carpark(Top)	74.48	116.21	41.31	46.73	1.48	1.46
2	Walkway/Pathway	121.61	66.52	19.91	65.31	1.42	1.48
3	Residential Carpark(Bottom...	133.47	42.44	35.37	26.80	1.47	1.49
4	Public Open Area	139.82	75.29	90.18	83.73	1.48	1.50
5	Public Open Area 2	165.71	57.95	74.31	26.50	1.49	1.47

Luminaires



Luminaire A Data

Supplier	Urbis Schreder
Type	AXIA 2.1 5167 Integrated lenses 16 OSLO N SQUARE GIANT@760mA
Lamp(s)	16 OSLO SQUARE GIANT@760mA NW 74 0 230V 00-36-648
LampFlux(klm)/Colour	5.20 NW 4000K/70
File Name	AXIA 2.1 5167 16 OSLO SQUARE GIANT 7 60mA NW 740 39W 434362 Integrated lens...
Maintenance Factor	0.84
Imax70,80,90(cd/klm)	1162.3, 202.9, 3.0
No. in Project	8



Luminaire B Data

Supplier	Urbis Schreder
Type	AXIA 2.1 5165 Integrated lenses 8 OSLO N SQUARE GIANT@350mA
Lamp(s)	8 OSLO SQUARE GIANT@350mA NW 740 230V 00-36-648
LampFlux(klm)/Colour	1.36 NW 4000K/70
File Name	AXIA 2.1 5165 8 OSLO SQUARE GIANT 35 0mA NW 740 10W 464212 Integrated lenses...
Maintenance Factor	0.84
Imax70,80,90(cd/klm)	1587.4, 164.9, 1.3
No. in Project	7



Luminaire C Data

Supplier	Urbis Schreder
Type	AXIA 2.1 5167 Integrated lenses 16 OSLO N SQUARE GIANT@400mA
Lamp(s)	16 OSLO SQUARE GIANT@400mA NW 74 0 230V 00-36-648
LampFlux(klm)/Colour	3.00 NW 4000K/70
File Name	AXIA 2.1 5167 16 OSLO SQUARE GIANT 4 00mA NW 740 21W 434362 Integrated lens...
Maintenance Factor	0.84
Imax70,80,90(cd/klm)	1162.3, 202.9, 3.0
No. in Project	10

Layout

ID	Type	X	Y	Height	Angle	Tilt	Cant	Out-reach	Dimmed to	Target X	Target Y	Target Z
1	A	137.61	67.94	6.00	296.00	0.00	0.00	0.60	85%			
2	A	144.72	52.61	6.00	116.00	0.00	0.00	0.60	85%			
3	A	158.63	66.37	6.00	209.00	0.00	0.00	0.60	85%			
4	B	147.38	79.10	6.00	296.00	0.00	0.00	0.60	85%			
5	B	123.63	69.27	6.00	21.00	0.00	0.00	0.60	100%			
6	B	118.40	80.04	6.00	26.00	0.00	0.00	0.60	100%			

Layout Continued

ID	Type	X	Y	Height	Angle	Tilt	Cant	Out-reach	Dimmed to	Target X	Target Y	Target Z
7	B	102.11	113.80	6.00	26.00	0.00	0.00	0.60	100%			
8	B	112.83	92.20	6.00	26.00	0.00	0.00	0.60	100%			
9	B	108.37	102.14	6.00	26.00	0.00	0.00	0.60	100%			
10	B	96.66	125.66	6.00	26.00	0.00	0.00	0.60	100%			
11	A	130.09	91.54	6.00	205.00	0.00	0.00	0.60	85%			
12	A	92.19	139.49	6.00	31.00	0.00	0.00	0.60	100%			
13	A	62.60	146.07	6.00	80.00	0.00	0.00	0.60	100%			
14	A	77.58	143.37	6.00	84.00	0.00	0.00	0.60	100%			
15	C	189.77	93.33	6.00	321.00	0.00	0.00	0.60	100%			
16	C	171.85	78.03	6.00	306.00	0.00	0.00	0.60	100%			
17	C	215.23	113.03	6.00	51.00	0.00	0.00	0.60	100%			
18	C	153.57	91.45	6.00	208.00	0.00	0.00	0.60	100%			
19	C	179.42	123.16	6.00	74.00	0.00	0.00	0.60	100%			
20	C	143.77	130.31	6.00	78.00	0.00	0.00	0.60	100%			
21	C	133.36	112.04	6.00	214.00	0.00	0.00	0.60	100%			
22	C	114.22	141.43	6.00	228.00	0.00	0.00	0.60	100%			
23	C	165.57	115.99	6.00	81.00	0.00	0.00	0.60	80%			
24	A	115.75	118.88	6.00	204.00	0.00	0.00	0.60	85%			
25	C	198.26	110.58	6.00	335.00	0.00	0.00	0.60	100%			

Horizontal Illuminance (lux)

Residential Carpark(Top)



Results

Eav	10.62
Emin	1.76
Emax	20.46
Emin/Emax	0.09
Emin/Eav	0.17

Horizontal Illuminance (lux)

Walkway/Pathway

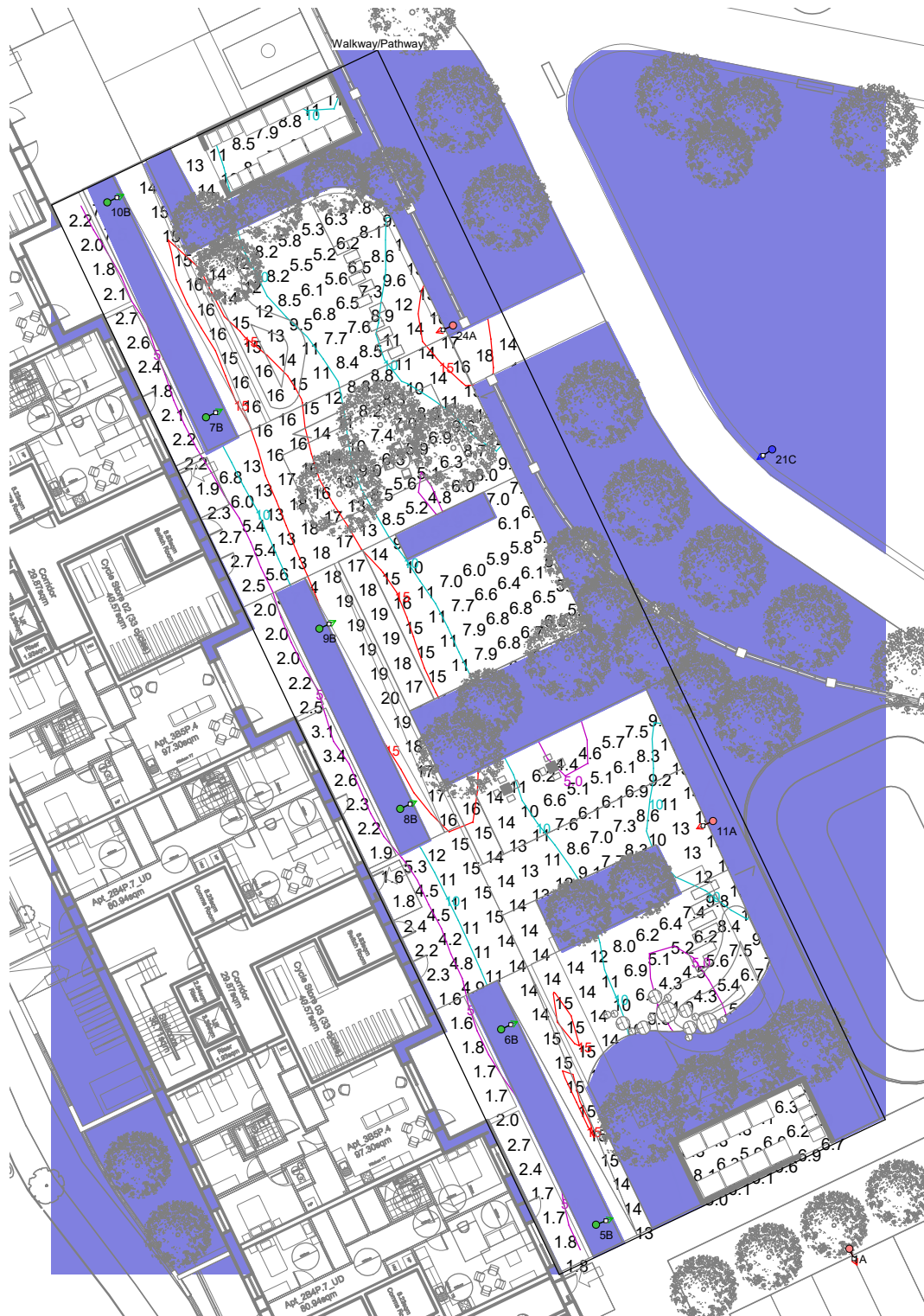

Results

Eav	9.53
Emin	1.57
Emax	5 19.69

Horizontal Illuminance (lux)

Residential Carpark(Bottom)

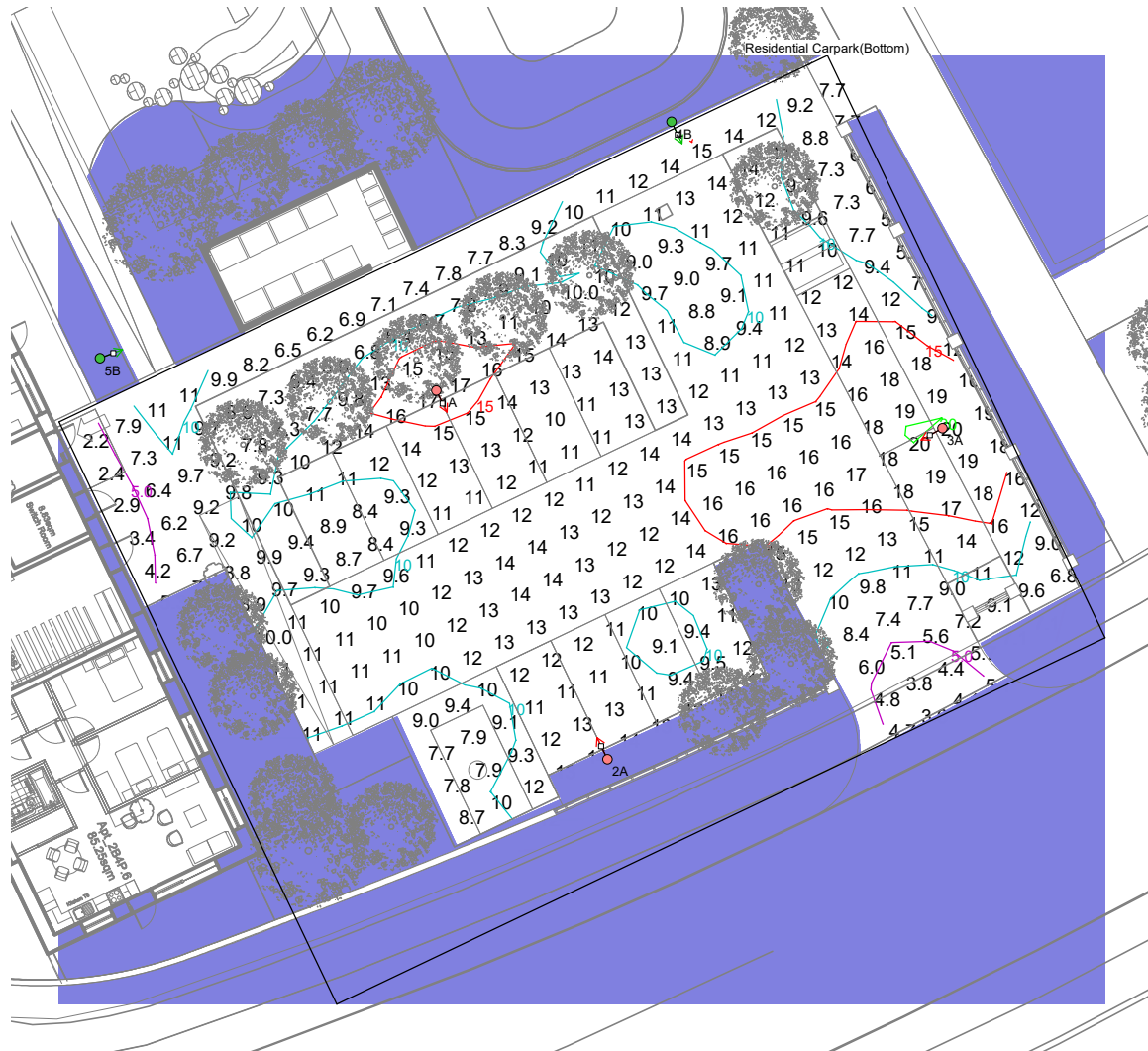

Results

Eav	11.15
Emin	2.22
Emax	20.23
Emin/Emax	0.11
Emin/Eav	0.20

Horizontal Illuminance (lux)

Public Open Area

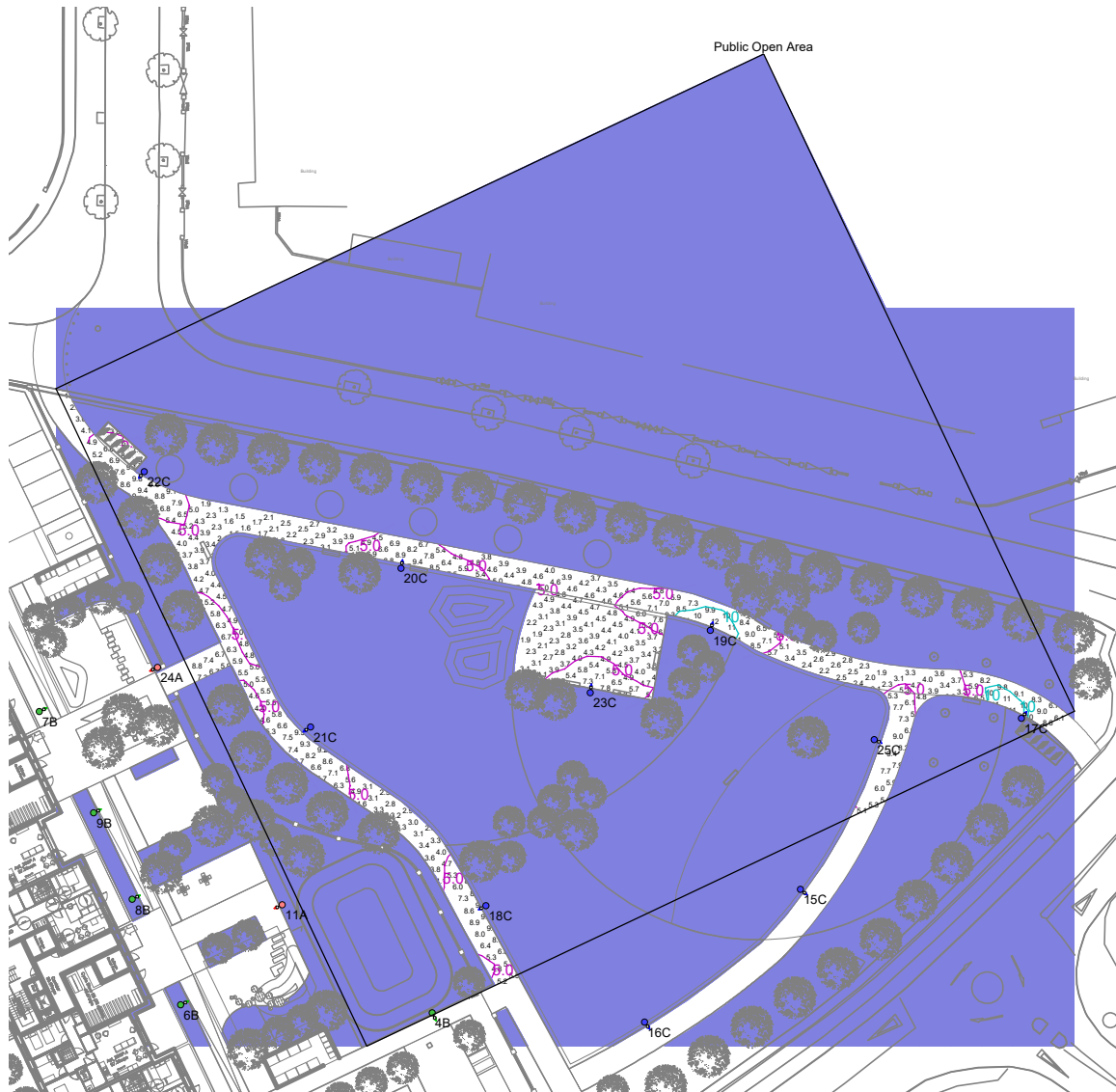

Results

Eav	5.36
Emin	1.33
Emax	12.17
Emin/Emax	0.11
Emin/Eav	0.25

Horizontal Illuminance (lux)

Public Open Area 2



Results

Eav	6.26
Emin	3.18
Emax	10.54
Emin/Emax	0.30
Emin/Eav	0.51