

NOTES RELATING TO STREET LIGHTING DESIGN

Street & Car parking (LIGHTING CLASS P3)  
 Results - Horizontal Illuminance (lx)  
 Eave= 8.75  
 Emax= 1.90  
 EminEave= 0.22  
 EmaxEave= 0.10  
 EminEave= 0.22  
 EmaxEave= 2.18

Park Area (LIGHTING CLASS P4)  
 Results - Horizontal Illuminance (lx)  
 Eave= 6.06  
 Emax= 1.36  
 EminEave= 0.07  
 EmaxEave= 0.22  
 EmaxEave= 3.01

Service Road (LIGHTING CLASS P4)  
 Results - Horizontal Illuminance (lx)  
 Eave= 5.58  
 Emax= 1.89  
 EminEave= 0.12  
 EmaxEave= 0.34  
 EmaxEave= 2.72

Luminaire Data  
 LUMINAIRE A: MASON 3.1 520° INTEGRATED LENSES 16 OSOLON SQUARE GIANT @600MA  
 LUMINAIRE B: MASON 3.1 520° INTEGRATED LENSES 8 OSOLON SQUARE GIANT @600MA  
 LAMP 8 OSOLON SQUARE GIANT @600MA NW 740 230V 01-37-041 MF 0.80

- Key
- Luminaire A Column
  - Luminaire B Column
  - Beam Aiming Target
  - Photometric Centre

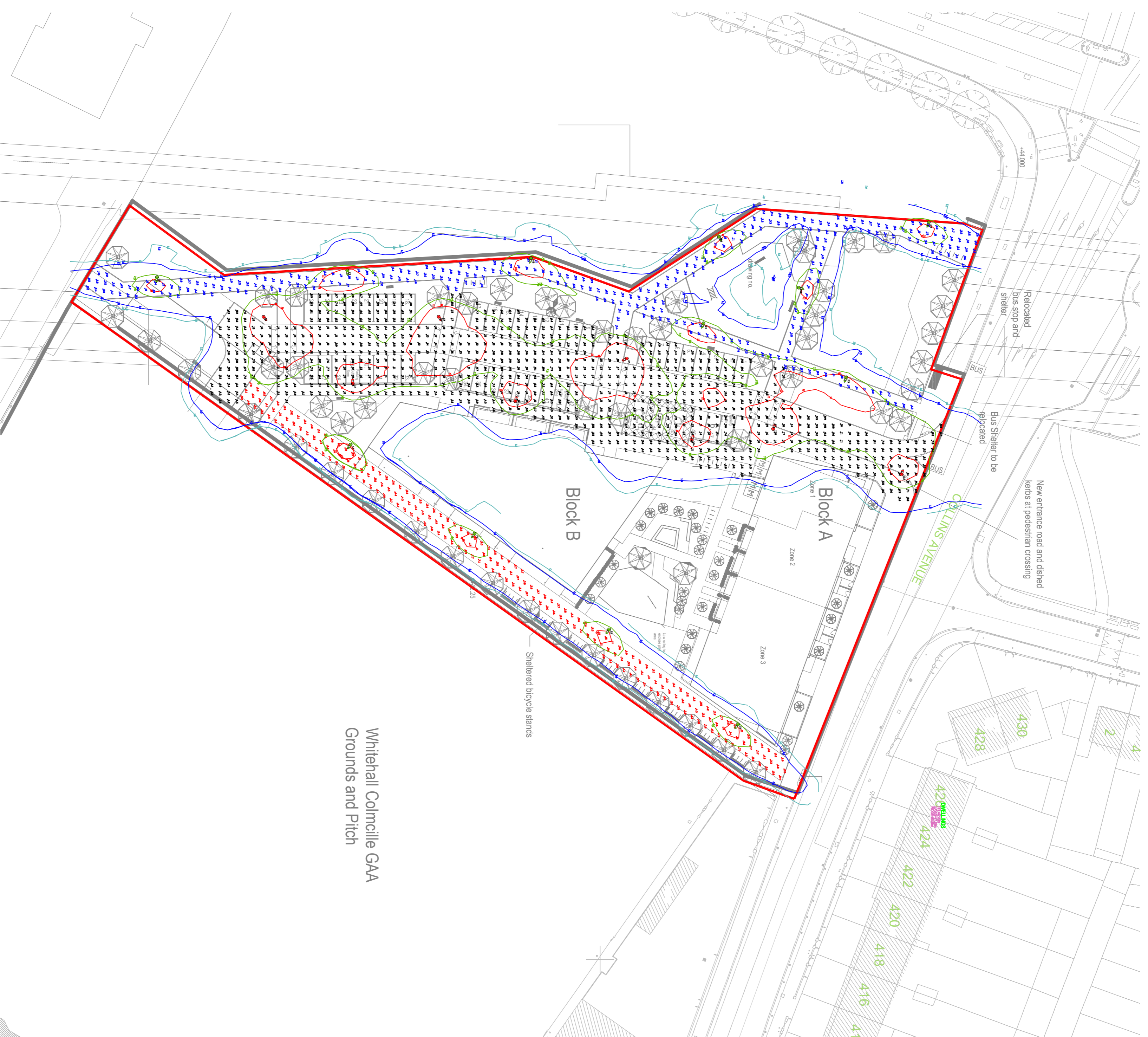

Whitehall Colmcille GAA  
 Grounds and Pitch

LEGEND	
	EXISTING STREET/SITE LIGHTING WITHIN 100mm DUCT
	PROPOSED PUBLIC LIGHTING DUCTING ROUTE. DUCTS SHALL BE 45mm MINIMUM SIZE WITH 100mm SPARE DUCTS DEPLOYED AT ROAD CROSSINGS.
	PROPOSED PUBLIC LIGHTING DUCTING ROUTE. DUCTS SHALL BE HIGH DENSITY POLYETHYLENE PIPE TO ICS159 CLASS B. MINIMUM SIZE 50mm
	PROPOSED PUBLIC LIGHTING SECTION PILLAR. PROPOSED SECTION PILLAR SHALL BE LOCATED A MINIMUM DISTANCE 2M FROM ESB MINI-PILLARS.
	EXISTING ESB NETWORKS POLE
	EXISTING ESB NETWORKS MANIPILLAR AND/OR RECESSED VAULT
	PROPOSED ESB NETWORKS MINI-PILLAR & V02 VAULT ARRANGEMENT
	EXISTING ESB M/V/LV SUB-STATION
	PROPOSED ESB M/V/LV SUB-STATION
	PROPOSED (I&B) CONCRETE DRAW PIT INSPECTION SERVICES
	DENOTES 30.8W PUBLIC LIGHTING LUMINAIRE MOUNTED ON 6M COLUMN
	DENOTES 11W PUBLIC LIGHTING LUMINAIRE MOUNTED ON 6M COLUMN

NOTES RELATING TO STREET LIGHTING INSTALLATIONS:

THE PUBLIC LIGHTING DESIGN SHALL FULLY COMPLY WITH IS 1201 PARTS 1-5

THE CONTRACTOR SHALL NOTE THAT ALL PUBLIC LIGHTING DUCTING TO BE RED HIGH DENSITY POLYETHYLENE HOPEL DUCTS STAMPED STREET LIGHTING OR LIGHTING REQUIREMENTS IN ACCORDANCE WITH DUBLIN CITY COUNCIL PUBLIC LIGHTING REQUIREMENTS

CONTRACTOR SHALL ENSURE THAT ALL ESBN SUPPLY POINTS, PUBLIC LIGHTING BOUNDARIES OF PRIVATE PROPERTY, SERVICES AND SPECIFICATIONS

ALL COLUMNS SHALL BE OF TUBULAR STEEL CONSTRUCTION WITH A MINIMUM WALL THICKNESS OF 3mm. NO CORROSION RESISTANT BUT WELDING SHALL BE USED IN CONNECTION WITH PUBLIC LIGHTING DIVISION REQUIREMENTS & SPECIFICATIONS

COLUMNS SHALL HAVE FITTED COMPARTMENT DOORS SET AT A HEIGHT OF 1.5m TO FROM FINISHED ROAD LEVEL AND NORMALLY FACED AWAY FROM ONCOMING TRAFFIC.

THE OUTSIDE OF THE PLANTED PORTION OF ALL COLUMNS SHALL BE PROTECTED BY A BITUMINOUS COATING EXTENDING TO A HEIGHT OF 150mm ABOVE GROUND LEVEL. ALL DUCTS SHALL BE PLACED OUTSIDE THE BOUNDARIES OF PROPERTIES AND SHALL NOT AT ANY TIME PASS THROUGH ESB OR EIR TELECOM CHAMBERS

THE CONTRACTOR SHALL ENSURE THAT SPARE DUCTS ARE LAID ACROSS ALL DRIVEWAY APRONS. SPARE DUCT SHALL BE PROVIDED AT EACH ROAD CROSSING. IN ALL SITUATIONS ELECTRICAL HAZARD WARNING TAPE AS PER ET10101.2020 SHALL BE LAID AT THE APPROPRIATE DEPTH.

CABLEING DEPLOYED FOR STREET LIGHTING SHALL BE MINIMUM 26mm SQ PVC/SW/MVC OR XLPE/SW/MVC

A BARE COPPER OR HOT DIP GALV IRON EARTH ROD 16mm DIA SHALL BE SUNK TO A MINIMUM 1.5m BELOW FINISHED ROAD LEVEL. THE ROD SHALL BE INSPECTED AND SHALL BE INSTALLED WITH SUITABLE INSPECTION BOXES TO FACILITATE INSPECTION OF THE EARTH CONDUCTOR CONNECTION TO THE ROAD.

ELECTRICAL CONTRACTOR SHALL REFER TO DUBLIN CITY COUNCIL GUIDELINES FOR PUBLIC LIGHTING INSTALLATIONS AND ENSURE THAT THEIR INSTALLATIONS FULLY COMPLIES WITH THIS DOCUMENT.

REV	DESCRIPTION	DRN	CHKD	DATE
P01	PRE PLANNING ISSUE	NB	SF	19.11.2021
P02	LANDSCAPE COORDINATION	NB	SF	04.02.2022
P03	LANDSCAPE COORDINATION & DDC COMMENTS	NB	SF	13.04.2022
P04	UPDATED TO ARCHITECTS LAYOUT	NB	SF	28.04.2022

PRELIMINARY STAGE

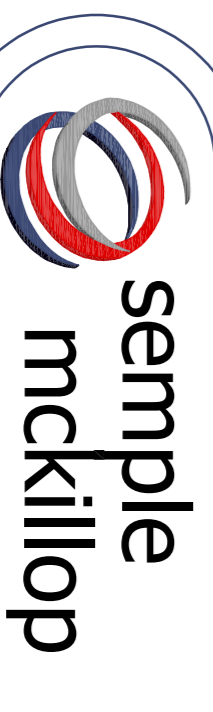

NATURALLY INNOVATIVE CONSULTING ENGINEER

REGISTRATION NO: 15074001  
 ISO 45001  
 ISO 14001

REGISTRATION NO: 444 (0)28 90331700  
 Castleblayney +353 (0)42 9749570

PROJECT TITLE  
 PPP SOCIAL HOUSING BUNDLE 3  
 COLLINS AVENUE, WHITEHALL, DUBLIN 9

DRAWING TITLE  
 PUBLIC LIGHTING DUCTING REQUIREMENTS

DRAWING REFERENCE  
 Z146-SMK-XX-ZZ-DR-E-6054

DRN NB  
 SCALE A1 1:50C