

NO PART OF THIS DRAWING MAY BE REPRODUCED OR TRANSMITTED IN ANY FORM OR STORED IN ANY RETRIEVAL SYSTEM OF ANY NATURE WITHOUT THE WRITTEN PERMISSION OF MALONE O'REGAN CONSULTING ENGINEERS AS COPYRIGHT HOLDER EXCEPT AS AGREED FOR USE ON THE PROJECT FOR WHICH THE DRAWING WAS ORIGINALLY CREATED.

THIS DRAWING IS TO BE READ IN CONJUNCTION WITH ALL OTHER RELEVANT DRAWINGS, SPECIFICATIONS AND THE PRELIMINARY HEALTH & SAFETY PLAN. ALL DIMENSIONS ARE IN mm UNLESS NOTED OTHERWISE. DO NOT SCALE DIMENSIONS.

THE CONTRACTOR SHALL CHECK ALL DIMENSIONS PRIOR TO THE COMMENCEMENT OF CONSTRUCTION. ALL DISCREPANCIES SHALL BE REPORTED TO THIS OFFICE IN WRITING.

LOCAL AUTHORITY / COUNTY COUNCIL GUIDELINES FOR THE DESIGN AND CONSTRUCTION OF HOUSING MANUAL TO TAKE PRECEDENCE WHERE ANY CONFLICT OCCURS. GREATER DUBLIN REGIONAL CODE OF PRACTICE TO TAKE PRECEDENCE WHERE ANY CONFLICT OCCURS.

- 1. ALL DIMENSIONS IN MILLIMETRES (MM) UNLESS NOTED OTHERWISE.
2. THE MINIMUM DEPTH OF COVER FROM THE FINISHED SURFACE TO THE CROWN OF GRAVITY PIPES WITHOUT PROTECTION SHOULD BE AS FOLLOWS:
6. DOMESTIC GARDENS AND PATHWAYS WITHOUT ANY POSSIBILITY OF VEHICULAR ACCESS - DEPTH NOT LESS THAN 0.5m.
b. DOMESTIC DRIVEWAYS, PARKING AREAS AND YARDS WITH HEIGHT RESTRICTIONS TO PREVENT ENTRY BY VEHICLES WITH A GROSS VEHICLE WEIGHT IN EXCESS OF 7.5 TONNES - DEPTH NOT LESS THAN 0.75m.
c. DOMESTIC DRIVEWAYS, PARKING AREAS AND NARROW STREETS WITHOUT FOOTWAYS (E.G. MOWS DEVELOPMENTS) WITH LIMITED ACCESS FOR VEHICLES WITH A GROSS VEHICLE WEIGHT IN EXCESS OF 7.5 TONNES - DEPTH NOT LESS THAN 0.9m.
d. DEPTHS OF SEWERS IN GATED ESTATES SHALL BE SIMILAR TO THAT OUTLINED ABOVE.
e. AGRICULTURAL LAND AND PUBLIC OPEN SPACE - DEPTH NOT LESS THAN 0.9m.
f. OTHER HIGHWAYS AND PARKING AREAS WITH UNRESTRICTED ACCESS TO VEHICLES WITH A GROSS VEHICLE WEIGHT IN EXCESS OF 7.5 TONNES - DEPTH NOT LESS THAN 1.2m.
3. CLAUSE 804 MATERIAL IN ACCORDANCE WITH THE NATIONAL ROADS AUTHORITY SPECIFICATION FOR ROAD WORKS IS TO BE USED AS BACKFILL MATERIAL WHERE THE SEWER MAIN IS LOCATED IN ROADS, FOOTPATHS OR WHEN THE NEAREST PART OF THE TRENCH IS WITHIN 1M OF THE PAVED EDGE OF THE ROADWAY. CLAUSE 804 IS TO BE COMPACTED AS PER CLAUSE 802 OF THE NATIONAL ROADS AUTHORITY SPECIFICATION FOR ROAD WORKS.
4. SELECTED EXCAVATED MATERIAL MAY BE USED IN GREEN-FIELD AREAS ABOVE GRANULAR PIPE SURROUND MATERIAL SUBJECT TO THE APPROVAL OF IRISH WATER.
5. PIPE BEDDING SHALL COMPLY WITH WIS 4-08-02 AND IGN 4-08-01 GRANULAR MATERIAL SHALL BE 14MM TO 5MM GRADED AGGREGATE OR 10MM SINGLE SIZED AGGREGATE.
6. IN SOFT GROUND CONDITIONS (CBR < 5) THE MATERIAL SHOULD BE EXCAVATED AND DISPOSED OF IN ACCORDANCE WITH THE WASTE MANAGEMENT ACT AND CLAUSE 804 MATERIAL IN ACCORDANCE WITH THE NATIONAL ROADS AUTHORITY SPECIFICATION FOR ROAD WORKS SHALL REPLACE THE EXCAVATED MATERIAL, WRAPPED IN GEO-TEXTILE WRAPPING. ALTERNATIVELY, SPECIAL PIPE SUPPORT ARRANGEMENTS, INCLUDING PILING ETC. MAY BE REQUIRED WHERE THE DEPTH OF SOFT MATERIAL IS EXCESSIVE. SUCH ARRANGEMENTS SHALL BE SUBJECT TO ASSESSMENT BY IRISH WATER BEFORE ADVANCING WITH THE WORK.
7. IN GREEN FIELD AREAS, TYPE B BACKFILL (SELECTED EXCAVATED MATERIAL) WILL BE ALLOWED ABOVE THE SIDE HAUNCH GRANULAR MATERIAL IN THE CASE OF RIGID PIPES. A GRANULAR SURROUND OF A MINIMUM DEPTH OF 150MM ABOVE THE CROWN OF THE PIPE IS REQUIRED FOR FLEXIBLE PIPES, AND TYPE B MATERIAL MAY BE USED AS BACKFILL ABOVE THIS. ALL RISING MAINS IN GREENFIELD AREAS SHALL HAVE A MINIMUM COVER OF 300mm OF GRANULAR MATERIAL ABOVE THE EXTERNAL CROWN OF THE PIPE.
8. PIPES SHALL NOT BE SUPPORTED ON STONES OR ROCKS, OR ANY HARD OBJECT AT ANY POINT ALONG THE TRENCH. ROCK SHALL BE EXCAVATED TO A DEPTH OF 150mm BELOW THE ACTUAL DEPTH OF THE TRENCH WITH THE VOID FILLED WITH CLAUSE 804 MATERIAL IN ACCORDANCE WITH THE NATIONAL ROADS AUTHORITY SPECIFICATION FOR ROAD WORKS. THE GRANULAR MATERIAL SHALL BE LAID ABOVE THIS VOID BACKFILL MATERIAL.
9. NON DEGRADABLE MARKER TAPE SHOULD BE INSTALLED 350mm FROM THE SURFACE OF THE ROAD. IN THE CASE OF NON METAL PIPE MATERIAL, THE MARKER TAPE SHOULD INCORPORATE A TRACE WIRE WHICH IS LINKED TO FITTINGS AND TERMINATED AT THE WASTE WATER PUMPING STATION AND THE DISCHARGE MANHOLE.
10. ALL DRAINAGE TO BE IN ACCORDANCE WITH IRISH WATER CODE OF PRACTICE FOR WASTE WATER INFRASTRUCTURE AND STANDARD DETAILS AND GREATER DUBLIN REGIONAL CODE OF PRACTICE.

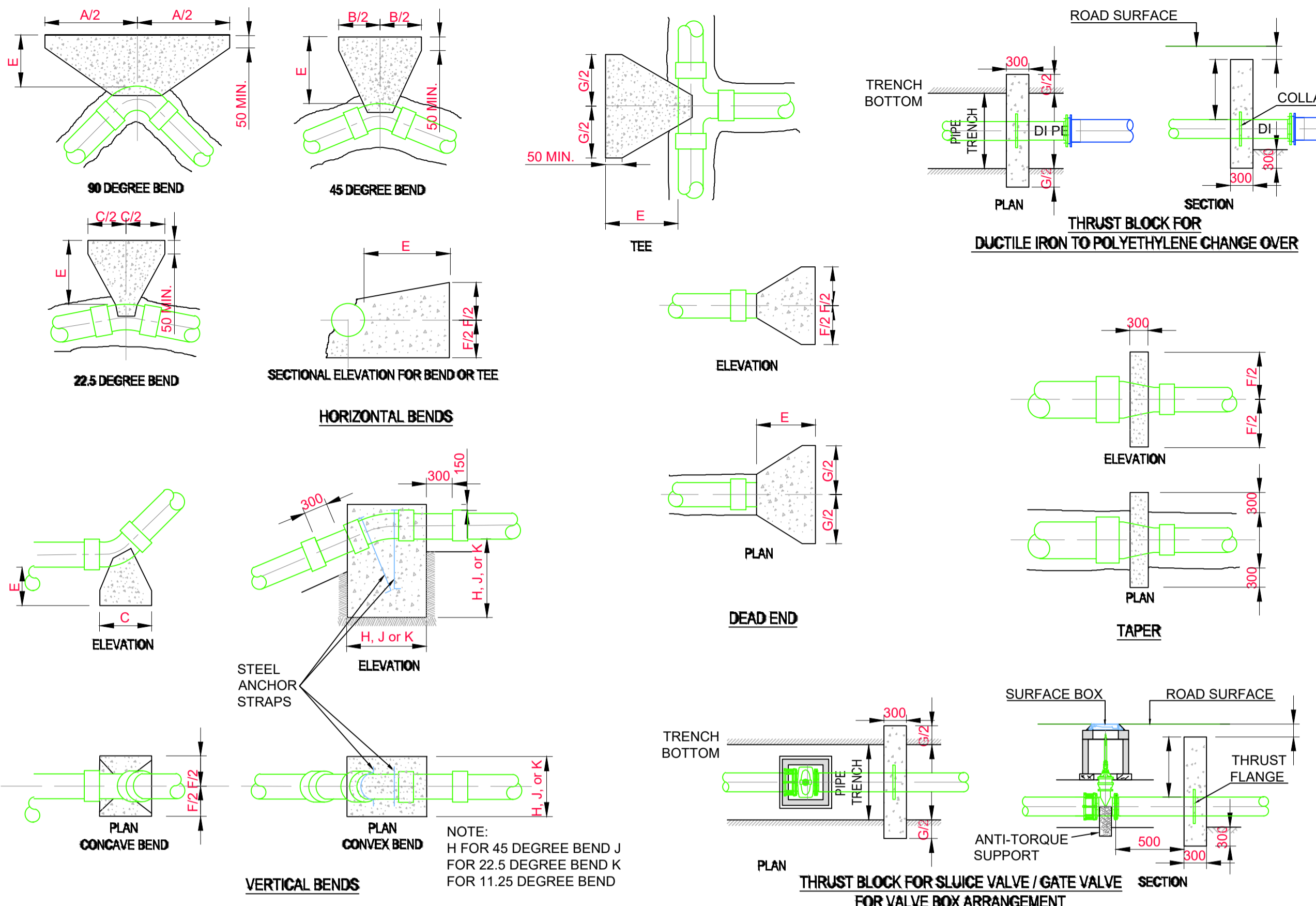

- 1. ALL DIMENSIONS IN MILLIMETRES (mm) UNLESS NOTED OTHERWISE.
2. CONCRETE THRUST BLOCKS (ANCHORAGE) SHALL BE POSITIONED SYMMETRICALLY WITH RESPECT TO THE CONNECTING PIPE & BENDS.
3. TRENCH DIMENSIONS - REFER TO DRAWING No's. STD-W-13.
4. THRUST BLOCKS SHALL BEAR ON UNDISTURBED SOIL. IF FOR ANY REASON THEY CANNOT THEN THE DEVELOPER SHALL NOTIFY IRISH WATER IMMEDIATELY WITH A PROPOSED SOLUTION.
5. THRUST BLOCK REINFORCEMENT REQUIRES SPECIFIC DESIGN.
6. FOR TEST PRESSURES GREATER THAN 18 BAR, THRUST BLOCK DESIGN IS TO BE SUBMITTED TO IRISH WATER FOR REVIEW.
7. THRUST BLOCKS ARE DESIGNED FOR AN AVERAGE BEARING PRESSURE OF 100 kN/m (TYPICAL FOR SOFT CLAY) FOR OTHER CONDITIONS. ACTUAL DIMENSIONS MAY BE ALTERED ON INSTRUCTIONS FROM IRISH WATER.
8. CONCRETE IN THRUST BLOCKS SHALL BE GRADE C20/25.
9. COMPRESSIBLE FILLER FOR CONCRETE PROTECTION TO BE IN ACCORDANCE WITH BS EN 622-1 AND BS EN 622-4. BITUMINOUS MATERIAL SHALL NOT BE PUT IN CONTACT WITH PLASTIC PIPES. THE THICKNESS OF COMPRESSIBLE FILLER FOR MAINS < 450mm IN DIAMETER IS TO BE 18mm.
10. CONCRETE THRUST BLOCKS FOR POLYETHYLENE PIPE TO COMPLY WITH THE MANUFACTURERS REQUIREMENTS.
11. POLYETHYLENE PIPES SHALL BE WRAPPED IN PLASTIC SHEETING HAVING A COMPOSITION IN ACCORDANCE WITH BS 6076 BEFORE BEING CAST INTO CONCRETE.
12. ALL CONCRETE TO BE IN ACCORDANCE WITH IS EN 206.

TABLE OF DIMENSIONS FOR STEEPLY INCLINED PIPELINES. Table with columns for Gradient and Spacing, showing values for 1 in 2 & steeper, below 1 in 2 to 1 in 4, 1 in 4 to 1 in 5, and 1 in 5 to 1 in 6.

12 BAR TEST PRESSURE DIMENSIONS table. Columns: NOM. DIA. (mm), A, B, C, D, E, F, G, H, J, K. Values range from 100 to 150 mm diameter.

12 BAR TO 15 BAR TEST PRESSURE DIMENSIONS table. Columns: NOM. DIA. (mm), A, B, C, D, E, F, G, H, J, K. Values range from 100 to 150 mm diameter.

15 BAR TO 18 BAR TEST PRESSURE DIMENSIONS table. Columns: NOM. DIA. (mm), A, B, C, D, E, F, G, H, J, K. Values range from 100 to 150 mm diameter.

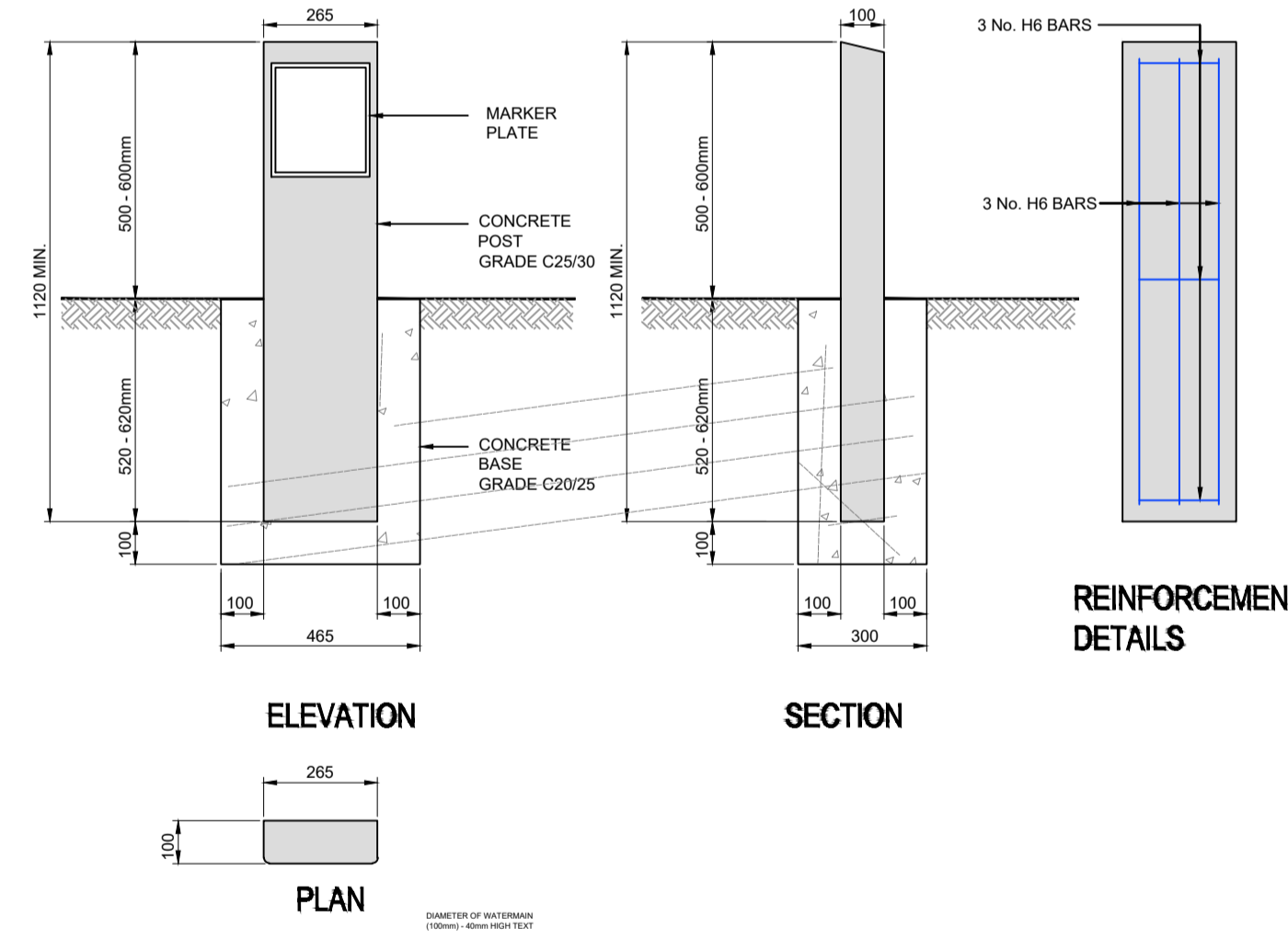
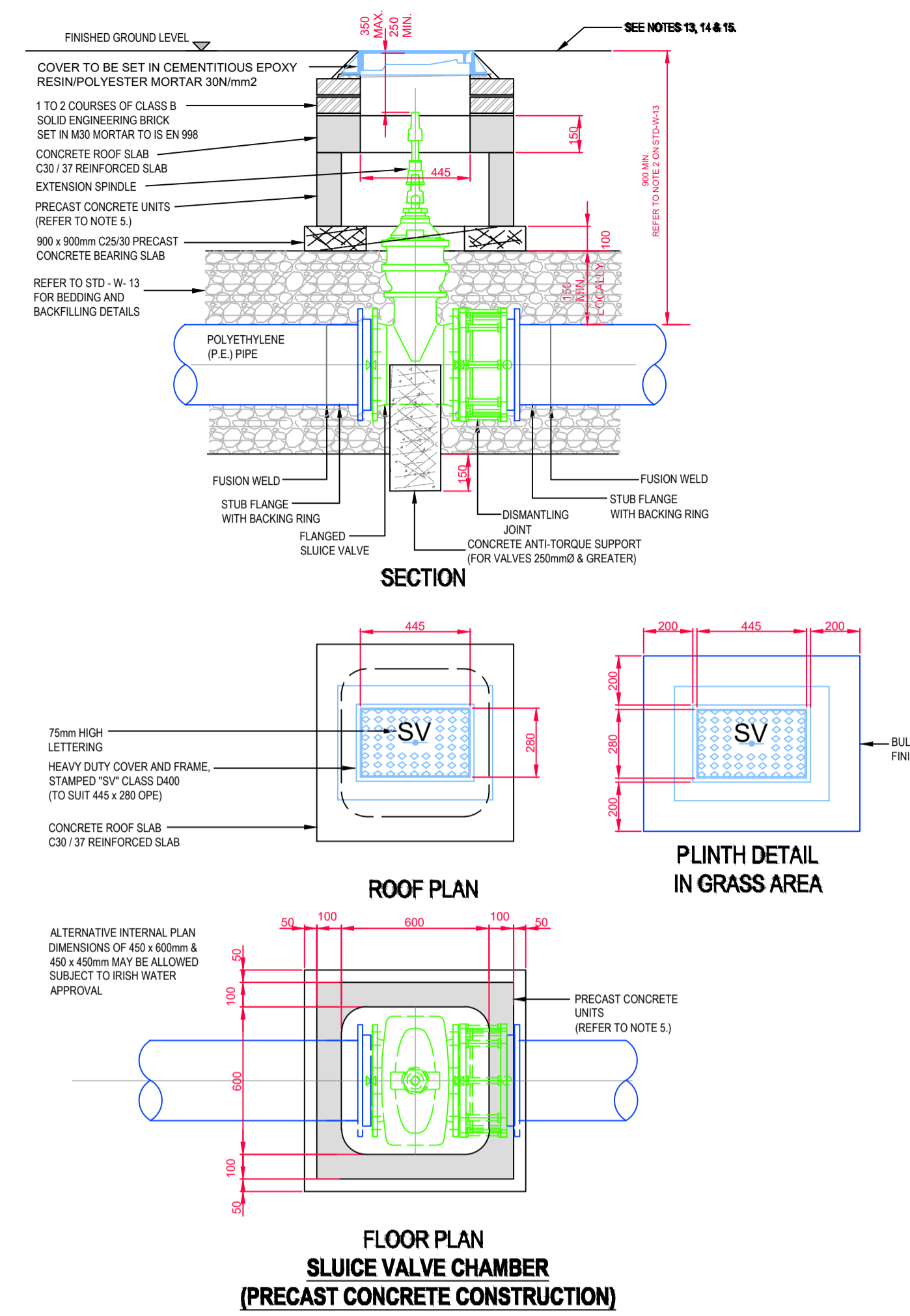

- 1. WHERE PRACTICAL MARKER PLATES SHALL BE FIXED TO ADJACENT WALLS OR ALTERNATIVELY ATTACHED TO MARKER POSTS.
2. PLASTER THICKNESS IN POSITION USING WALL PLASTER AND STAINLESS STEEL SCREWS.
3. MARKER PLATES TO BE MANUFACTURED IN ACCORDANCE WITH BS 8832.
4. FOR HYDRANT PLATE, CHAIN PIPES SHALL BE BLACK AND THE REMAINDER OF THE FRONT FACE SHALL BE POLISHED TO A GLOSS FINISH.
5. PIPE DIAMETER IN HYDRANT PLATE TO MATCH TO WATER MAIN NOT DRIVEN.
6. SLUIZE VALVE, AIR VALVE, SOUVALVE, AND AIR VALVE HYDRANT, ETC. SHALL BE SET ALUMINUM AL COINTEGRATED TO THE SURFACE. WHITE PRIME BAKERSMITH ALTERNATIVE MATERIAL MAY BE USED SUBJECT TO APPROVAL BY IRISH WATER.
7. CONCRETE MARKER POST TO BE GRADE C20/25 AND IN ACCORDANCE WITH BS 8832.
8. CONCRETE BASE TO BE GRADE C20/25.
9. PLASTER MARKER SURFACE NOT ACCEPTABLE.
10. PAINTING SPECIFICATION: 2 PACK EPOXY PRIMER @ 40 MICRONS FOLLOWED BY 2 PACK HIGH GLOSS POLYURETHANE TOP COAT APPLIED AT @ 40 MICRONS.
11. REFERENCES TO PIPE DIMENSIONS ON MARKER PLATES REFER SPECIFICALLY TO THE NOMINAL INTERNAL DIAMETER OF THE PIPE UNLESS OTHERWISE STATED.

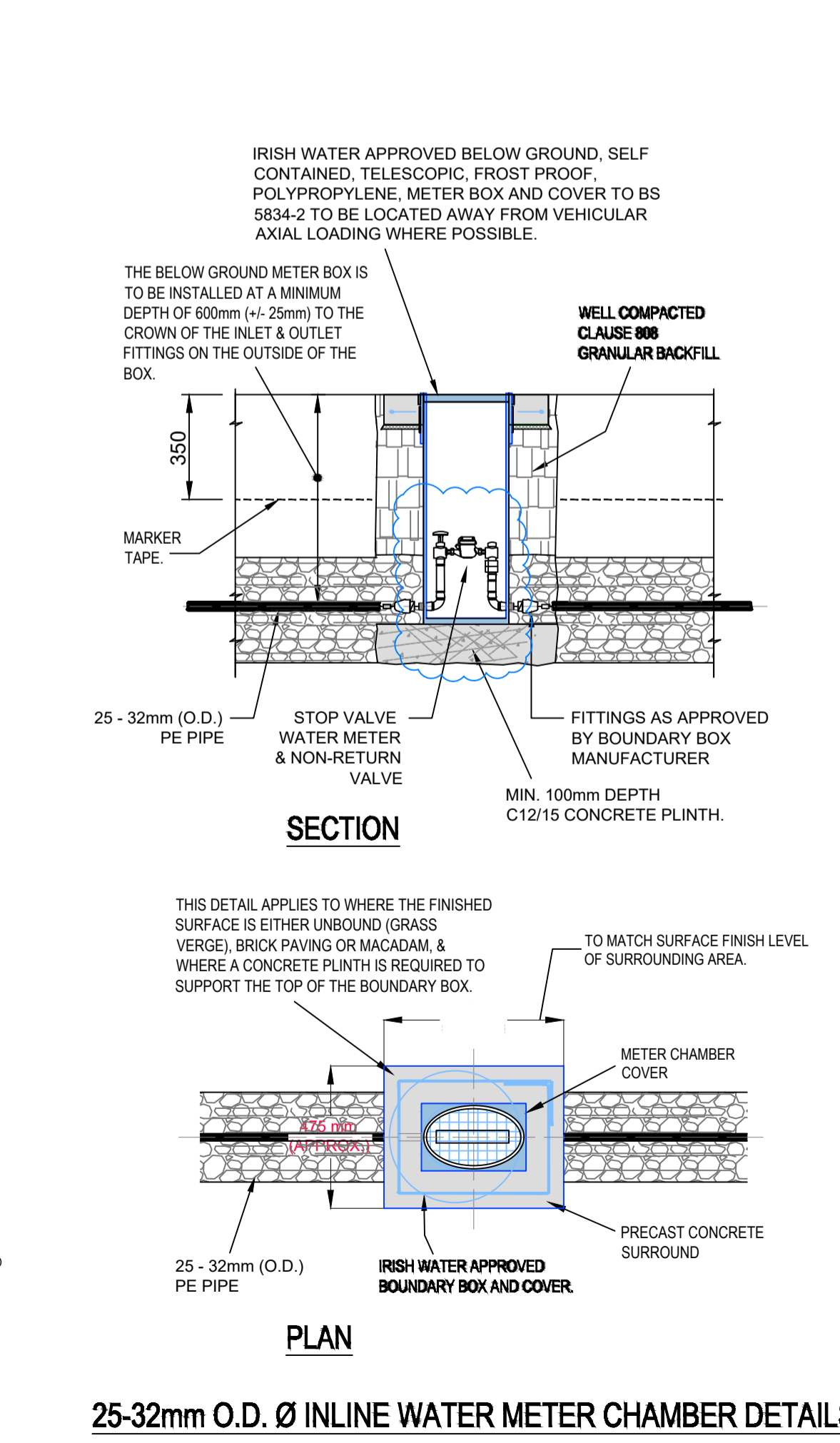
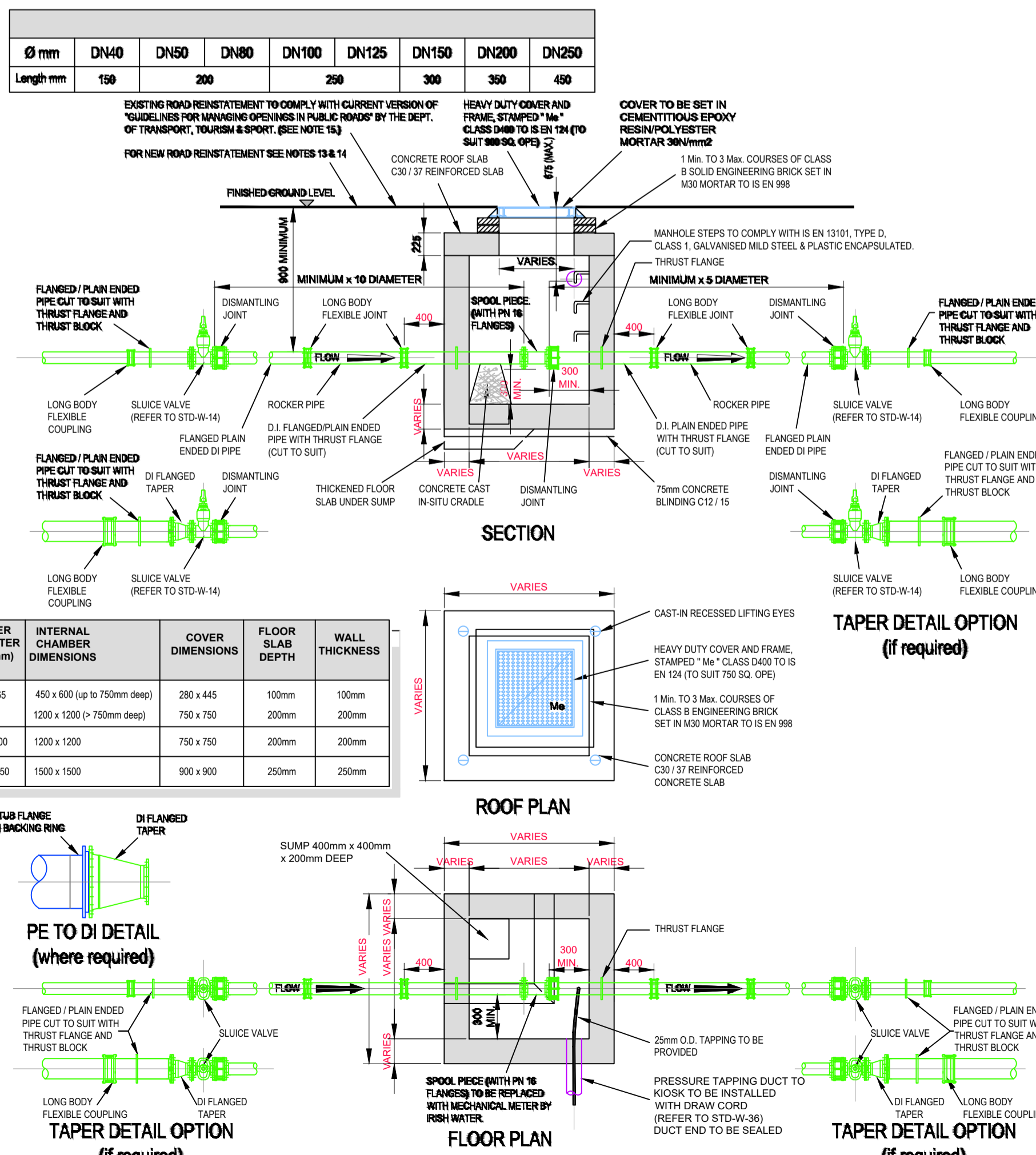
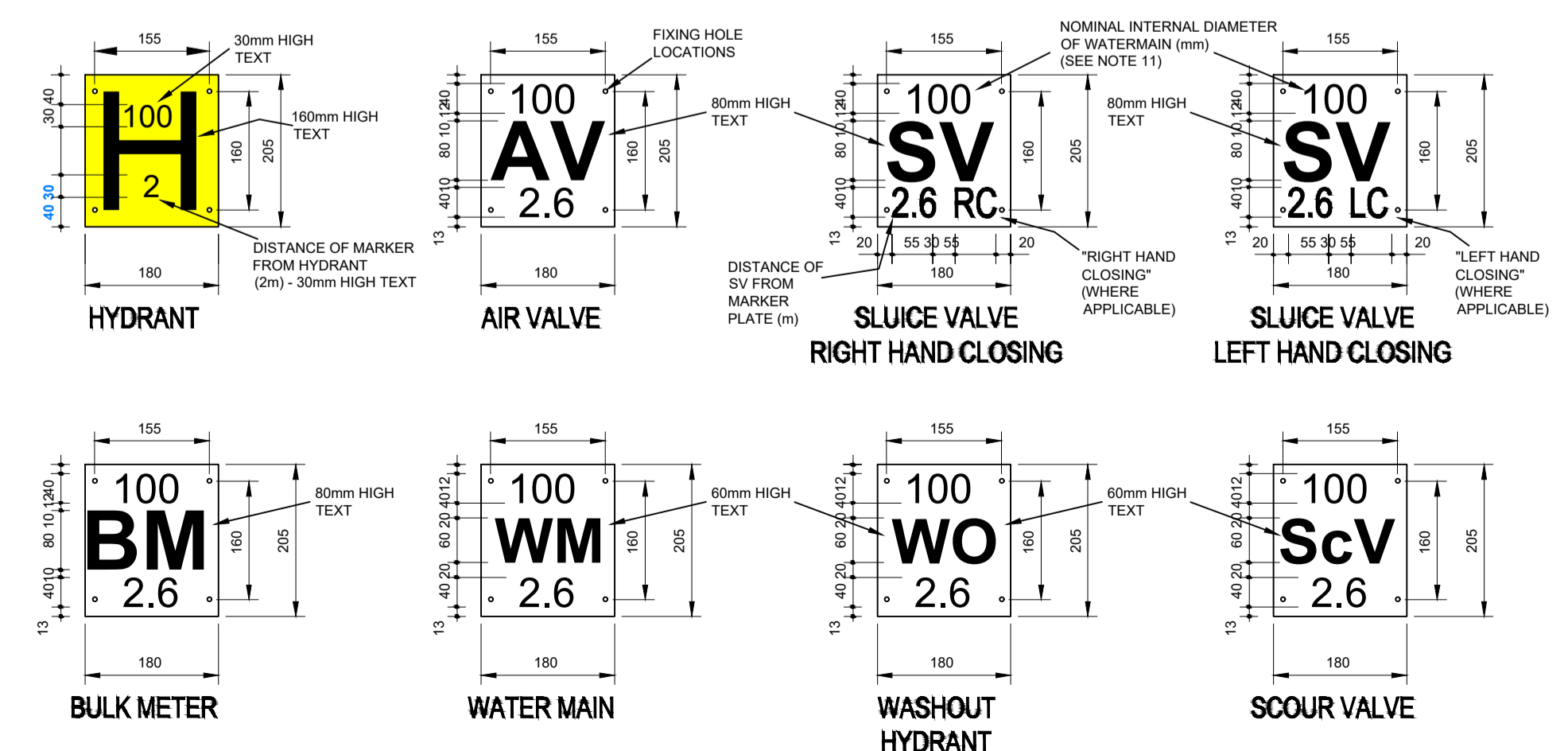

00 ISSUED FOR PLANNING (PART B) 12.07.24 JD CC
REV DESCRIPTION DATE BY CHK
STATUS P3 - ISSUED FOR PLANNING
MOR MALONE O'REGAN CONSULTING ENGINEERS Unit 2B Richview Office Park, Clonskeagh, DUBLIN 14
OFFICES also in: GALWAY T: +353 91 531 069 E: galway@mor.ie
WATERFORD T: +353 51 876 855 E: waterford@mor.ie
CLIENT NATIONAL DEVELOPMENT FINANCE AGENCY AND DUBLIN CITY COUNCIL
JOB NAME SOCIAL HOUSING BUNDLE 4, DEVELOPMENT AT CROKE VILLAS, SACKVILLE AVENUE.
JOB NAME SITE DEVELOPMENT DETAILS SHEET 3 WATERMAIN DETAILS
JOB REF SHEET SCALE DATE BY ENG APP REV.
23006 A1 As Shown OCT 2023 JD CC COB 00
DRG. NO. SHB4-CVD-DR-MOR-CS-P3-147