

**DATE:** 5 March 2024  
**DESIGNER:** Daniel McDonnell  
**PROJECT No:** 2972  
**PROJECT NAME:** Development at the Church of the Annunciation

**LIGHTING  
REALITY**

## **Social Housing Bundle 4**

## Layout Report

### General Data

Dimensions in Metres Angles in Degrees

### Calculation Grids

ID	Grid Name	X	Y	X' Length	Y' Length	X' Spacing	Y' Spacing
1	Development at Church of t...	-73.85	42.41	107.85	81.77	1.50	1.49
2	Apartment Courtyard/Square	-26.66	62.85	37.75	33.37	1.45	1.45
3	Car Parking Area	-63.79	105.90	60.20	17.70	1.47	1.47

### Luminaires

#### Luminaire A Data



Supplier	Urbis Schreder
Type	FLEXIA TOP 5304 Deep shape PC 20 LH351C@300mA NW 740 230V
Lamp(s)	20 LH351C@300mA NW 740 230V
LampFlux(klm)/Colour	2.79 NW 4000K/70
File Name	FLEXIA TOP 5304 20 LH351C 300mA NW 740 19.6W 445412 Deep shape PC 230V TF.ltd
Maintenance Factor	0.84
Imax70,80,90(cd/klm)	329.1, 124.0, 39.1
No. in Project	7

#### Luminaire B Data



Supplier	Urbis Schreder
Type	AXIA 2.1 5167 Integrated lenses 16 OSOLON SQUARE GIANT@760mA
Lamp(s)	16 OSOLON SQUARE GIANT@760mA NW 740 230V 00-36-648
LampFlux(klm)/Colour	5.20 NW 4000K/70
File Name	AXIA 2.1 5167 16 OSOLON SQUARE GIANT 760mA NW 740 39W 434362 Integrated lens...
Maintenance Factor	0.84
Imax70,80,90(cd/klm)	1162.3, 202.9, 3.0
No. in Project	3

#### Luminaire C Data



Supplier	Urbis Schreder
Type	AXIA 2.1 5167 Integrated lenses 16 OSOLON SQUARE GIANT@400mA
Lamp(s)	16 OSOLON SQUARE GIANT@400mA NW 740 230V 00-36-648
LampFlux(klm)/Colour	3.00 NW 4000K/70
File Name	AXIA 2.1 5167 16 OSOLON SQUARE GIANT 400mA NW 740 21W 434362 Integrated lens...
Maintenance Factor	0.84
Imax70,80,90(cd/klm)	1162.3, 202.9, 3.0
No. in Project	9

### Layout

ID	Type	X	Y	Height	Angle	Tilt	Cant	Out-reach	Dimmed to	Target X	Target Y	Target Z
1	A	-20.88	89.50	6.00	0.00	0.00	0.00	0.00	100%			
2	B	-13.51	120.97	6.00	269.00	0.00	0.00	0.60	80%			
3	B	-34.64	122.15	6.00	266.00	0.00	0.00	0.60	80%			
4	B	-58.62	123.09	6.00	269.00	0.00	0.00	0.60	80%			
5	A	0.87	78.34	6.00	0.00	0.00	0.00	0.00	100%			
7	A	-15.68	70.10	6.00	0.00	0.00	0.00	0.00	100%			
8	C	3.37	106.12	6.00	89.00	0.00	0.00	0.40	100%			
9	C	27.43	109.63	6.00	268.00	0.00	0.00	0.40	100%			

**Layout Continued**

ID	Type	X	Y	Height	Angle	Tilt	Cant	Out-reach	Dimmed to	Target X	Target Y	Target Z
10	C	23.31	94.44	6.00	0.00	0.00	0.00	0.60	100%			
11	C	22.35	64.62	6.00	358.00	0.00	0.00	0.40	100%			
12	C	8.80	50.79	6.00	266.00	0.00	0.00	0.60	100%			
13	C	-27.88	52.12	6.00	269.00	0.00	0.00	0.60	100%			
14	A	-57.39	79.61	6.00	270.00	0.00	0.00	0.00	80%			
15	C	28.50	48.18	6.00	146.00	0.00	0.00	0.60	100%			
15	A	-50.30	63.10	6.00	180.00	0.00	0.00	0.00	85%			
16	C	-54.64	105.21	6.00	87.00	0.00	0.00	0.60	85%			
18	A	-55.03	96.98	6.00	270.00	0.00	0.00	0.00	80%			
19	C	-25.44	107.33	6.00	267.00	0.00	0.00	0.60	80%			
19	A	-62.10	55.74	6.00	270.00	0.00	0.00	0.00	85%			

# Horizontal Illuminance (lux)

Development at Church of the Annunciation

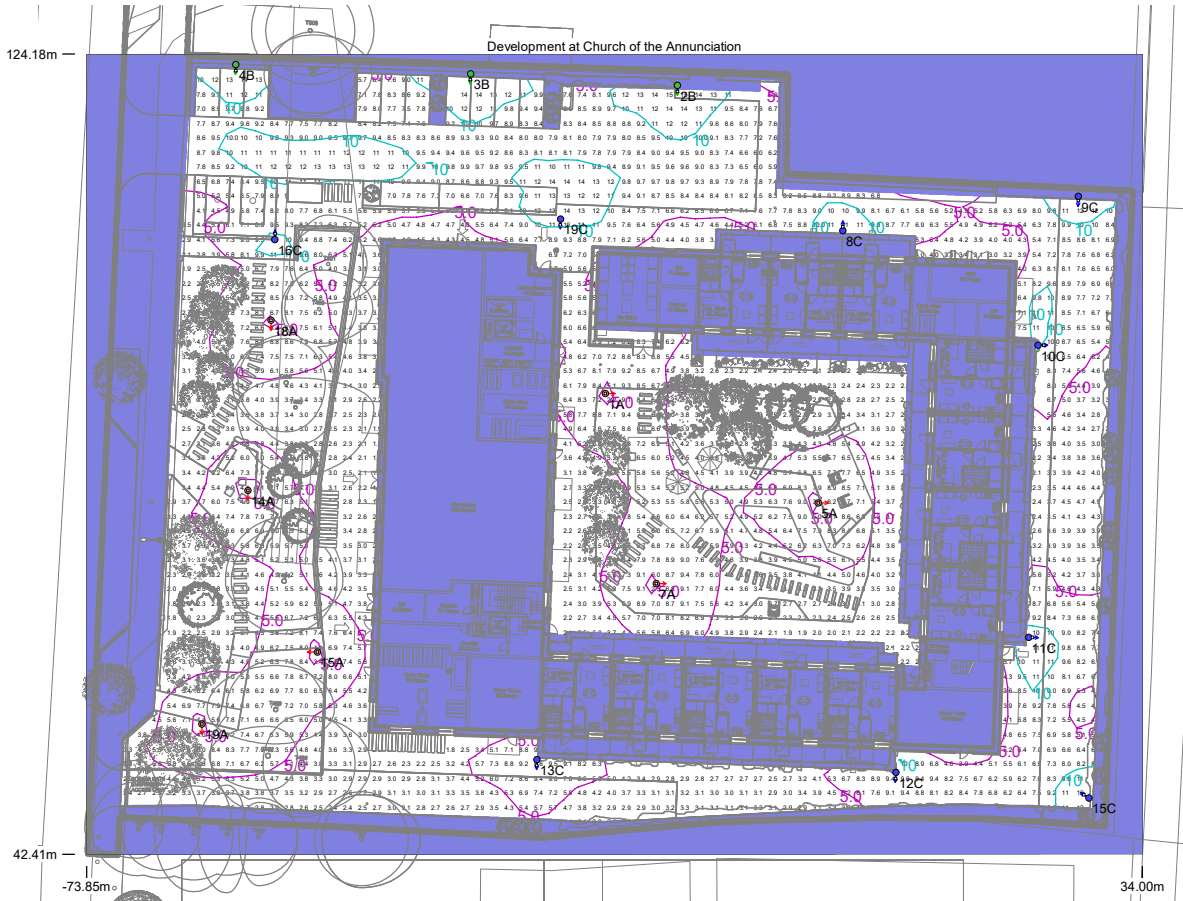

## Results

Eav	5.85
Emin	1.45
Emax	14.59
Emin/Emax	0.10
Emin/Eav	0.25

## Horizontal Illuminance (lux)

Apartment Courtyard/Square

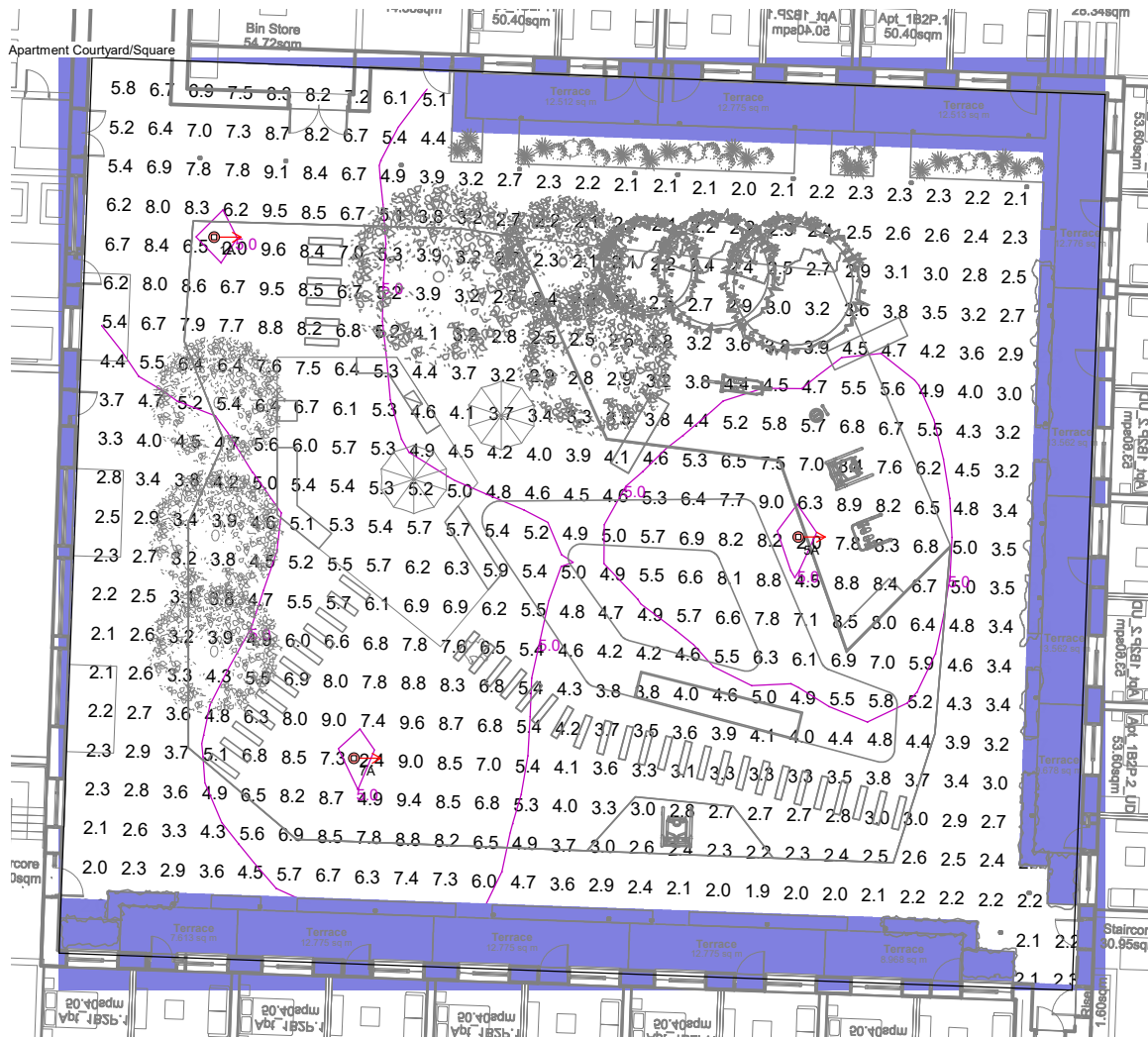

### Results

Eav	4.72
Emin	1.91
Emax	9.59
Emin/Emax	0.20
Emin/Eav	0.40

## Horizontal Illuminance (lux)

### Car Parking Area

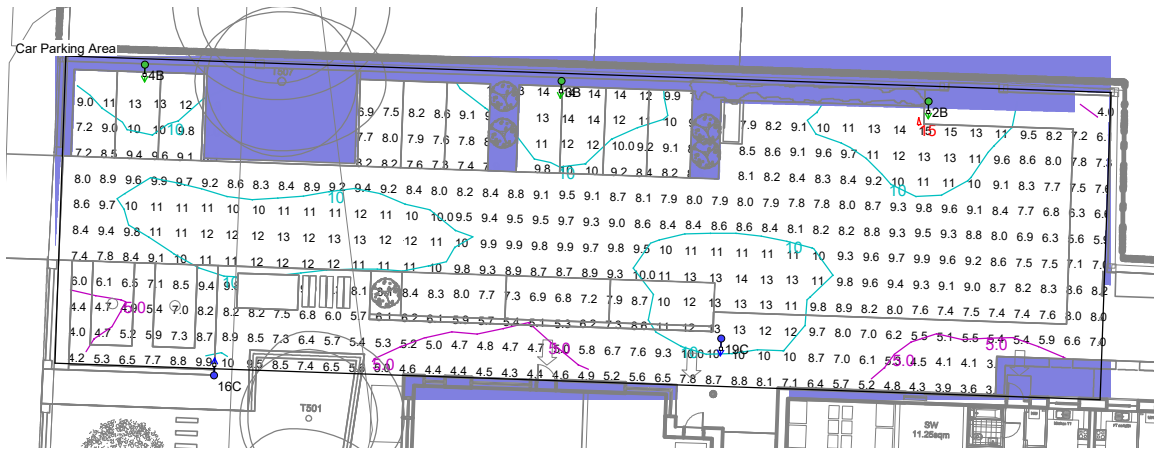

### Results

Eav	8.72
Emin	3.24
Emax	15.04
Emin/Emax	0.22
Emin/Eav	0.37