

1 Cycle Store Layout 1
Scale: 1:50

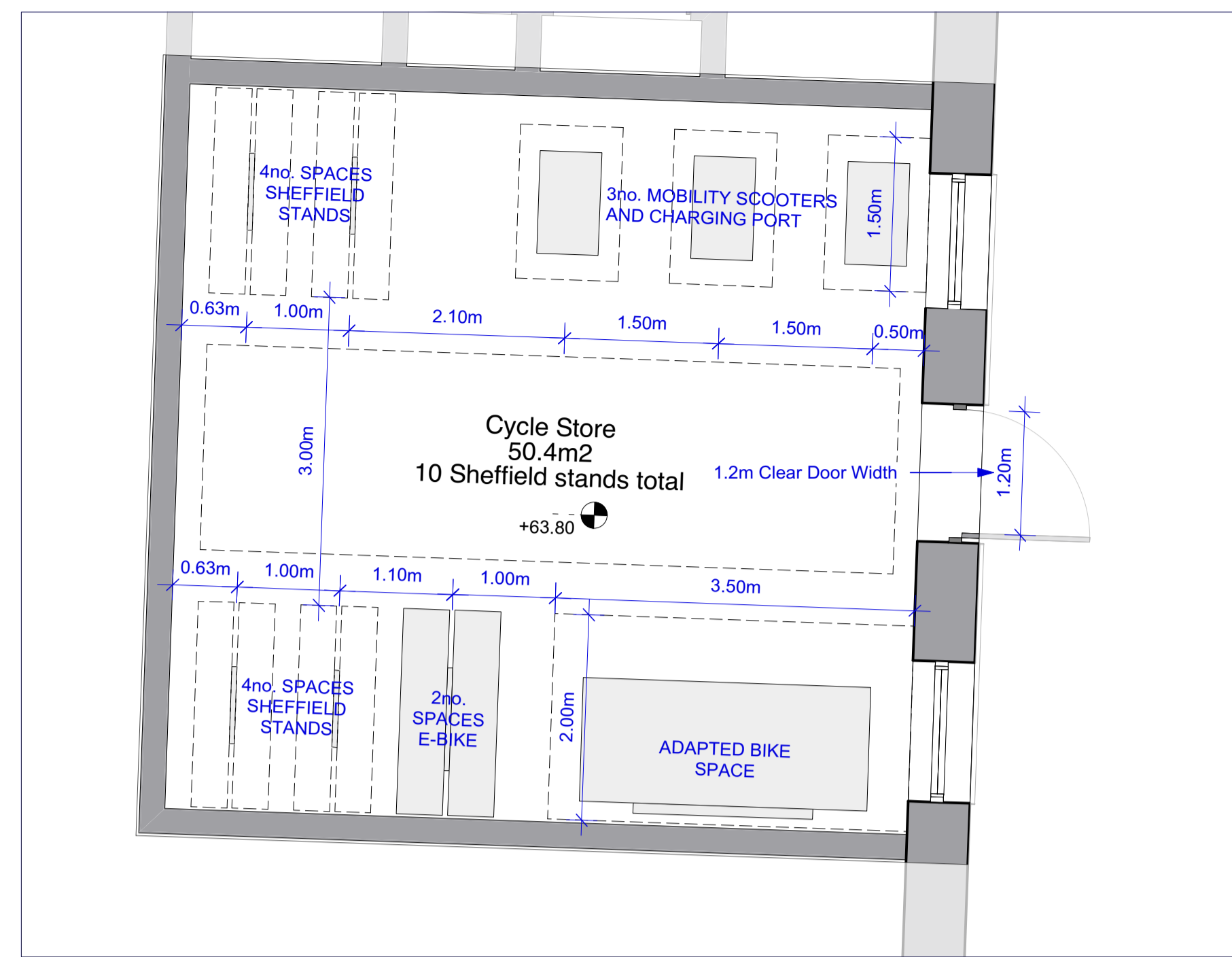

2 Cycle Store Layout 2
Scale: 1:50

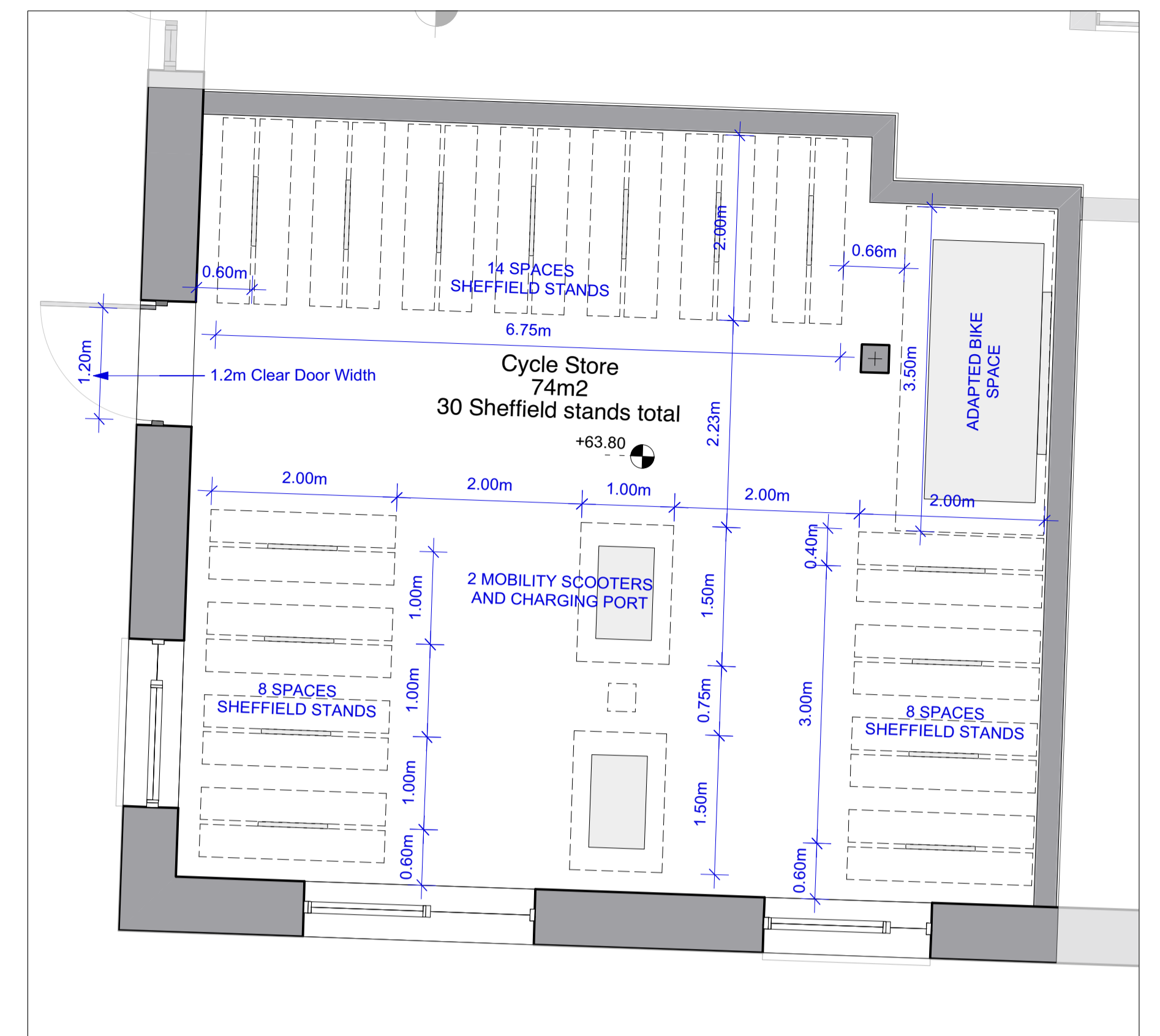

3 Cycle Store Layout 3
Scale: 1:50



4 Proposed Site Plan - Cycle Infrastructure
Scale: NTS

Legend - Planning

- Planning Application Extents
- North Point
- Long term - Residential Secure Parking
- Adapted Bike - Long term - Residential Parking
- Sheffield Stands - Long term - Residential Parking
- Mobility Scooter - Long term - Residential Parking
- E-Bike - Long term - Residential Parking
- Sheffield Stands - Short term - Visitor Parking
- Adapted bike - Short term - Visitor Parking
- Motorcycle - Short term - Visitor Parking

Cycle Parking	Total Apts	Load	Long term Required	Short term Required	of which adapted req.	Long term Delivered	Short term Delivered	of which adapted del.
<i>For below, load based on number of residents</i>								
1B2P Apartments (Seniors)	106	212	42	21	2	45	29	2
2B3P Apartments (Seniors)	4	12	2	1	0	4	1	0
Housing staff (Seniors)		0	0					
<i>For below, load based on number of bedrooms</i>								
1B2P Apartments (General)	0	0	0	0	0			
2B3P Apartments (General)	0	0	0	0	0			
3B5P Apartments (General)	0	0	0	0	0			
<i>For below, load based on total area in m2</i>								
Community, Arts & Culture	434	1	4	0		1	4	1
Retail	0	0	0	0	0			
<i>For below, load based on total number of staff/children</i>								
Creche	0	0	0	0	0			
Total numbers			46	27	2	50	34	3

Use figure dimensions only. Do not scale drawings. Read in conjunction with specification and consultants drawings. Report any discrepancies in drawings to Architect before putting work in hand. Check all dimensions on site. This drawing is the copyright of Sean Harrington Architects, and may not be reproduced, in whole or part, without prior agreement.

REV: 001
R01: Planning Draw, final publish.
R02: Pre-Plan Submission.
R03: Red Line Building Update, finalising request.
R04: Revised layout and quantum.

DATE: 26/01/24
14/05/24
26/05/24
05/06/24

SEÁN HARRINGTON ARCHITECTS
3rd Floor
121/122 Capel Street
Dublin 1, Ireland
t: 01 872 422
e: info@shar.ie

PROJECT: Social Housing Bundle 4, Development at Church of the Annunciation, Finglas
CLIENT: Dublin City Council
DRAWING NO: SHB4-CAF-DR-SHA-AR-P3-0006

Proposed Bike Storage / Cycle Infrastructure
SCALE: varies
DATE: MAY '24
DRAWN BY: BC
CHECKED BY: RG

REV: 001
R04