

NO PART OF THIS DRAWING MAY BE REPRODUCED OR TRANSMITTED IN ANY FORM OR STORED IN ANY RETRIEVAL SYSTEM OF ANY NATURE WITHOUT THE WRITTEN PERMISSION OF MALONE O'REGAN CONSULTING ENGINEERS AS COPYRIGHT HOLDER EXCEPT AS AGREED FOR USE ON THE PROJECT FOR WHICH THE DRAWING WAS ORIGINALLY CREATED.

THIS DRAWING TO BE READ IN CONJUNCTION WITH ALL OTHER RELEVANT DRAWINGS, SPECIFICATIONS AND THE PRELIMINARY HEALTH & SAFETY PLAN.

ALL DIMENSIONS ARE IN mm UNLESS NOTED OTHERWISE. DO NOT SCALE DIMENSIONS.

THE CONTRACTOR SHALL CHECK ALL DIMENSIONS PRIOR TO THE COMMENCEMENT OF CONSTRUCTION. ALL DISCREPANCIES SHALL BE REPORTED TO THIS OFFICE IN WRITING.

NOTES

BY	DRAWING No. & REFERENCE	DATE
SURVEY		
ARCH	SHB4-CAF-DR-MOR-CS-P1-0008 R03	30.05.24
LS ARCH	SHB4-CAF-DR-MOR-CS-P1-0001-P07	28.02.24

LEGEND

- EXISTING SURFACE DRAINAGE LINE
- EXISTING SURFACE MANHOLE
- EXSW AJ EXISTING SURFACE ARMSTRONG JUNCTION
- EXISTING SURFACE ROAD GULLY
- - - PROPOSED SURFACE DRAINAGE LINE
- PROPOSED SURFACE MANHOLE
- PERMEABLE PAVING UNDERDRAIN 150#
- ▨ PERMEABLE PAVING
- STANDARD ROOF
- BLUE ROOF OVER 85% OF ROOF AREA
- ▨ PROPOSED GRASSCRETE HARDSCAPE

DRAINAGE NOTES

- ALL DRAINAGE INFRASTRUCTURE TO BE CONSTRUCTED IN ACCORDANCE WITH THE GREATER DUBLIN REGIONAL CODE OF PRACTICE FOR DRAINAGE WORKS.
- WHERE INFORMATION CONTAINED WITHIN THE CODE OF PRACTICE CONFLICTS WITH OTHER NOTES ON THIS DRAWING, THE CONTRACTOR SHALL ADHERE TO THE REQUIREMENTS OF THE CODE OF PRACTICE.

ATTENUATION ZONE (SHOWN IN GREEN OUTLINE)
 ATTENUATION PROVIDED BY STONE FILL UNDER PERMEABLE PAVING (30% STONE VOID RATIO ASSUMED) REFER TO DWG. 151 FOR PERMEABLE PAVING DETAIL

PROPOSED ATTENUATION ZONE INFORMATION

LEVELS CHECK
 LOWEST FFL = 63.350m; 500mm FREEBOARD = 62.850m
 LOWEST ROAD LEVEL = 62.100m; 300mm FREEBOARD = 61.800m
 LET THE 1:100 YR WATER LEVEL = 61.800m
 PERFORATED PIPE INVERT LEVEL = 61.650m

ATTENUATION VOLUME REQUIRED = 119.782m³
 ATTENUATION ZONE AREA = 530.420m²
 VOID RATIO = 30%
 ATTENUATION STORAGE DEPTH = (119.782m³/530.420m²)/30% = 0.753m (SAY 0.760m)

Park

GREEN/BLUE ROOF ATTENUATION VOLUME
 GREEN/BLUE ROOF AREA = 1470.50m²
 STORAGE LAYER = 0.1m DEEP
 VOID RATIO = 95%
 STORAGE VOLUME PROVIDED = 139.698m³
 STORAGE VOLUME REQUIRED = 20.414m³

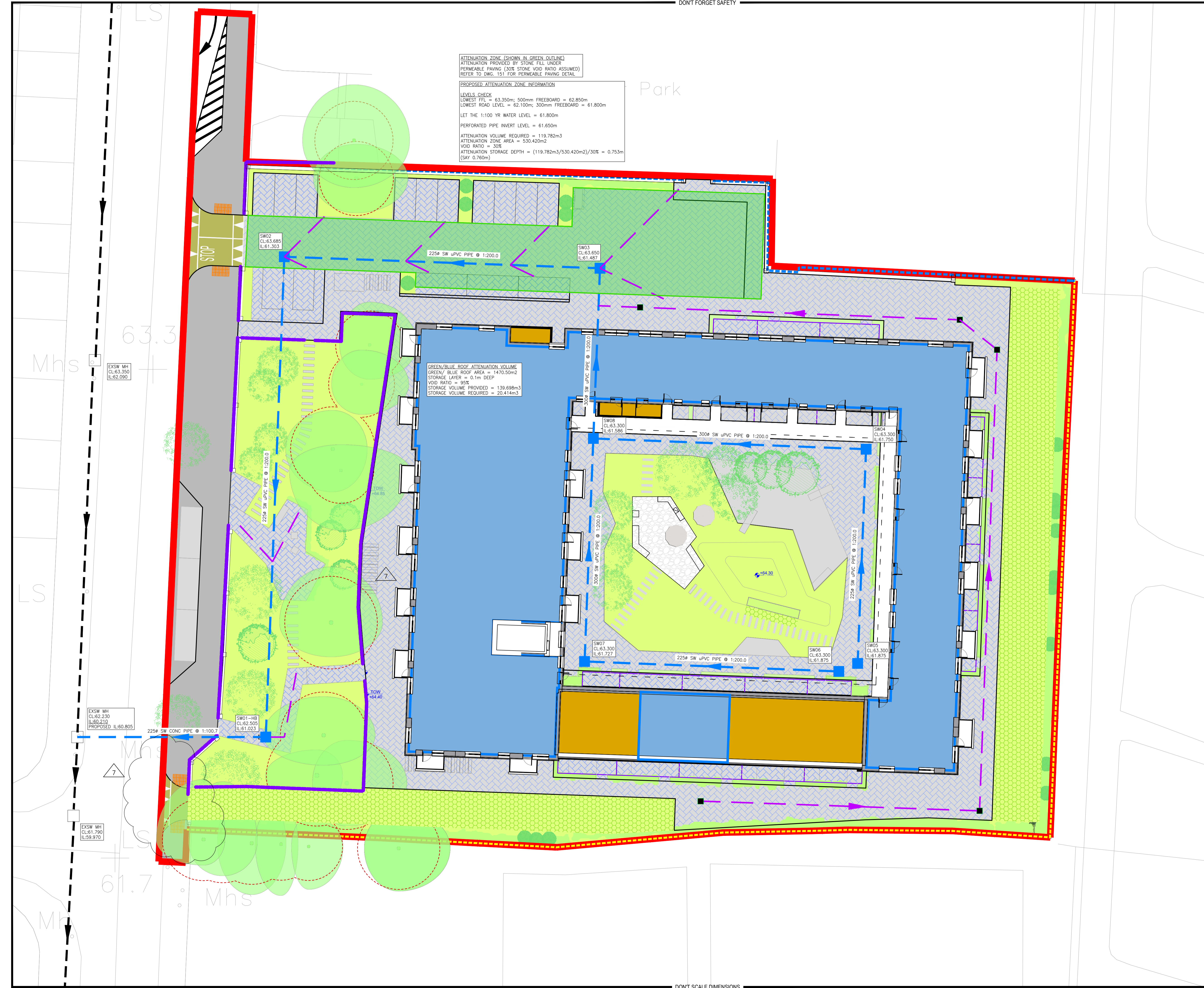

REV	DESCRIPTION	DATE	BY	CHK
9	UPDATED ARCHITECT LAYOUT	13.06.24	DK	ND
8	UPDATED ARCHITECT LAYOUT	06.06.24	DK	ND
7	BLUE/GREEN ROOFS REVISED AND PEDESTRIAN CROSSING REMOVED AND EXIT JUNCTION UPDATED	12.04.24	KD	ND
6	GREEN/BLUE ROOF REVISED AS PER ARCHITECT LATEST LAYOUT	02.04.24	KA	PB
5	ROAD CROSSING REMOVED AND REDLINE BOUNDARY REVISED AS PER ARCHITECT LATEST LAYOUT	26.03.24	KD	PB
4	REVISED AS PER REV CLOUD: PERFORATED PIPE REMOVED	01.03.24	KA	PB
3	ATTENUATION ZONE OUTLINE AMENDED	29.02.24	KA	PB
2	REVISED AS PER NEW SITE LAYOUT	28.02.24	KA	PB
1	SURFACE DRAINAGE RE-ROUTED PERMEABLE PAVING ATTENUATION ZONE AMENDED	23.01.24	KA	PB
0	ISSUED FOR INFORMATION	16.01.24	KA	PB

STATUS: P3 - PLANNING

ADR
 MALONE O'REGAN
 CONSULTING ENGINEERS

Unit 2B Richview Office Park,
 Clonskeagh,
 DUBLIN 14
 D14 XT57

T: +353 1 260 2655
 E: dublin@morco.ie
 W: www.maloneoregan.ie

Offices also in:
 GALWAY T: +353 91 531 069 E: galway@morco.ie
 WATERFORD T: +353 51 876 855 E: waterford@morco.ie

CLIENT: NDFA

JOB NAME: CHURCH OF THE ANNUNCIATION

DRG NAME: SUDS LAYOUT

JOB REF	SHEET	SCALE	DATE	BY	ENG	APP	REV.
23006	A1	1:200	SEPT'2023	KA	KA	PB	9

DRG NO: SHB4-CAF-DR-MOR-CS-P1-150