

1 Floor Plan - Level +0
Scale: 1:100

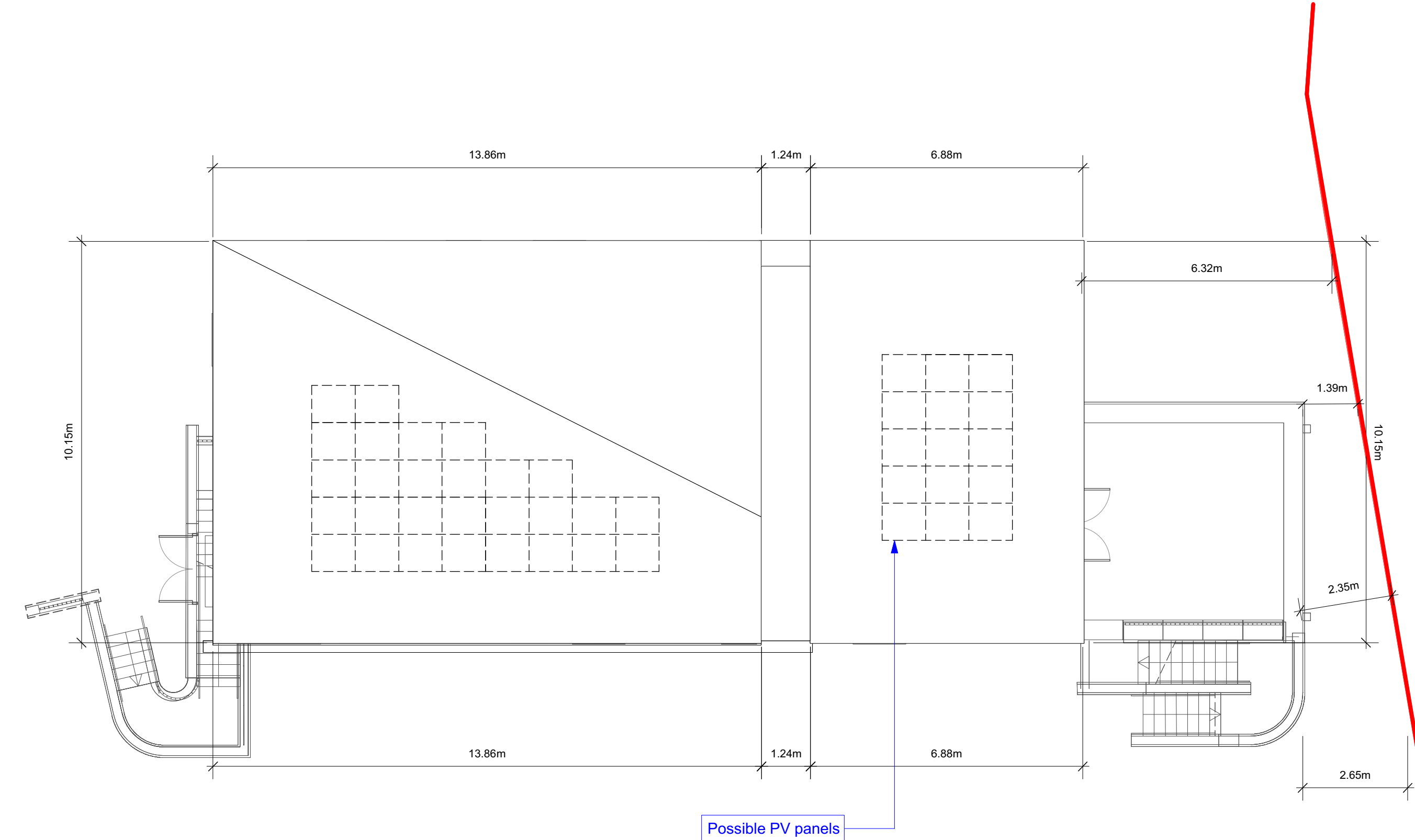

2 Floor Plan - Level +1
Scale: 1:100



3 Floor Plan - Level +2
Scale: 1:100

Legend - Apartment/Dwelling typologies

- 1B2P (1 bed, 2 person) apartment
- 2B3P (2 bed, 3 person) apartment
- 2B4P (2 bed, 4 person) dwelling / apartment
- 3B5P (3 bed, 5 person) dwelling
- 3B6P (3 bed, 6 person) dwelling
- 4B7P (4 bed, 7 person) dwelling

Refer to SHB3-BAL-AR-COA-DR-0100, 0101 and 0102 for detailed apartment and duplex layouts, Refer to SHB3-BAL-AR-COA-DR-0110, 0111, 0112 & 0113 for detailed dwelling layouts, including individual room areas, critical dimensions, area schedules and furniture layouts

Refer to SHB3-BAL-AR-COA-DR-0200 for the Housing Quality Assessment

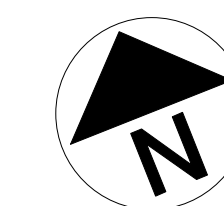

Use figured dimensions only. Do not scale drawings. Read in conjunction with specification and operational drawings. Report any discrepancies in drawings to Architect before setting work in hand. Check all dimensions on site. This drawing is the copyright of Seán Harrington Architects, and may not be reproduced, in whole or part, without prior agreement.		SEÁN HARRINGTON ARCHITECTS 3rd Floor, 12/122 Capel Street, Dublin 1, Ireland T: 01 8733 422 E: info@shba.ie	
PROJECT: Social Housing Bundle 3 - Residential Development at Shangan Road, Ballymun CLIENT: Dublin County Council	DRAWN BY: AR CHECKED BY: RG	DATE: 18/12/21 SCALE: 1/100 TITLE: Dec'21	PROJECT NO: SHB3-BAL-AR-COA-DR-0060 DRAWING NO: P03