

# AREA 5

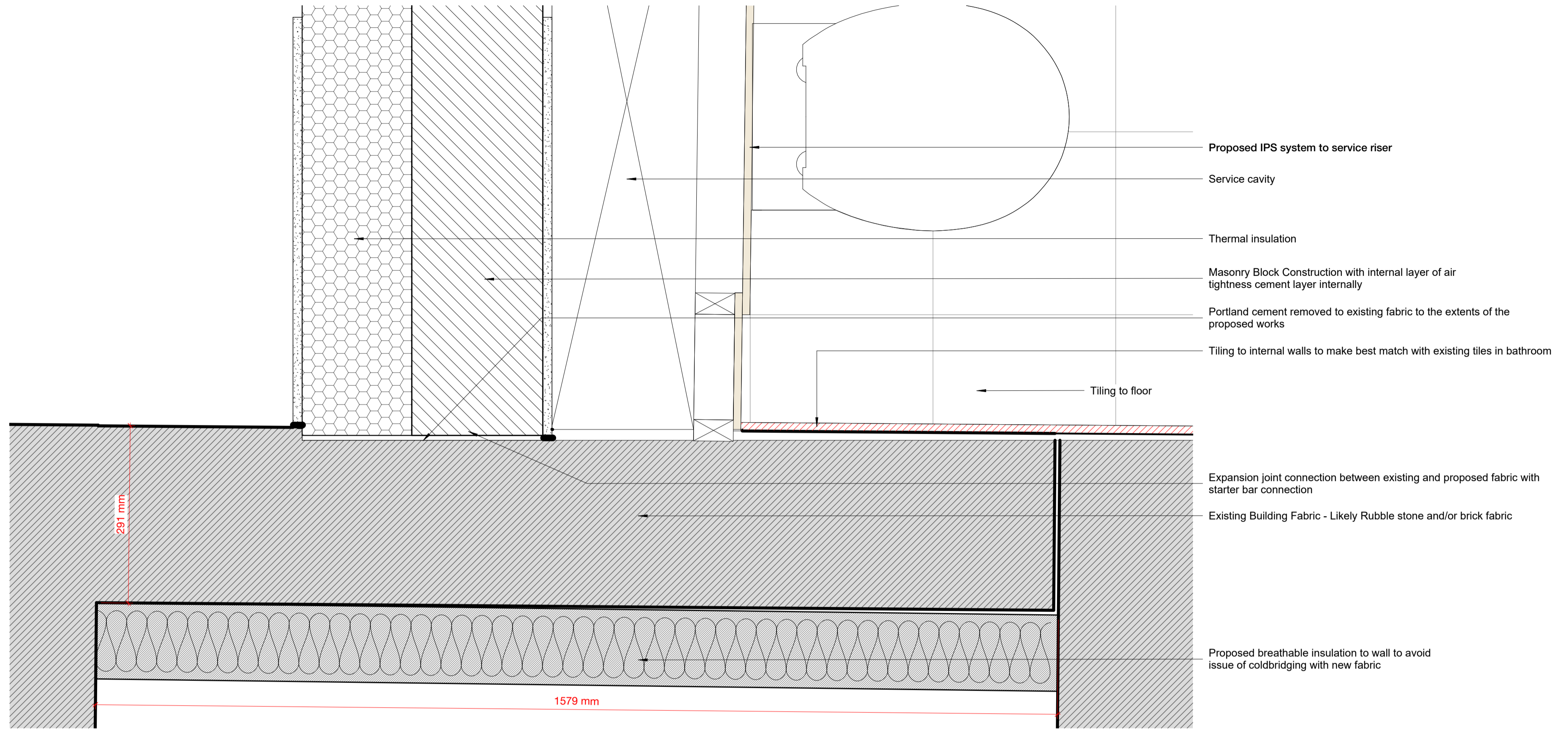

**2** Proposed Basement Bathroom Interface  
1 : 5

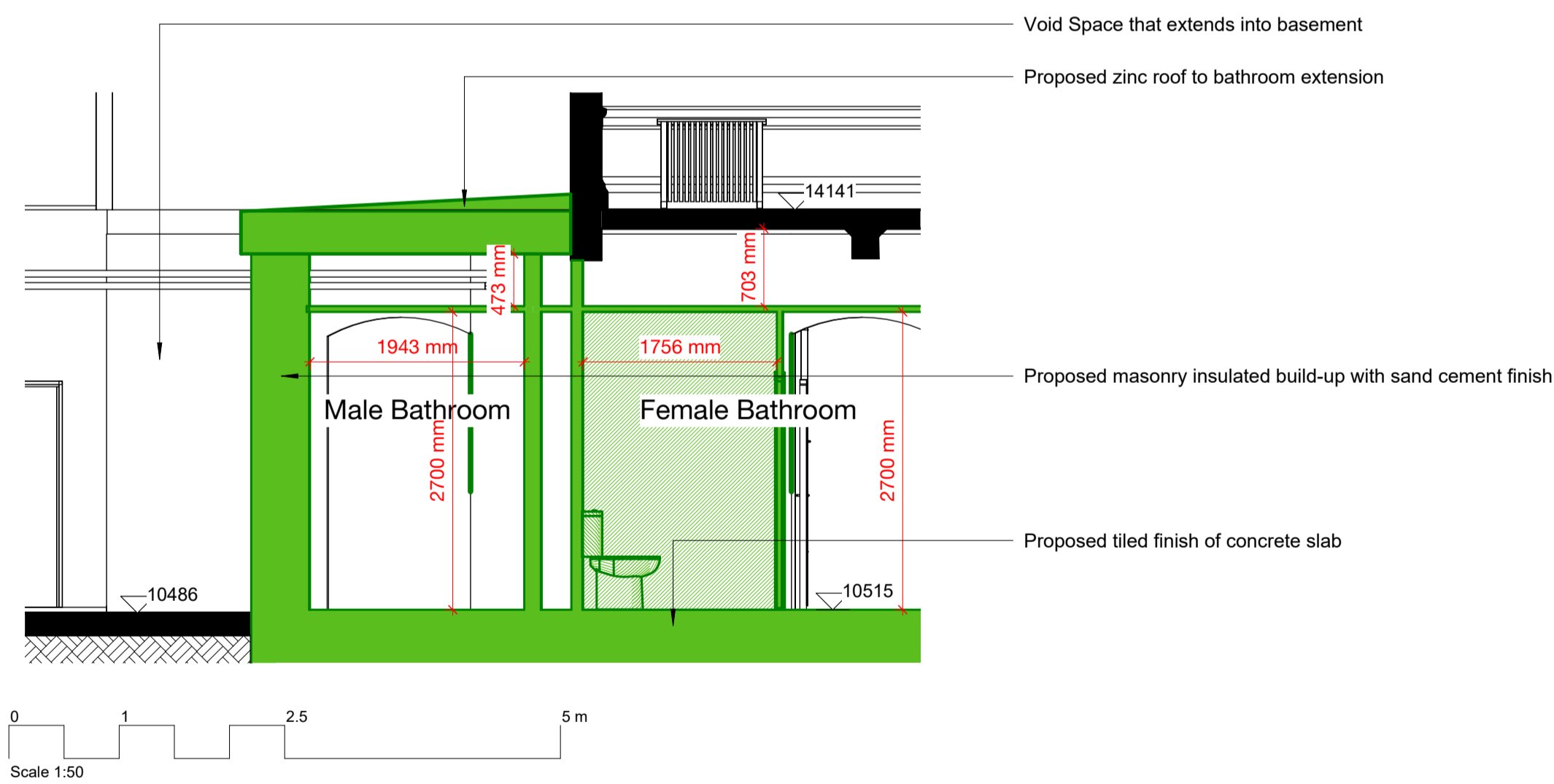

**1** Proposed Basement Bathroom Section  
1 : 50

## KEYPLAN

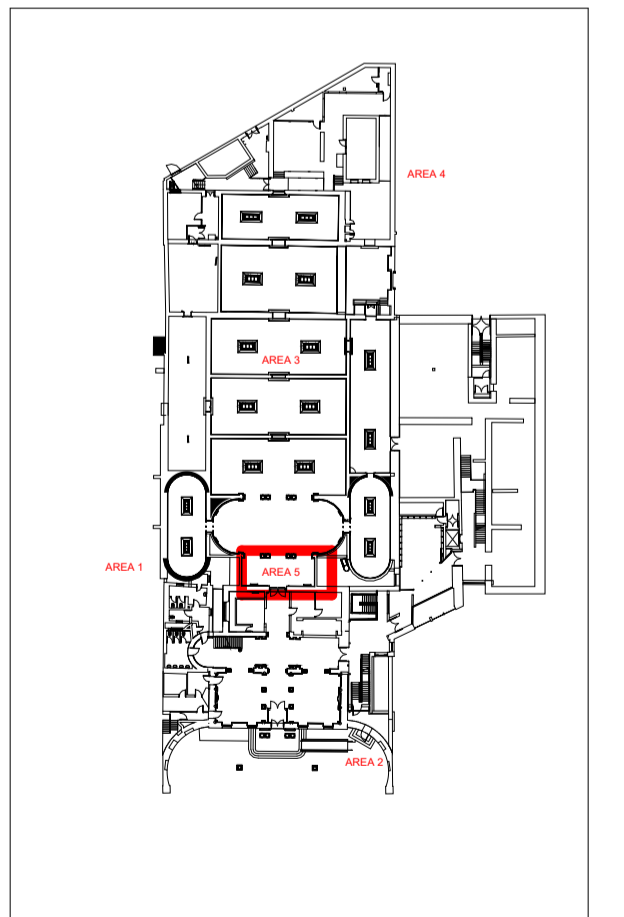

Rev	Description	Date
P01	Planning Part 8 - For Info	28/02/24
P02	Planning Part 8 - For Info	15/03/24
P03	Planning Part 8 - For Info	26/03/24

Copyright Hawkins\Brown Architects  
No implied licence exists. This drawing should not be used to calculate areas for the purposes of valuation. Do not scale this drawing. All dimensions to be checked on the site by the contractor and such dimensions to be their responsibility. All work must comply with relevant British Standards and Building Regulations requirements. Drawing errors and omissions to be reported to the architect. To be read in conjunction with Architect's specification and other consultant information.

KEY		All work to the approval of DCC Conservation Officer.	
<span style="color: red;">—</span>	Application Area	All work subject to detail design.	
<span style="color: green;">■</span>	Proposed	<b>AREA 1</b>	Area identifier
<span style="color: pink;">■</span>	Consented: 3196/19		
<span style="color: yellow;">■</span>	Changes to Consented		

<b>Scale @ A1</b> As indicated	<b>Date</b> 26/03/24	<b>Job Number</b> 220152	<b>Project</b> Hugh Lane Gallery, Parnell Square North, Dublin 1, D01 F2X9
<b>Drawn By</b> CMN	<b>Checked By</b> AC	<b>Status</b> S2	
<b>Drawing No.</b> PSL-HBA-HL-XX-DR-A-080825	<b>Rev</b> P03	<b>Purpose of Issue</b> Issued for Information	<b>Drawing</b> Hugh Lane Gallery - Proposed Basement Bathrooms 2 of 2

The Greenway, Block C,  
Ardilaun Court, 112-114  
St Stephen's Green,  
Dublin 2, D02 TD28  
mail@hawkinsbrown.com  
hawkinsbrown.com

# Hawkins\Brown