

AREA 1

Copyright Hawkins\Brown Architects
 No implied licence exists. This drawing should not be used to calculate areas for the purposes of valuation. Do not scale this drawing. All dimensions to be checked on the site by the contractor and such dimensions to be their responsibility. All work must comply with Irish, European and relevant British Standards. Drawing errors and omissions to be reported to the architect. To be read in conjunction with Architect's specification and other consultant information.

NOTES

KEYPLAN

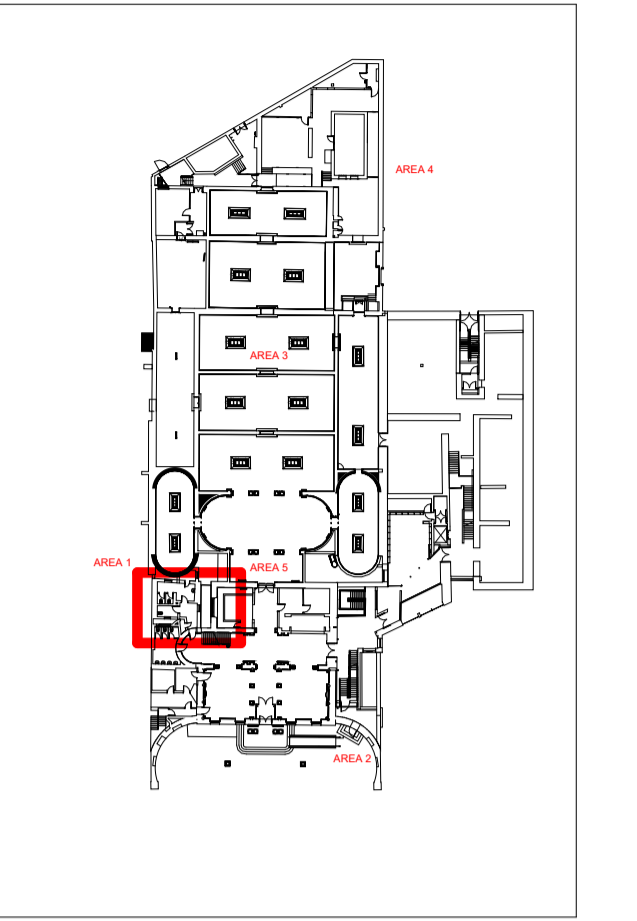

KEY

- Application Area
- Proposed
- Existing
- Consented
- Proposed Demolition

All work to the approval of DCC Conservation Officer.
 All work subject to detail design.

Rev	Description	Date
P04	Planning Part 8 - For Info	26/03/24
P03	Planning Part 8 - For Info	15/03/24
P02	Planning Part 8 - For Info	28/02/24
P01	For Information	24/01/24

The Greenway, Block C, Ardilaun Court, 112-114 St Stephen's Green, Dublin 2, D02 TD28
 mail@hawkinsbrown.com hawkinsbrown.com



Client
 Dublin City Council

Project
 Hugh Lane Gallery, Parnell Square North, Dublin 1, D01 F2X9

Drawing
 Hugh Lane Gallery - Proposed Library Link 2 of 3

Scale @ A1
 As indicated

Date
 01/09/24

Drawn By
 CMN

Checked By
 AC

Job Number
 220152

Status
 S2

Purpose of Issue
 Issued for Information

Drawing No.
 PSL-HBA-HL-XX-DR-A-080818

Rev
 P04

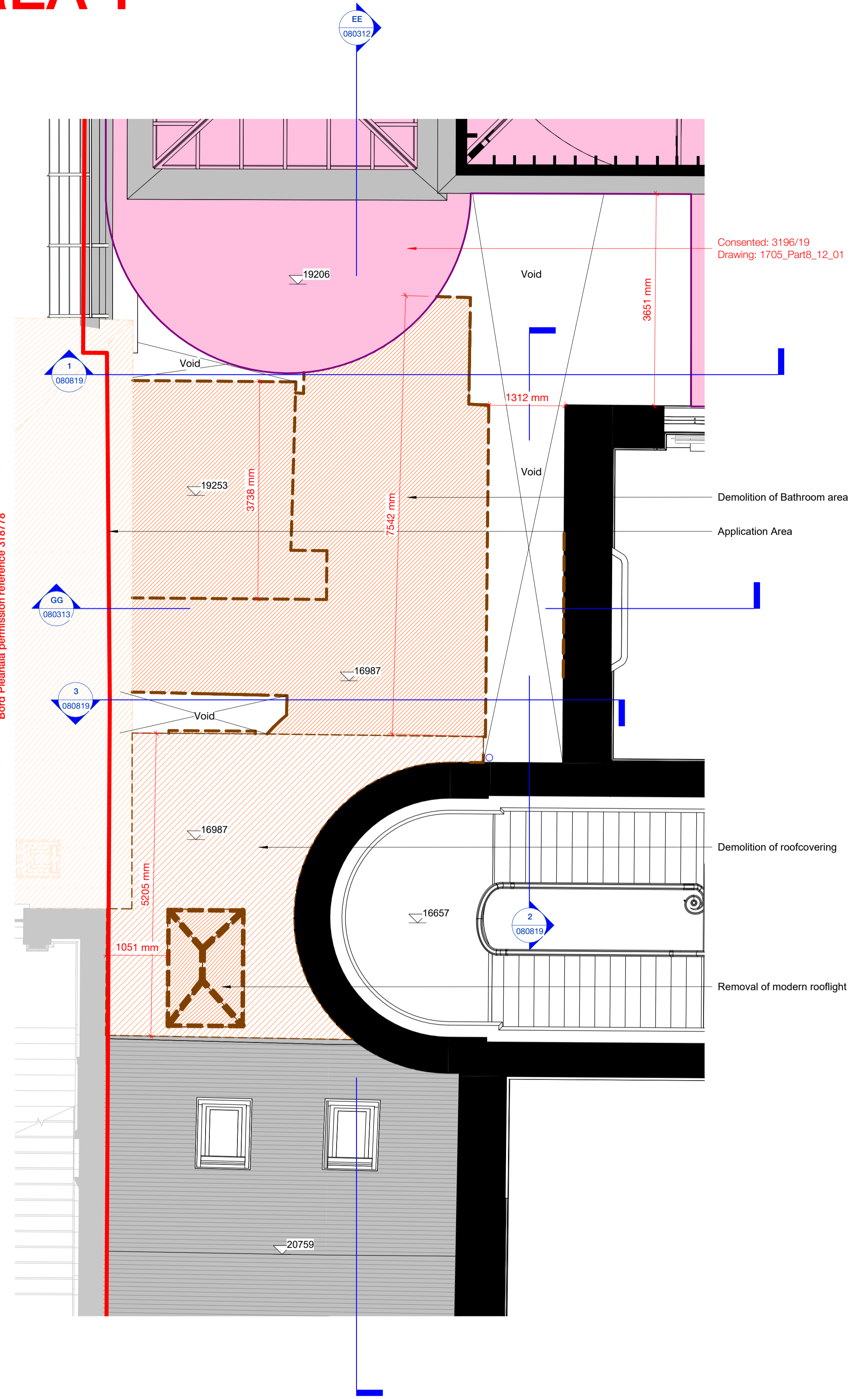

1 Existing - Library Link Plan - First Floor
 1 : 50

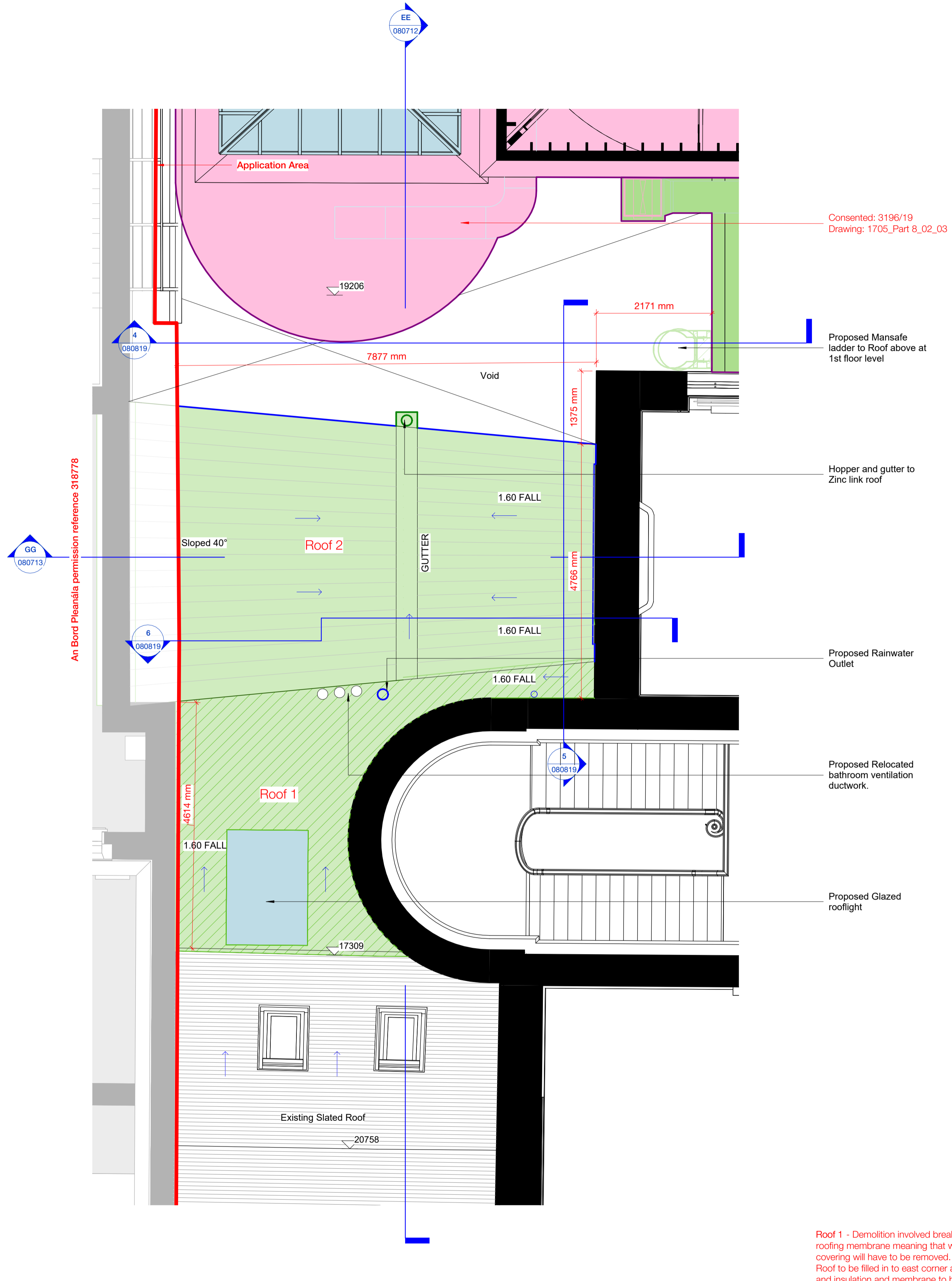

2 Proposed - Library Link Roof Plan - First Floor
 1 : 50

Roof 1 - Demolition involved breaking integrity of roofing membrane meaning that whole roof covering will have to be removed.
 Roof to be filled in to east corner above curve and insulation and membrane to be applied with rainwater outlet to north.
 Existing roof slate to south, to be confirmed if it discharges onto the flat roof, if so to be made good in design. Venting replaced for bathroom. Bathroom glazing to be removed and replaced with flat glazed rooflight.

Roof 2 - Library Link connection - Standing seam zinc roof and vertical faces flashed into the existing building. Sloped one side and 1.60 fall away from facade to gutter which slopes to north and discharges into hopper and rainwater pipe.