

Existing & Fabric Removal - Section C-C

1 : 100

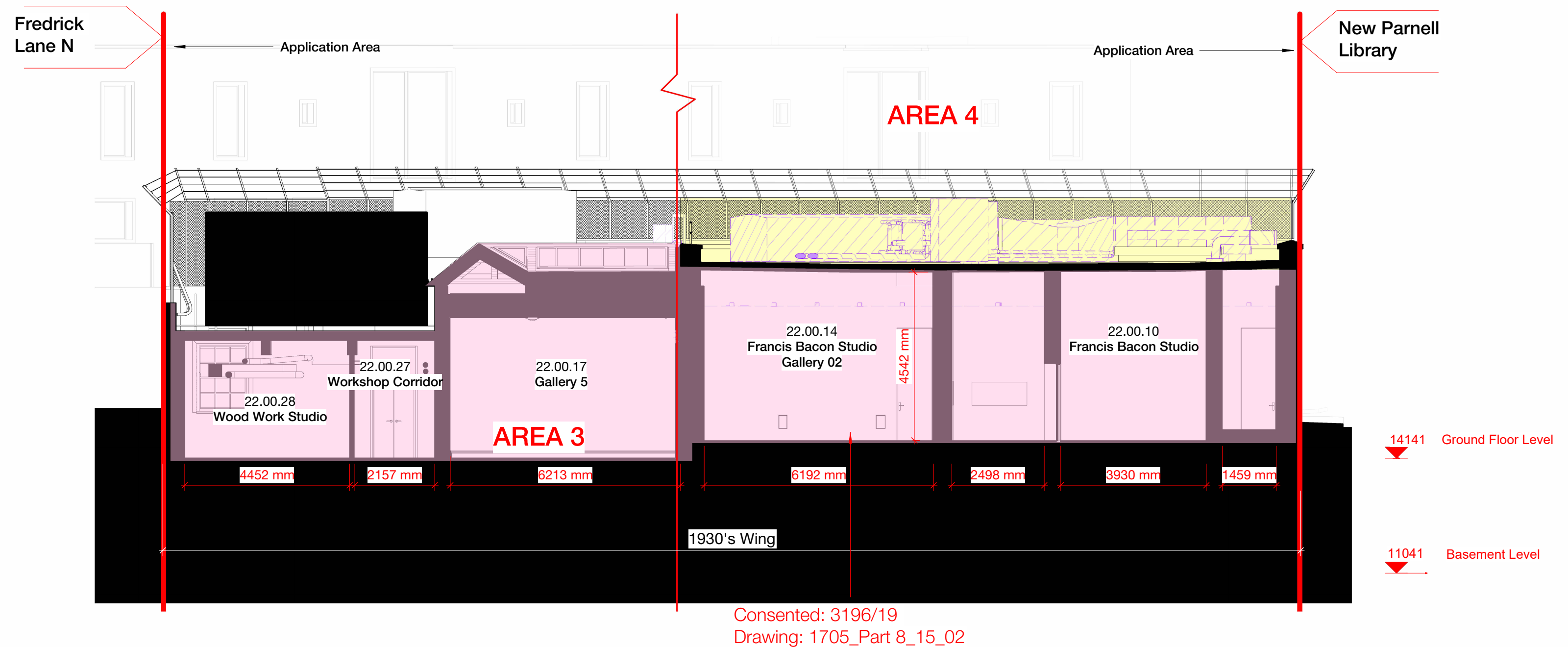

Existing & Fabric Removal - Section D-D

1 : 100

KEYPLAN

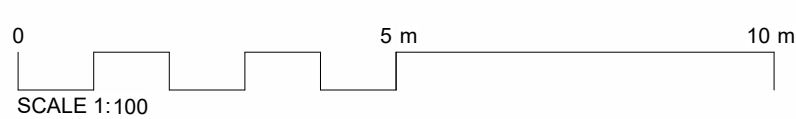
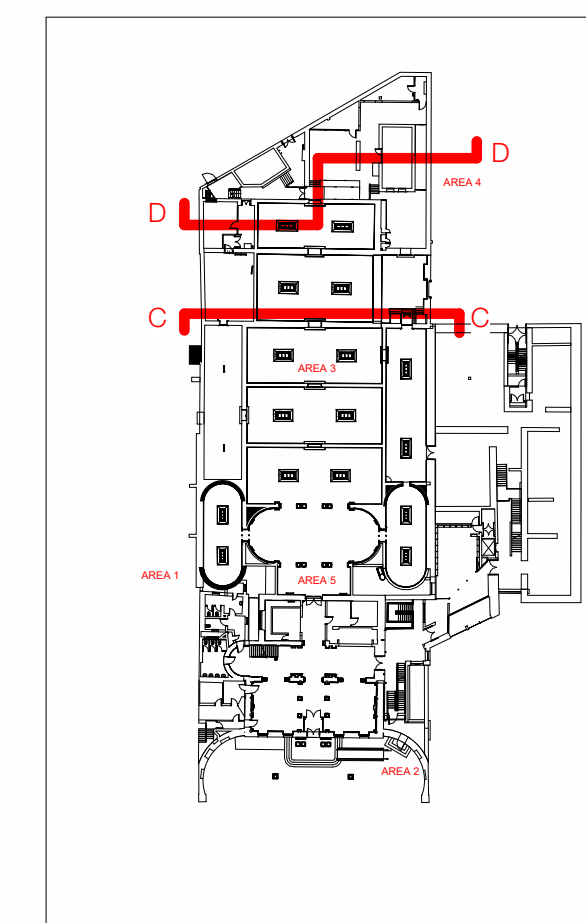

Rev	Description	Date
P01	Part 8 Planning Pack - Review and Comment	17/10/23
P02	Part 8 Planning - For Review and Comment	10/11/23
P03	Part 8 Planning - Information	17/11/23
P04	Planning Part 8 - For Info	28/02/24
P05	Planning Part 8 - For Info	15/03/24

Copyright Hawkins\Brown Architects
No implied licence exists. This drawing should not be used to calculate areas for the purposes of valuation. Do not scale this drawing. All dimensions to be checked on the site by the contractor and such dimensions to be their responsibility. All work must comply with relevant British Standards and Building Regulations requirements. Drawing errors and omissions to be reported to the architect. To be read in conjunction with Architect's specification and other consultant information.

KEY

- Application Area
- Proposed Demolition
- Existing (Not part of Application)
- Consented: 3196/19
- Changes to Consented

Scale @ A1

1 : 100

Drawn By

CMN

Drawing No.

PSL-HBA-HL-ZZ-DR-A-080311

Date

15/03/24

Checked By

AC

Job Number

220152

Status

S2

Purpose of Issue

Issued for Information

Project

Hugh Lane Gallery,
Parnell Square North,
Dublin 1,
D01 F2X9

Drawing

Existing - Hugh Lane Gallery - Section C-C & D-D

The Greenway, Block C,
Ardilaun Court, 112-114
St Stephen's Green,
Dublin 2, D02 TD28
mail@hawkinsbrown.com
hawkinsbrown.com

Hawkins\Brown