

REVISION SCHEDULE				
REV. NO.	REV. DESCRIPTION	REV. DATE	DRAWN	CHECKED
PL1	ISSUED FOR PLANNING	01/06/2023	BF	KOM
PL2	ISSUED FOR PLANNING	16/08/2023	BF	AL
PL3	ISSUED FOR PLANNING	01/08/2023	BF	AL
PL4	ISSUED FOR PLANNING	08/08/2023	BF	AL
PL5	ISSUED FOR PLANNING	16/02/2024	KJD	AL

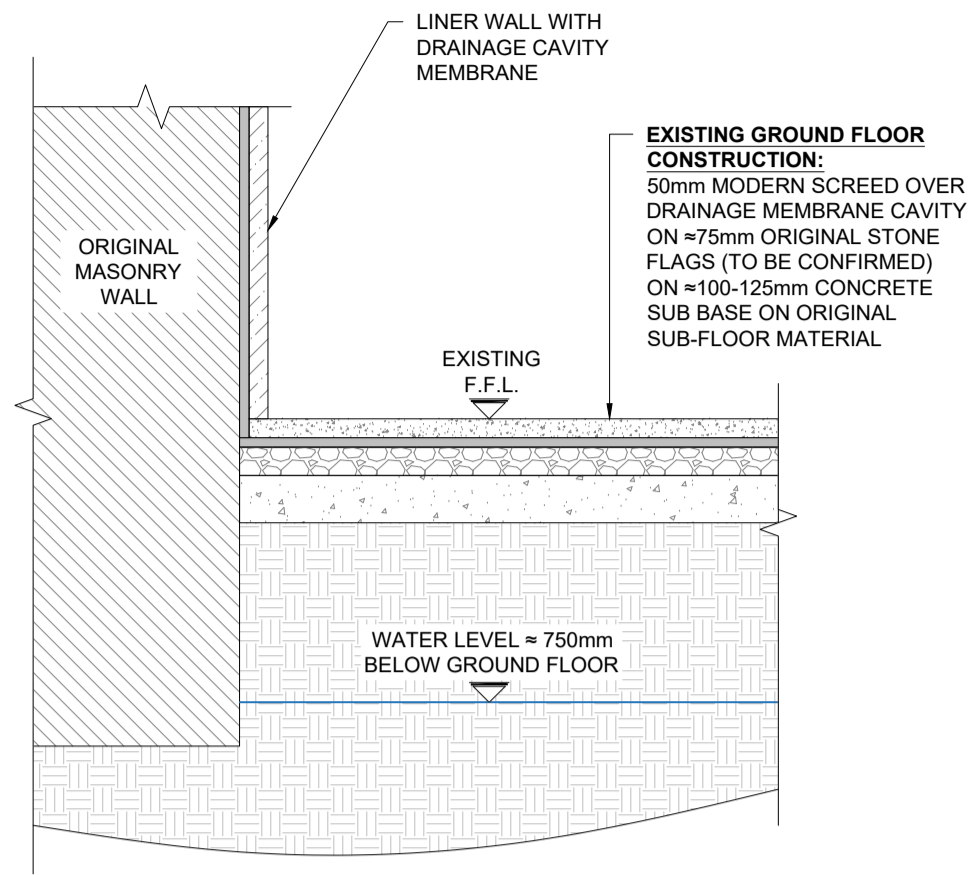

1-1
S.01
EXISTING BASEMENT SECTION 1-1
SCALE 1:20

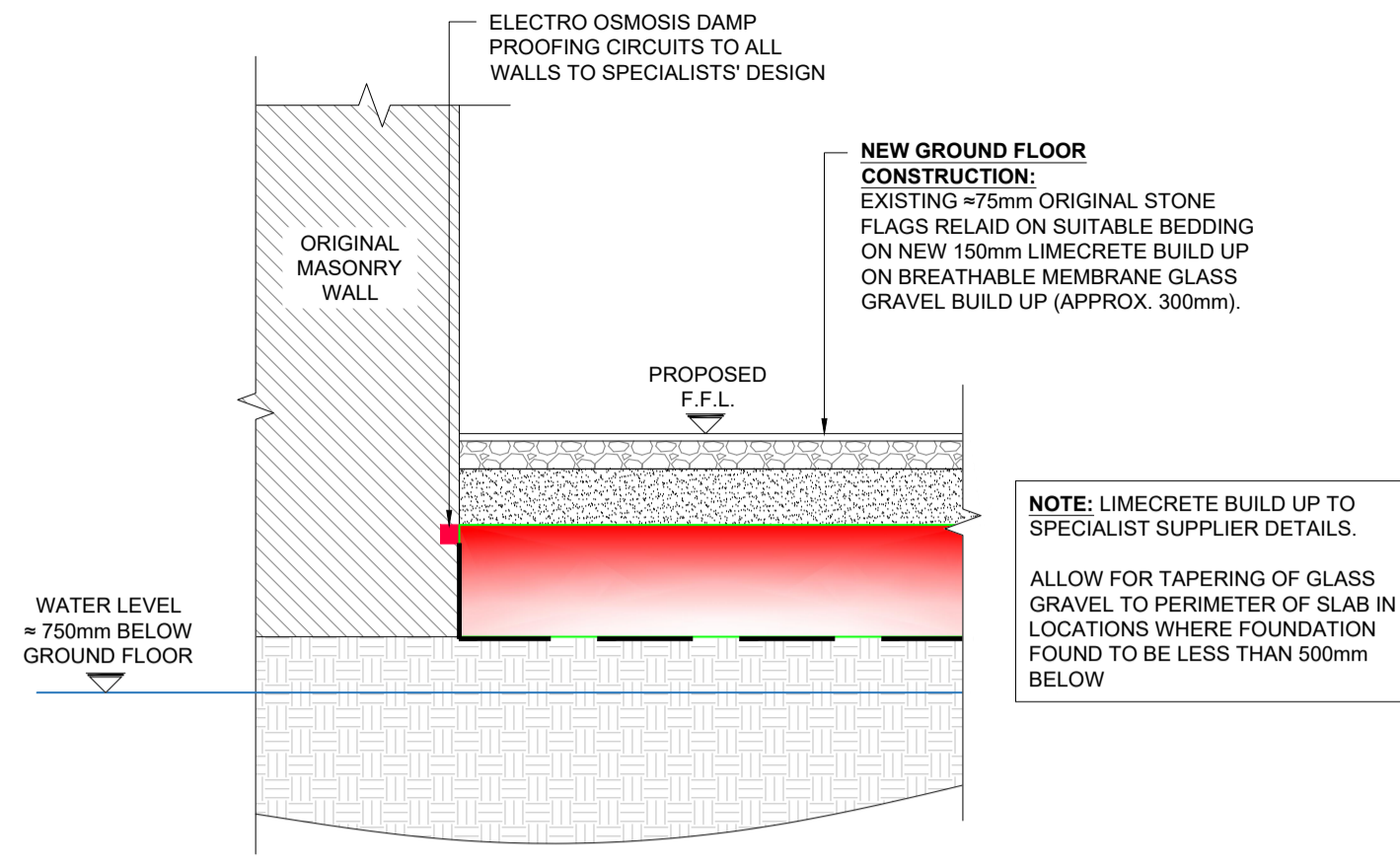

2-2
S.01
PROPOSED BASEMENT SECTION 2-2
SCALE 1:20

NOTE: LIMECRETE BUILD UP TO SPECIALIST SUPPLIER DETAILS.
ALLOW FOR TAPERING OF GLASS GRAVEL TO PERIMETER OF SLAB IN LOCATIONS WHERE FOUNDATION FOUND TO BE LESS THAN 500mm BELOW

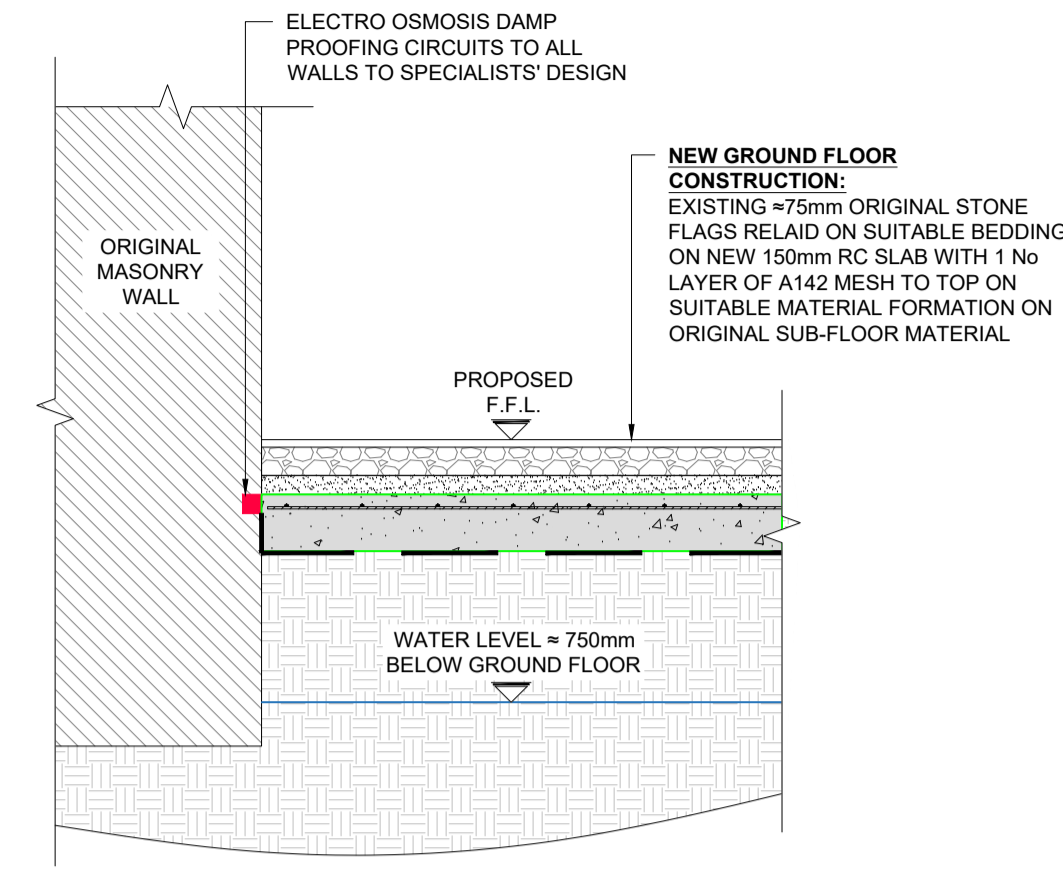

3-3
S.01
PROPOSED STAIRCASE BASEMENT SECTION 3-3
SCALE 1:20

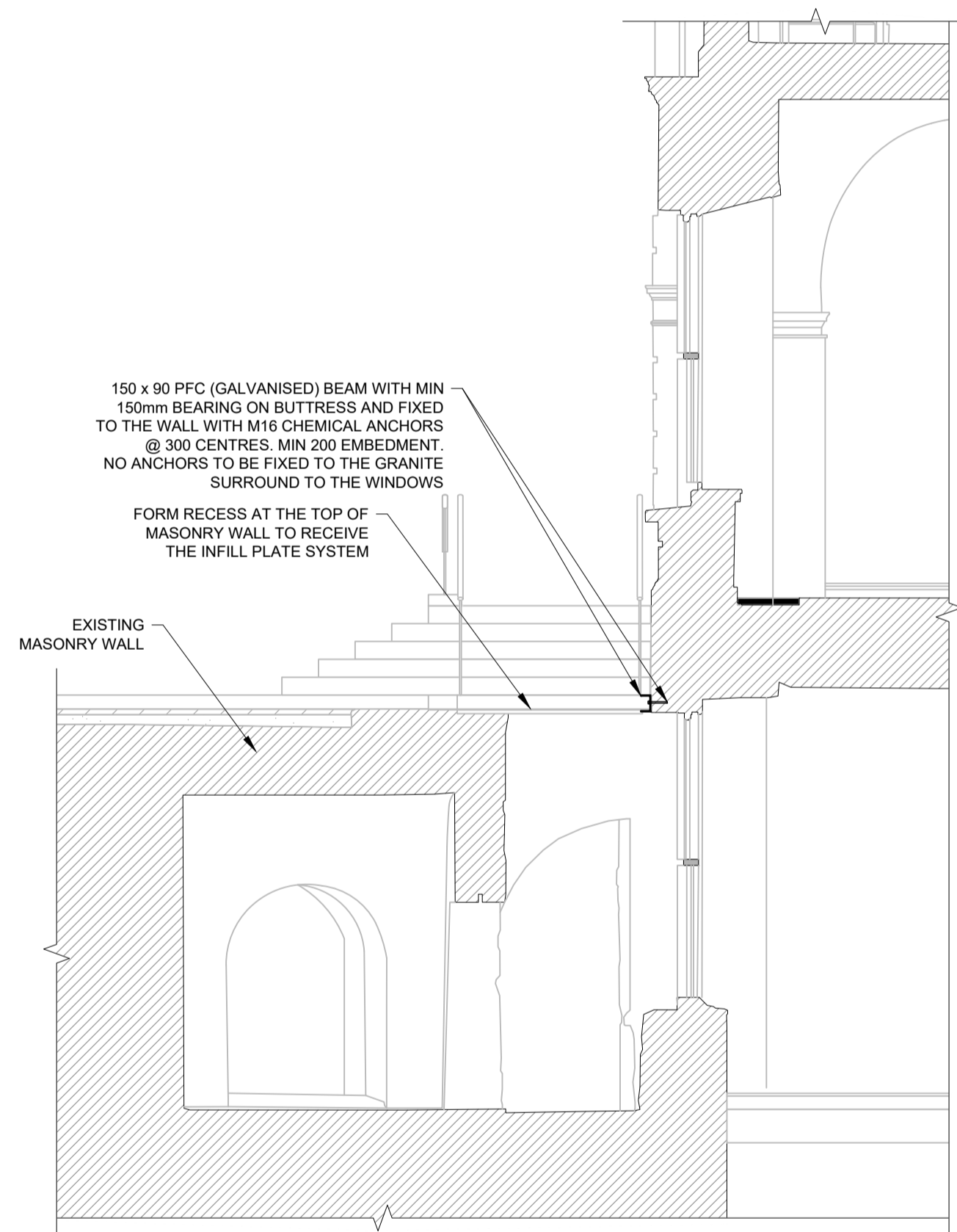

3-3
S.02
SECTION 3-3
SCALE 1:50

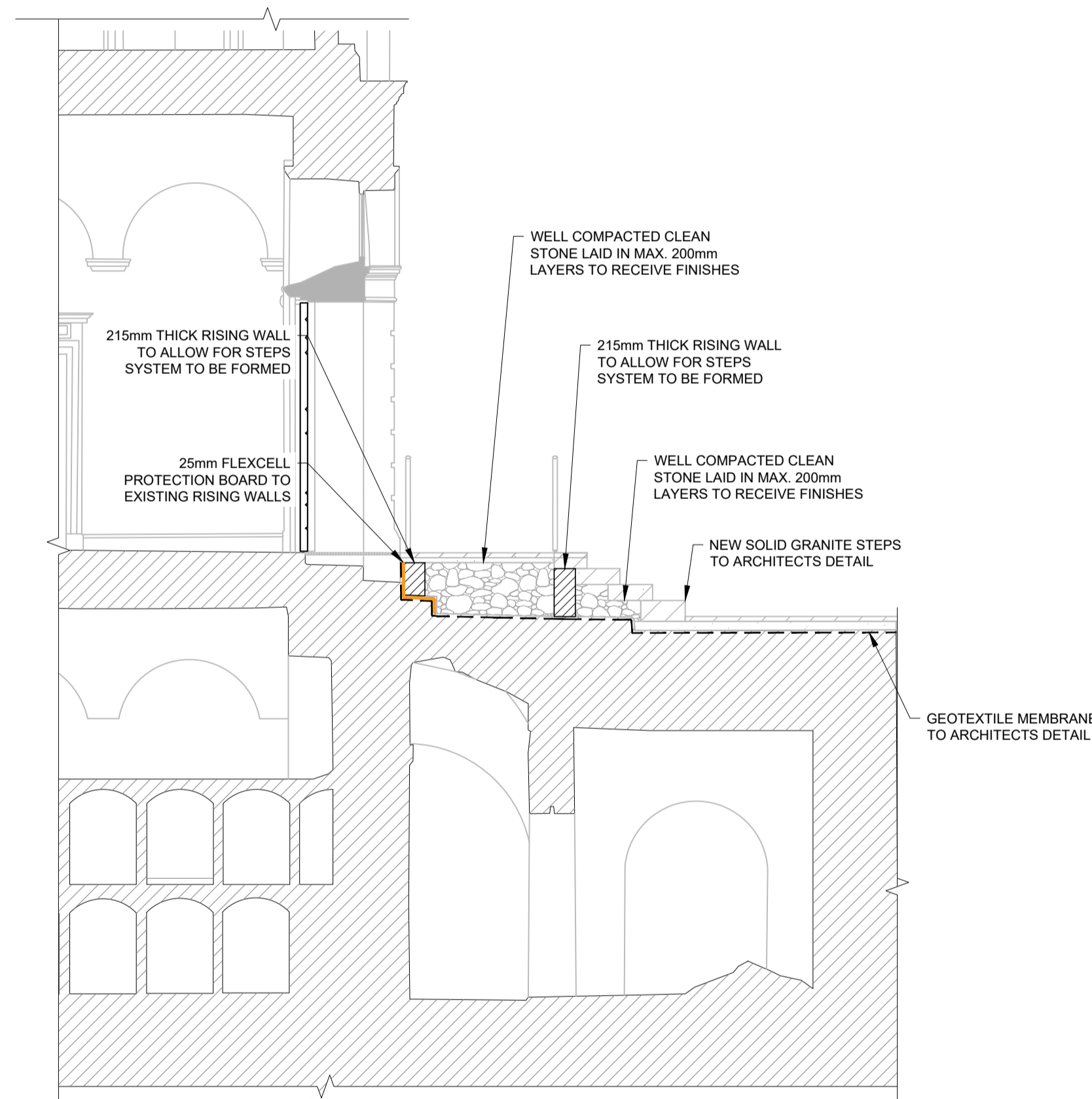

4-4
S.02
SECTION 4-4
SCALE 1:50

Drawing Stage: PLANNING	Project Details:	Notes	Drawn by:	Checked by:	Approved by:	Date:				
	Site Address:		NEWCOMEN BANK BUILDING	BF	AL	KO'M		01/06/2023		
	Client:		DUBLIN CITY COUNCIL	Project Name:	Scale:	Project Number:		2050		
	Architect:		HOWLEY HAYES COONEY	NEWCOMEN BANK BUILDING		A.S. @ A1				
	M&E Designer:		-	Project:	Originator:	Zone:		Level:	Type:	Discipline:
Contractor:	-	NBB	CORA	ZZ	ZZ	DR	S	0010	PL	PL5