

REVISION SCHEDULE					
REV. NO.	REV. DESCRIPTION	REV. DATE	DRAWN	CHECKED	
PL1	ISSUED FOR PLANNING	01/08/2023	BF	KOM	
PL2	ISSUED FOR PLANNING	16/08/2023	BF	AL	
PL3	ISSUED FOR PLANNING	16/02/2024	KJD	AL	

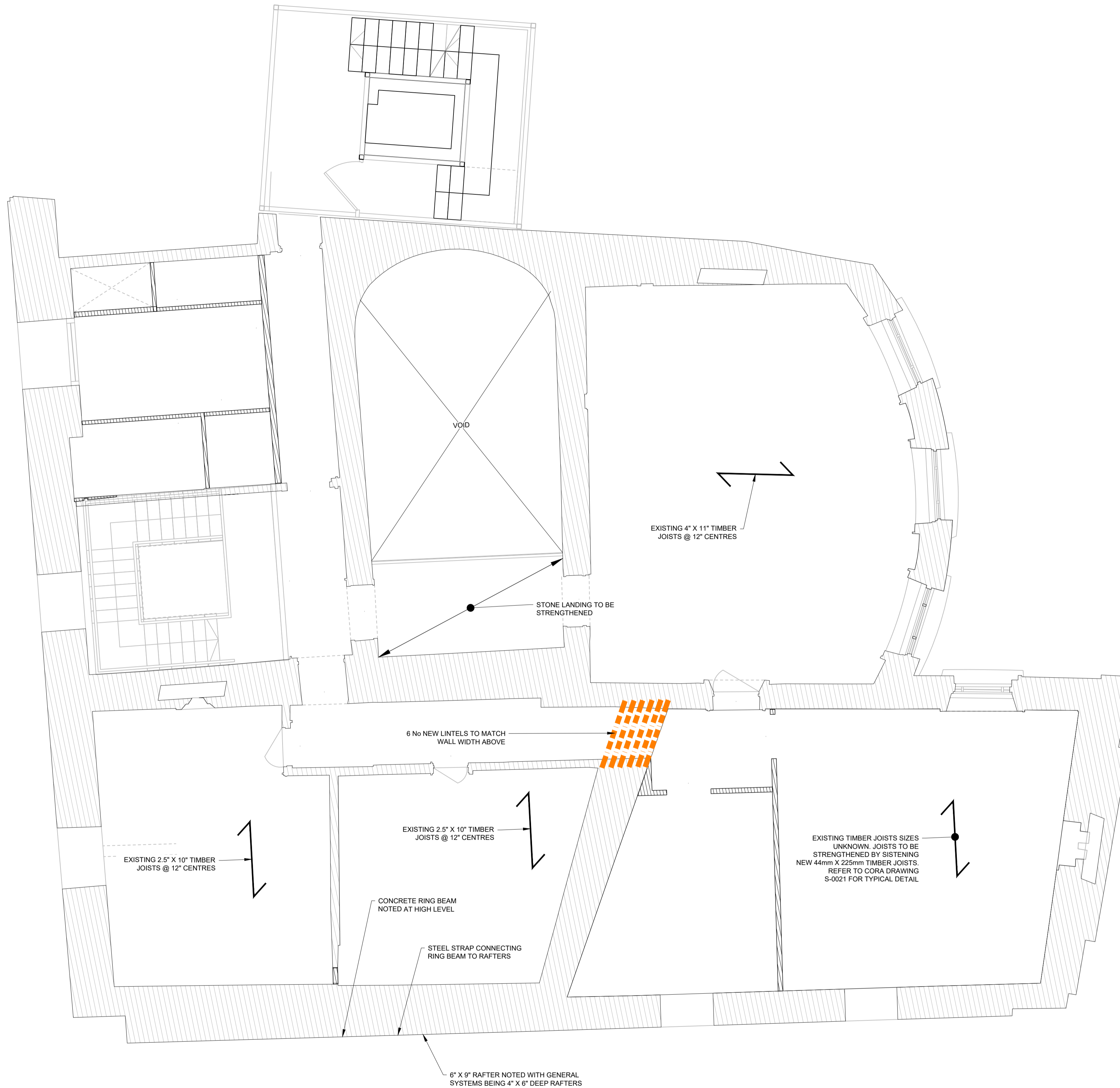

LEGEND:

	EXISTING WALLS/ FOUNDATIONS TO REMAIN
	100mm x 150mm DEEP KILLESHAL PRECAST REINFORCED CONCRETE LINTEL
	STRUCTURAL WALLS UNDER

NOTE:
ALL LINTELS NOT HIGHLIGHTED TO BE RETAINED. ALLOW FOR CORA INSPECTION

NOTE:
CONTRACTOR TO PROVIDE TEMPORARY WORKS DESIGN TO ALLOW FORMING OPENING IN WALL. DESIGN TO BE SUBMITTED AND APPROVED PRIOR TO COMMENCEMENT OF WORKS

FLOOR LEGEND:

	EXISTING TIMBER FLOOR JOISTS
	EXISTING TIMBER FLOOR JOIST SYSTEM TO BE STRENGTHENED

THIRD FLOOR PLAN
SCALE 1:50

Drawing Stage:
PLANNING

Project Details:

Site Address:	NEWCOMEN BANK BUILDING
Client:	DUBLIN CITY COUNCIL
Architect:	HOWLEY HAYES COONEY
M&E Designer:	-
Contractor:	-

Notes

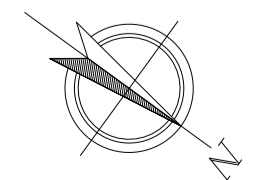

Drawn by: BF	Checked by: AL	Approved by: KOM	Date: 01/06/2023
Project Name: NEWCOMEN BANK BUILDING		Scale: 1:50 @ A1	Project Number: 2050
Drawing Title: THIRD FLOOR LEVEL GENERAL ARRANGEMENT		Project: NBB	Originator: CORA

Behan House,
10 Lower Mount Street,
Dublin 2. D02 HT71
Tel: +353 1 661 1100
e-mail: info@cora.ie
Web: www.cora.ie

CORA
CONSULTING ENGINEERS

Level:	Type:	Discipline:	Drawing No:	Stage:	Revision:
03	DR	S	005	PL	PL3