

1 KEY PLAN
Scale: 1:500

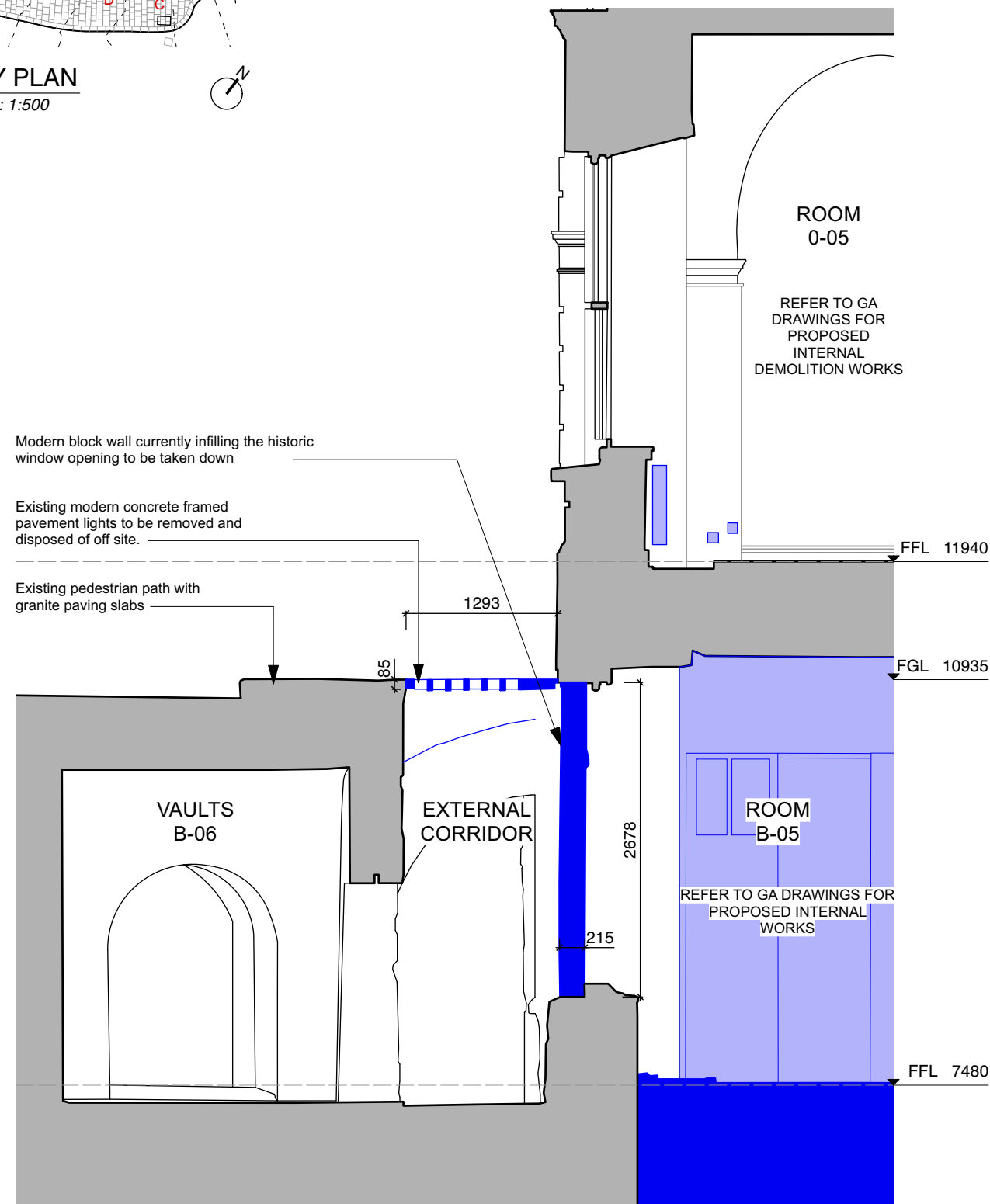

2 Castle Street Entrance - Existing Section CC
Scale: 1:50

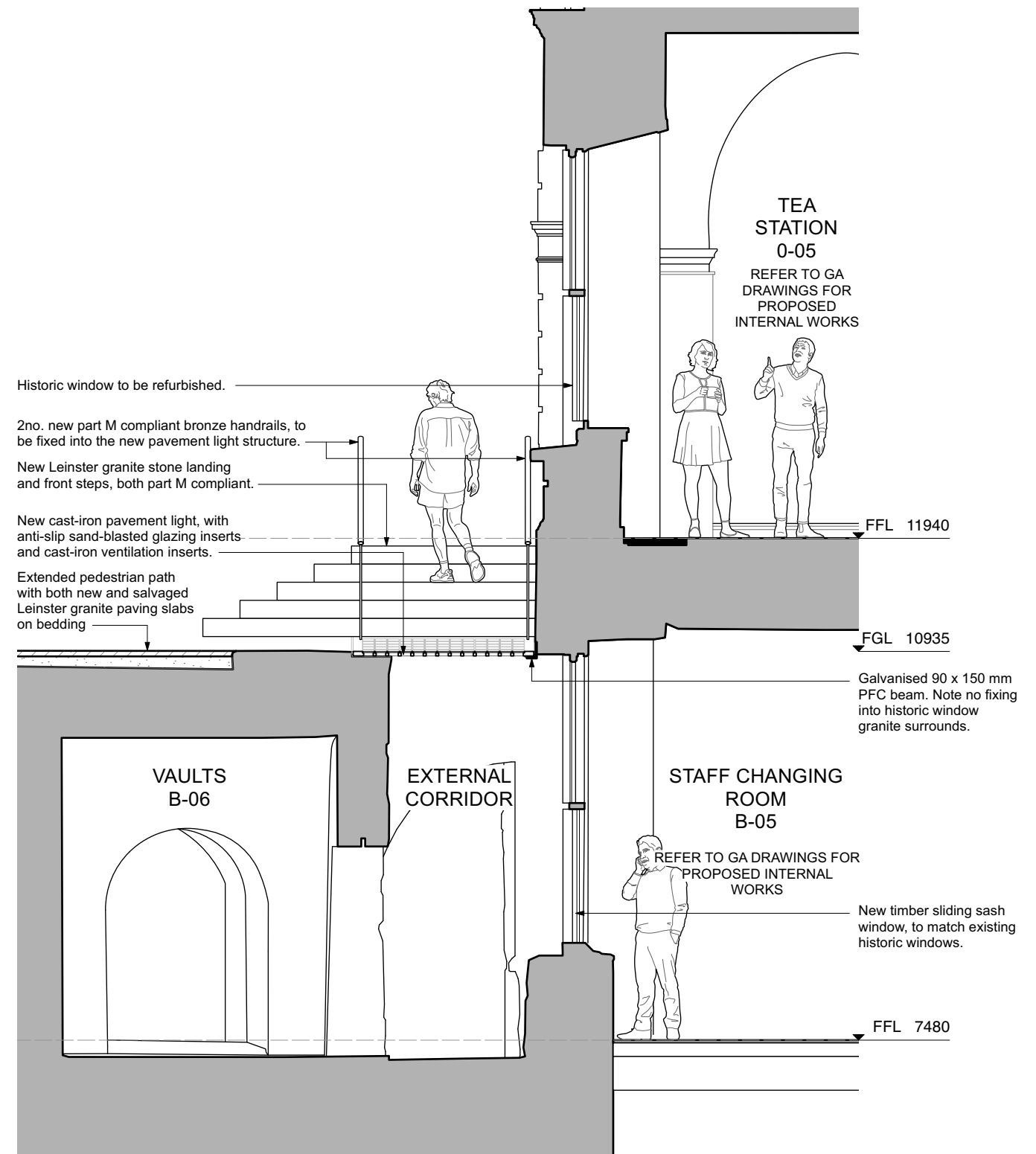

3 Castle Street Entrance - Proposed Section CC
Scale: 1:50

Use figured dimensions only. Do not scale drawings. Check all dimensions on site. Read in conjunction with specification and consultants drawings. Report any discrepancies to the Architects before putting work in hand. Copyright of this drawing is vested in the Architects and may not be reproduced, in whole or part, without prior consent.

GENERAL NOTES

- All drawings to be read in conjunction with method statement, photographic survey and schedules submitted along with the drawings.
- All works on site will be completed on site in accordance to the method statement submitted along with the planning application.

KEY

- Proposed demolition works

Rev.	Date	Description	Drn.	Chk.
-	21/06/23	Issue for planning review	ALO	LOC

Project
Newcomen Bank Building
16 Castle Street, Dublin 2

Client
Dublin City Council

Drawing
Proposed UA Entrance - Sheet 3

Project Stage
Planning

Date
21.06.2023

Scale
1:50@A3

Project No.
0569

Drawing No.
L-312

Revision
-

Howley Hayes Cooney
ARCHITECTURE
19 Rock Hill, Blackrock, Dublin, A94 D235
01 278 4644
hharchitecture.ie