

1 Third Floor Plan - Existing Stair 3
Scale: 1:50

- Modern partition to be removed and historic architrave fully revealed and refurbished.
- Historic door to be carefully taken out and set aside for potential re-use.
- Existing landing to be retained.
- Portion of historic guardrail to be carefully dismantled and set aside for repositioning.
- Historic partition to be taken down to allow for sufficient space for insertion of a Part B/K compliant stair.
- Portion of historic stairs and handrails to be retained in place for display. Structural support to be determined following further site investigations.
- Portion of historic stairs to be carefully dismantled and set aside for potential reuse/display within the building, to allow for sufficient space for insertion of a Part B/K compliant stair.

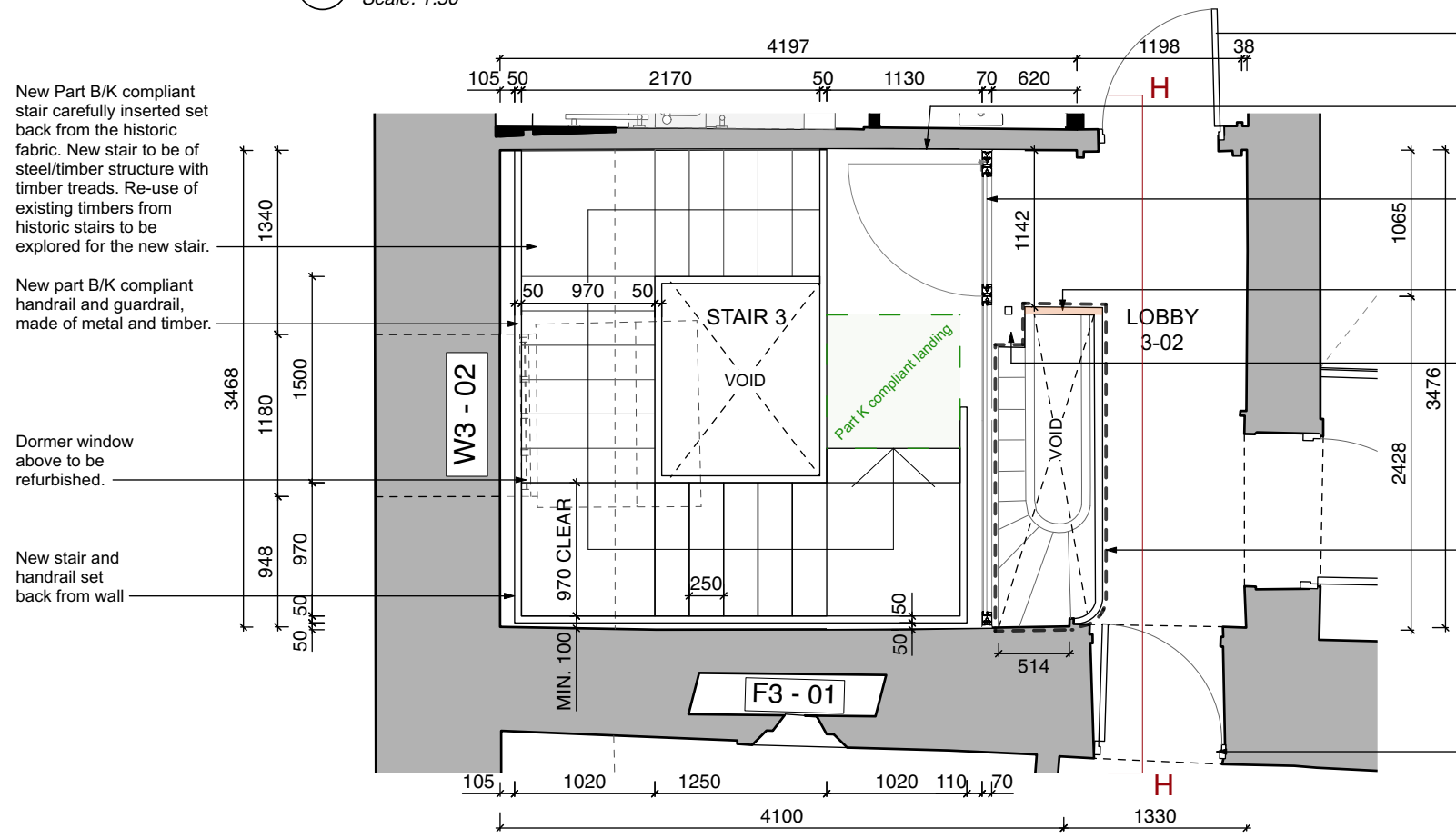

2 Third Floor Plan - Proposed Stair 3
Scale: 1:50

- New Part B/K compliant stair carefully inserted set back from the historic fabric. New stair to be of steel/timber structure with timber treads. Re-use of existing timbers from historic stairs to be explored for the new stair.
- New part B/K compliant handrail and guardrail, made of metal and timber.
- Dormer window above to be refurbished.
- New stair and handrail set back from wall.

- New fire door to match the existing historic doors
- Historic third floor partition sits proud of the second floor partition. Difference in vertical alignment to be managed at cornice level.
- New glazed fire door within fire rated glazed screen. Required for fire separation. Screen to be set back from the historic joinery.
- Repositioned portion of historic handrail, set back to provide adequate clearance for door to stairs.
- Portion of new landing to be carefully constructed around and over the remaining retained portion of historic steps.
- Retained portion of historic stairs and handrail.
- New fire door to match the existing historic doors

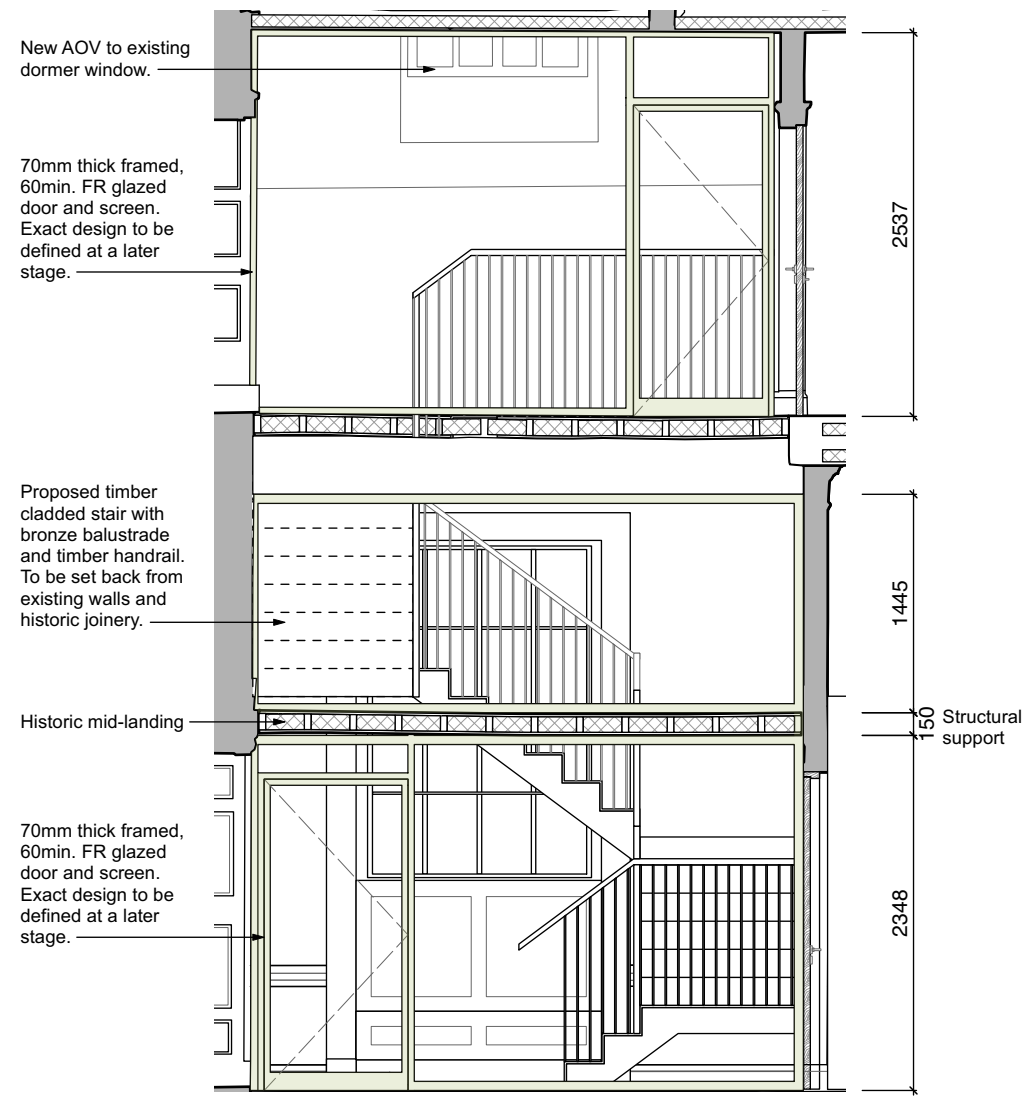

3 Section HH - Proposed FR Screen Elevation
Scale: 1:50

Note - Retained elements of historic stairs omitted from this drawing for legibility purposes. To be read in conjunction with drawing no. L-303.

Use figured dimensions only. Do not scale drawings. Check all dimensions on site. Read in conjunction with specification and consultants drawings. Report any discrepancies to the Architects before putting work in hand. Copyright of this drawing is vested in the Architects and may not be reproduced, in whole or part, without prior consent.

GENERAL NOTES
- All drawings to be read in conjunction with method statement, photographic survey and schedules submitted along with the drawings.
- All works on site will be completed on site in accordance to the method statement submitted along with the planning application.

KEY
 Proposed demolition works
 Proposed 60 minutes fire rated screen and doors.



Rev.	Date	Description	Drn.	Chk.
-	16/02/24	Issue for planning	ALO	LOC

Project
Newcomen Bank Building
16 Castle Street, Dublin 2

Client
Dublin City Council

Drawing
Stair 3 - Existing & Proposed 3rd Floor Plan

Project Stage	Date	Scale	Project No.	Drawing No.	Revision
Planning	16.02.2024	1:50@A3	0569	L-301	-

Howley Hayes Cooney
19 Rock Hill, Blackrock, Dublin, A94 D235
01 278 4644
hharchitecture.ie