

Crampton Court

Walking down Essex Street East it's easy to miss the entrance to this hidden gem of a laneway, but it's a handy little shortcut between Temple Bar and Dame Street. Look down the dark laneway beside the Dublin Theatre Festival Office and you will see original artwork by Dublin street artist Maser 'I'd Rather Trust a Dealer on a Badly Lit Street Corner, than a Criminal in a Three Piece Suit'. Taking his advice, walk under the overhead wooden rafters, which hint at the history of the lane, and be surprised when this narrow lane opens out onto a small square, framed by the Olympia Theatre. Continue along the laneway by the side of the Olympia Theatre and pass under the sign for Brogan's Bar, before Crampton Court opens out onto Dame Street. This laneway, although fairly well used, attracts some anti-social behaviour particularly in the lane on the Temple Bar side.

Challenge: How can we realise the potential to create great public space in this hidden gem of a laneway and small urban square?



Specifications

Crampton Court entrances are narrow openings (2.9m at Dame Street and 1.5 at Essex Street) at ground floor only, leading to a small square about 11.5 by 16.7 metres wide, surrounded by the theatre, apartments, a gym and the rear of the Project Arts Centre and the Family Courts. There are double yellow lines bounding the square, nevertheless illegal parking is an issue. There is vehicular service access from Dame Street into the square to the Olympia Theatres storage warehouse, also a number of fire exits and entrance to the gods open onto the square. There is pathway on the north and south sides of the square and a small path either side of lane from Dame Street into the square. Pedestrian access only from the square to Essex Street. There is lighting in both of the lanes in Crampton Court.

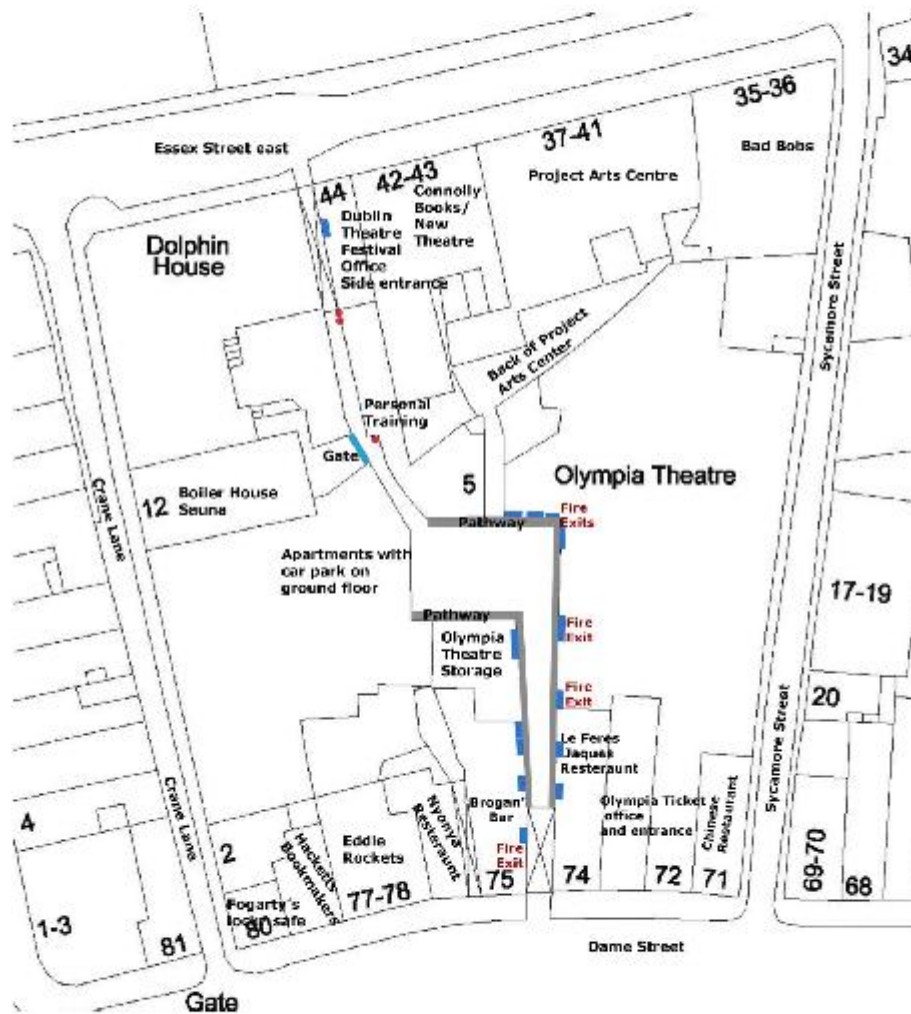

Crampton Court

Laneway to Essex Street



View B

View A



Dame St. Entrance - 2.913m wide
 Square size 11.556m x 15.753m
 Land at Essex St end size 1.498m x 1.994m

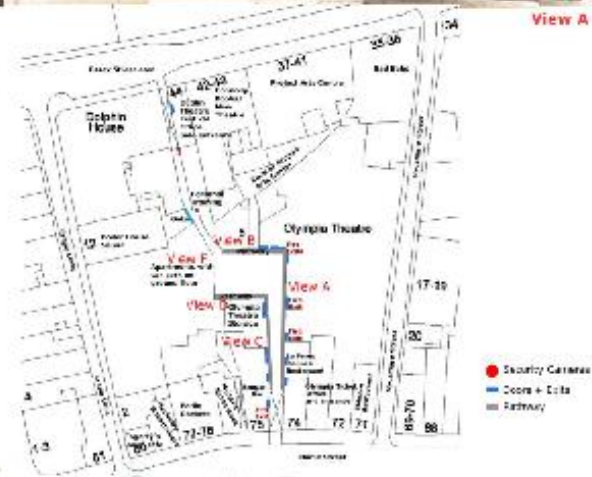

View C

View D

View F

Laneway to Essex Street